

D/G CODE	RATING	1	2	3	4	5	6	7	8	9	10	11	WEIGHT(DRY)
		AIR CLEANER	ENGINE	ALTERNATOR	TERMINAL BOX	GENERATOR PANEL	VIBRATION ISOLATOR (RUBBER TYPE)	J/W HEATER	OIL REGULATOR	LO PRIMING PUMP	CRANKCASE SENSOR	ANCHOR BOLT	
5C-7PE	CONTINUOUS	STANDARD	S16R-PTA-S	MG-7PE	STANDARD	STANDARD	STANDARD	OPTION (7.5KG/ASSY.)	OPTION (40KG/ASSY.)	STANDARD	STANDARD	OPTION	12420 KG

12	BREATHER	Ø76.3
13	LUBE OIL DRAIN	Rc 1
14	FUEL INLET	Rc 3/4
15	FUEL RETURN	Rc 3/4
16	LOAD TERMINAL	
17	EXHAUST OUTLET	350A
18	LUB OIL INLET (OIL REGULATOR)	Rc 1/2
19	WATER INLET PIPE	90A (WITH RUBBER HOSE)
20	WATER OUTLET PIPE	65A (WITH RUBBER HOSE)

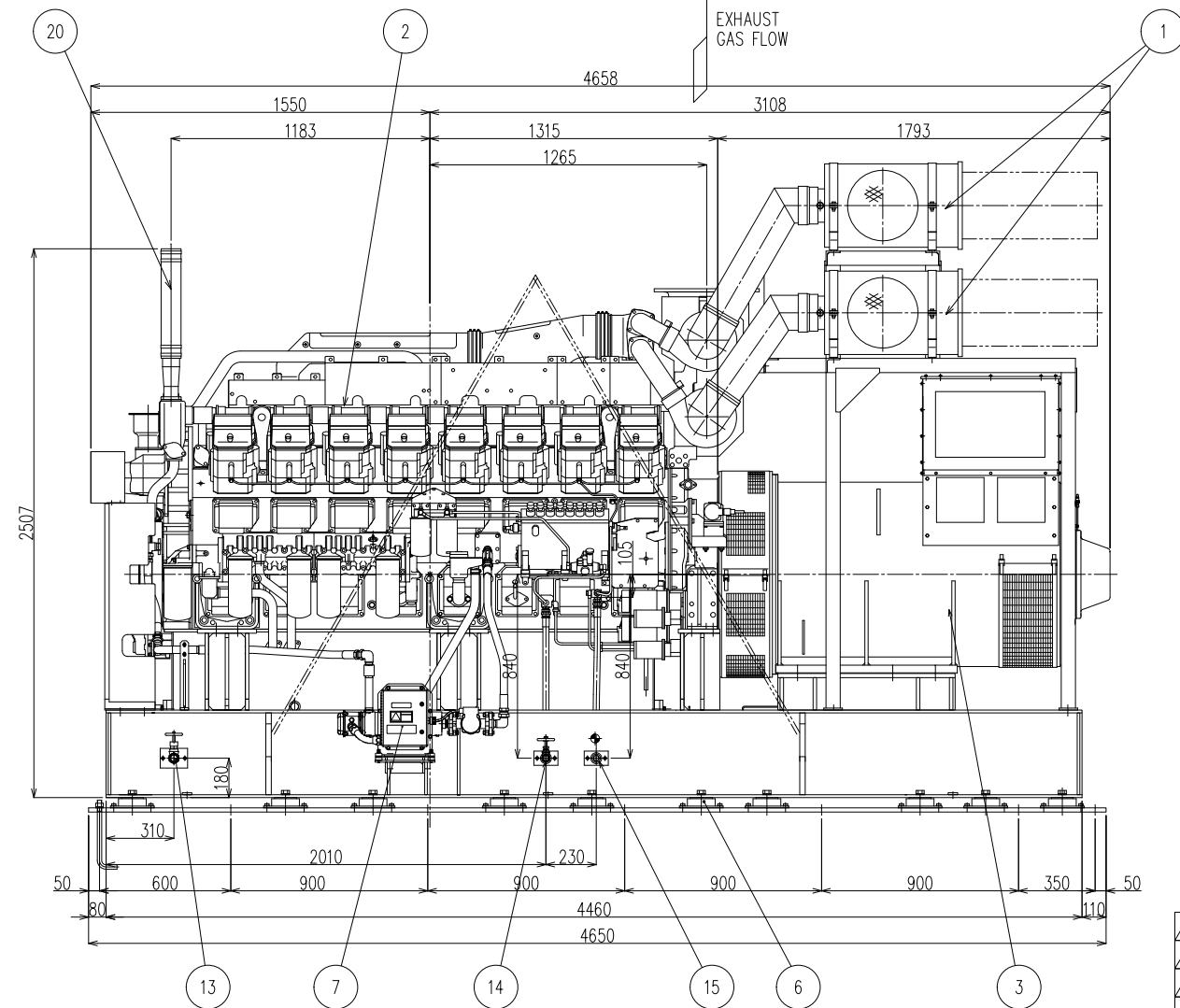
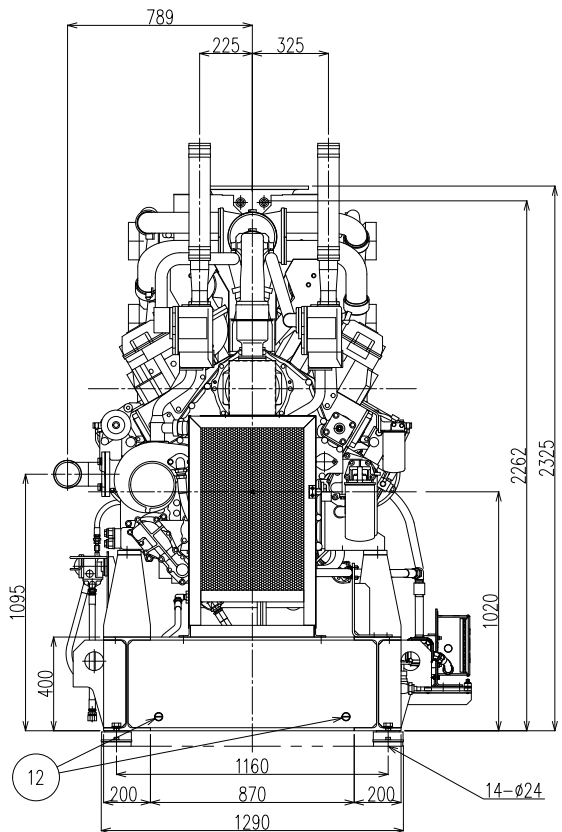
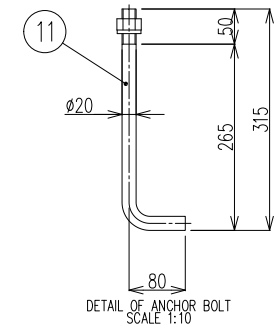
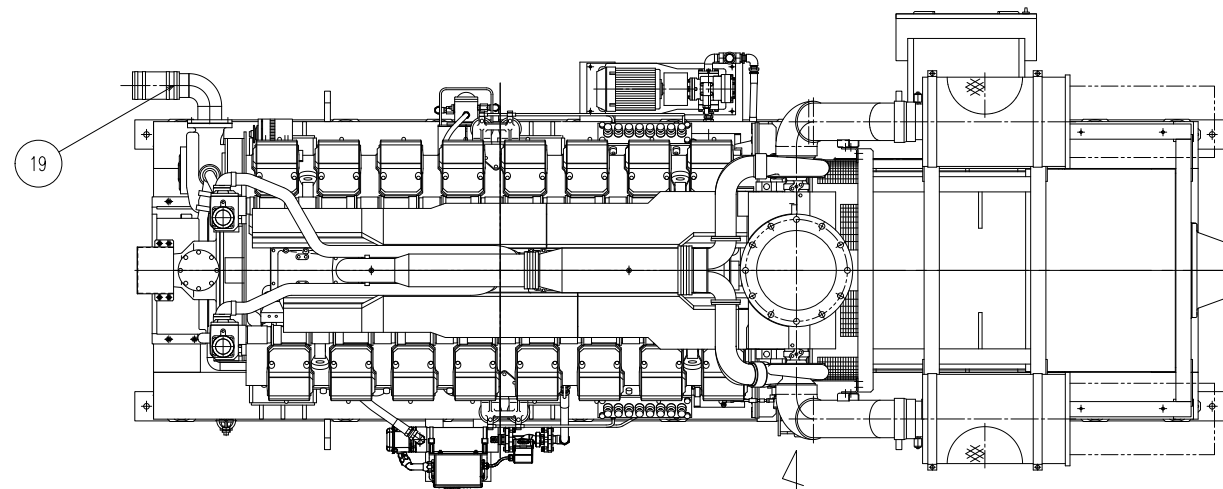

2) PLEASE REFER TO SCOPE OF SUPPLY FOR OPTION ITEMS DELIVERED.
 NOTE : 1) THE WEIGHT (DRY) ACCORDING TO STANDARD MGS SCOPE SUPPLY, EXCLUDING FOR ANY OPTION PARTS.

				3rd ANGLE PROJECTION	MITSUBISHI DIESEL GENERATOR MGS1500C (M16R-G)	
ECO17-10003				19.10.2017	FASUNI	SCALE 1:30
CHG	ECO-NO.	DATE	CHK	DRAWING NO.		
APPD	K.YAP/OSAKA	CHK	NG/TIONG	DRN	MRY	STG01-21301
				DATE : 19.10.2017		

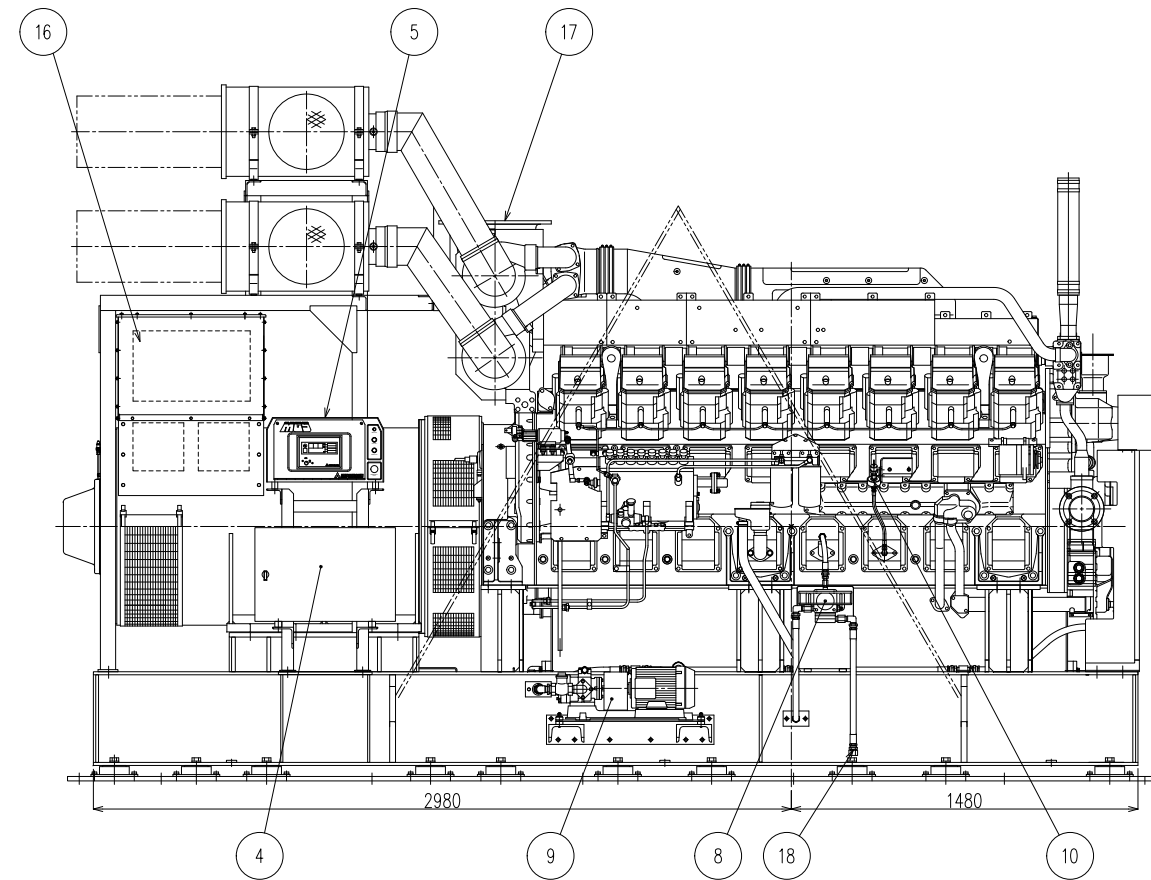
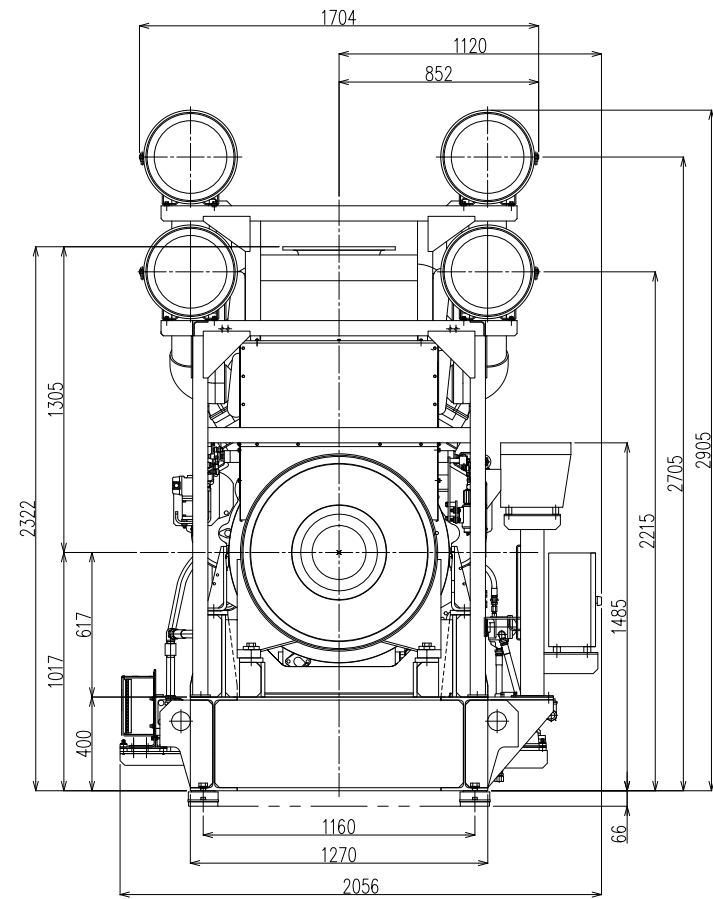

△					3rd ANGLE PROJECTION	MITSUBISHI DIESEL GENERATOR MGS1500C (M16R-G)
△						
△	ECO17-10003	19.10.2017	FASUNI		SCALE 1:30	DRAWING NO. STG01-21301
△	ECO-NO.	DATE	CHK			
APPD	K.YAP/OSAKA	CHK	NG/TIONG	DRN	MRY	DATE : 19.10.2017