

Art.-Nr.: 10.01.12.00210

**Technical data**

| | |
|-----------------|-----------|
| Dimension (LxW) | 140 x 115 |
| Height H | 50.00 mm |

VCBL-K1 140x115x50

The vacuum block VCBL-K1 is delivered assembled. The product consists of:

- Top suction plate type VCSP-O - elastomer part, available in various dimensions and suction areas
- Main body made of plastic
- Bottom suction plate type VCSP-U - elastomer part

Available spare parts: suction plate (top), wear part set, suction plate (bottom), sealing frame, friction plate, metal strips, guide strip for vacuum block

Available accessories: suction plate (top) foam rubber

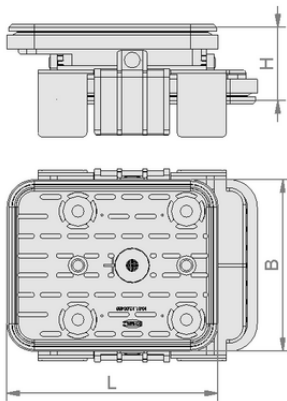
**Design data**

| | |
|----------|-----------|
| Length L | 140.00 mm |
| Width B | 115.00 mm |
| Height H | 50.00 mm |

Design data VCBL-K1 140x115x50



Art.-Nr.: 10.01.12.00210

**Technical data**

| | |
|--------------------------------|------------|
| Weight | 0.600 kg |
| Dimension suction plate bottom | 140x115 mm |

**Ordering Data Accessories 10.01.12.00210**

| Typ | | Item number |
|---------------------|-----------------------------|----------------|
| Suction plate (top) | VCSP-O 140x115x18.5 MOS TPE | 10.01.12.03507 |

**Ordering Data Spare Parts 10.01.12.00210**

| Typ | | Item number |
|--------------------|-------------------|----------------|
| Set of spare parts | ERS VCBL-Einleger | 10.01.12.00618 |

**Ordering Data Wear Parts 10.01.12.00210**

| Typ | | Item number |
|------------------------|---------------------------------|----------------|
| Suction plate (top) | VCSP-O 140x115x16.5 TPE | 10.01.12.00488 |
| Suction plate (bottom) | VCSP-U 140x115x16.5 VCBL-K1 TPE | 10.01.12.00228 |
| Set of spare parts | ERS VCBL-Einleger | 10.01.12.00618 |
| Set of spare parts | ERS VCFL DRUC-FED | 10.01.12.01256 |

