

1½ lb. and 5 lb. Beaters

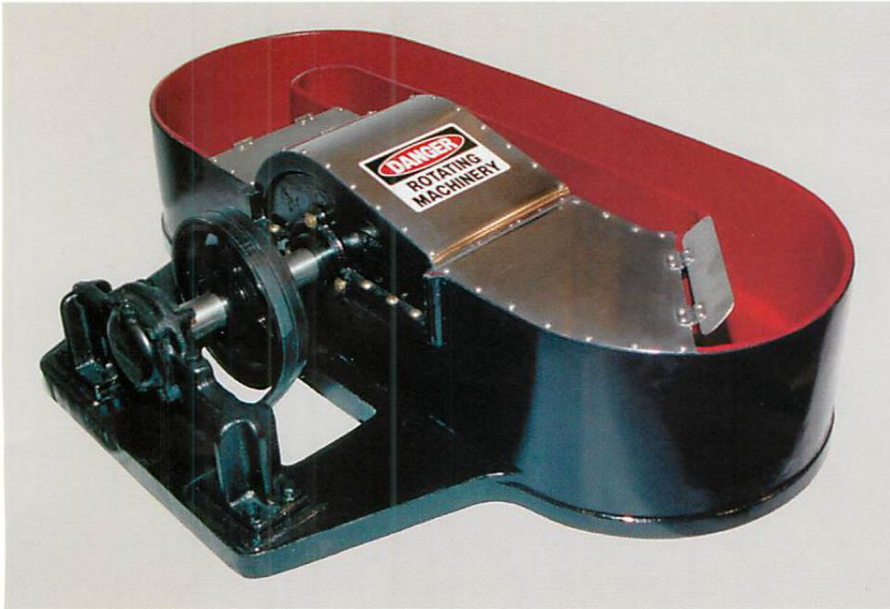

These precision beaters will subject repeated samples to a uniform, reproducible and stable treatment over substantial periods of use. Beating pressure is exactly reproducible by means of the controlled bedplate, an exclusive VALLEY feature. This allows the bedknives to be pressed against the fixed beater roll through a short lever arm, pivoted on ball bearings. Use of the standardized weight provides readily repeatable and infinite variations.

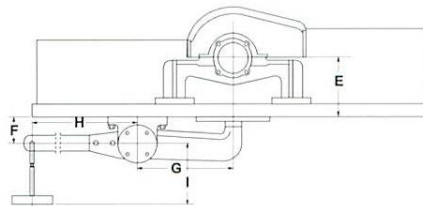
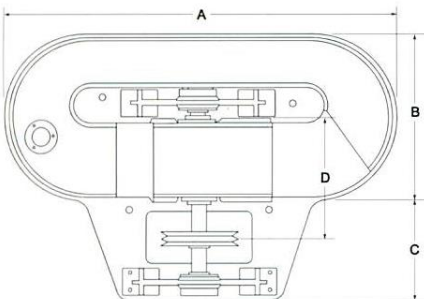

DIMENSIONS (inches)

Size	Roll	Speed	Pulley	Motor *	Motor Pulley	Capacity	Approx. Shp Wt.	A	B	C	D	E	F	G	H	I
1½ lb.	7½ Dia. by 6" face	500 RPM	7" P.D. 2A Grvs.	¾ HP 1200 RPM	3" P.D. 2A Grvs.	1 lb. @ 1½ % consistency	725 lbs.	37½	16	9½	11½	5½	2½	9	17½	15¾
5 lb.	14 Dia. by 12" face	425 RPM	12" P.D. 3A Grvs.	2 HP 1200 RPM	4.4" P.D. 3A Grvs.	Up to 8 lb. @ 3% consistency	2000 lbs.	62	29¾	13½	19¼	9	2¼	9	32¼	20¾

* Not included

TUB: Base plate and tub are cast integral insuring constant alignment. Cast iron or bronze is standard.

ROLL: The cast iron or bronze billet is accurately machined and balanced. Slots are milled on accurate centers and machined, stainless iron flybars are installed.

BEDPLATE ASSEMBLY: The bedknives are of stainless iron and are held securely in place in a cast iron or bronze bedknife box. The bedplate is machined to the roll diameter and is ground into a perfect fit.

BEDPLATE ADJUSTMENT: The bedplate is vertically adjustable through a jig-machined lever, pivoted on ball bearings. This insures constant and accurate alignment. Bedplate movement is through a flexible diaphragm. The bedplate lever is provided with a convenient weight-loading system complete with the required weights and a counterpoise to provide accurate and repeatable loading.

FINISH: The beater is painted externally with acid resisting enamel. Hood cover and decking are of stainless steel. Interior of the tub is finished with an acid, alkali and moisture resisting poly plastic.

