

MACH II™

5", 6", AND 5"/6" COMBO PORTABLE GUTTER MACHINES

MACH II™

5", 6" AND 5"/6" GUTTER MACHINES

The original polyurethane
drive system



STANDARD FEATURES

- > Polyurethane drive rollers
- > Stainless steel forming rollers
- > Power interruption safety circuit
- > Industry's best warranty (see back cover for details)
- > Welded tubular steel frame
- > Electric motor 3/4 Hp 110 VAC, 60 Hz, 1 Ph, 11 Amps
- > Push button RUN/JOG controls at entry and exit ends

OPTIONAL EQUIPMENT

Optional equipment for MACH II 5", 6", and 5"/6" Combo Gutter Machines

- » EZ-Counter Computerized Length Controller
- » TRN Turnstile reel stand
- » RL16 and RL20 reels
- » Run out stand
- » Set of 3 run out stands
- » Transfer rack
- » SH5 or SH6 geared shear
- » Bottom bead assembly
- » Riser pads
- » Machine cover
- » HK5, HK6, or HK5/6 alcoa style hook assemblies
- » Back flange shear
- » 12-Volt electrical system
- » ELEC2 3/4 Hp, 110 VAC, 50Hz, 1 Ph, 11 Amps
- » ELEC3 3/4 Hp, 230 VAC, 50 Hz, 1 Ph, 5 Amps
- » ELEC1 1 Hp, 12VDC, 80 Amps
- » REM-6-A Remote, 4-button start/stop/forward/reverse for 110-volt to 220-volt
- » Machine offered without electric power
- » Forward-pulling, easy cut shear for accuracy
- » Two 360° rotatable reel stands for easy coil loading
- » Easy lift reels

SPECIFICATIONS

Details on the MACH II 5", 6" and 5"/6" Combo Gutter Machines

5" GUTTER MACHINE

Length: 8' (2.4 m)
Width: 2' (.6 m) plus shear handle
Height: 4' (1.2 m)
Weight: 1,000 lbs. (454 kg)

SPEED

50 ft./min. (15 m/min.) approx.

MATERIAL WIDTH

5" machine: 11-3/4" to 12-3/8" (300 mm to 315 mm)
6" machine: 15" (380 mm)

6" GUTTER MACHINE

Length: 10' (3.0 m)
Width: 2' (.6 m) plus shear handle
Height: 4' (1.2 m)
Weight: 1,250 lbs. (570 kg)

SHEAR

Manually powered, hardened tool steel blades, and shear dies

MATERIALS FORMED

Painted steel: 30-ga. to 24-ga. (.3 mm to .6 mm) — painted, Galvalume, coated galvanized
Painted aluminum: .019" to .032" (.5 mm to .8 mm)
Copper: 16 oz. to 20 oz. 3/4 hard (.5 mm to .7 mm)

5"/6" GUTTER MACHINE

Length: 10' (3.0 m)
Width: 2' (.6 m) plus shear handle and extra shear
Height: 4' (1.2 m)
Weight: 1,350 lbs. (610 kg)

DRIVE

Electrically driven polyurethane rollers

GUTTER PROFILES

Straight Back profile is standard — all others optional

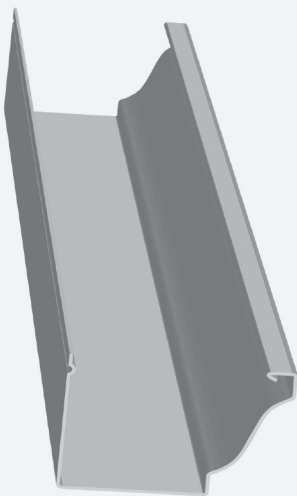
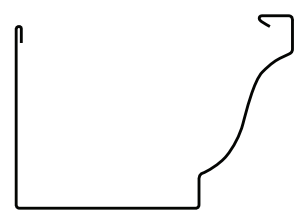
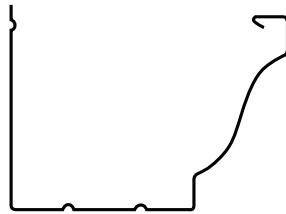
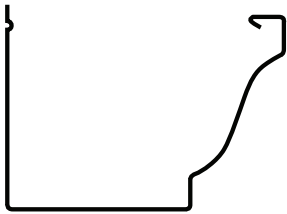

STRAIGHT BACK GUTTER

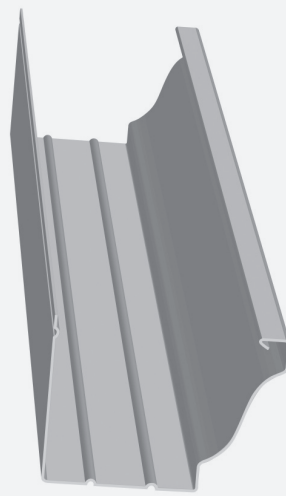

GUTTER WITH BOTTOM BEAD

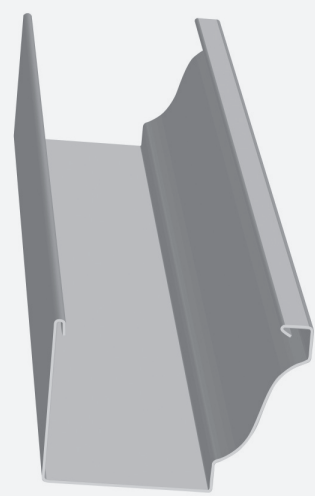

GUTTER WITH ALCOA HOOK



CONTACT US

PHONE
1.800.574.1717

WEBSITE
newtechmachinery.com

EMAIL
info@newtechmachinery.com

USA / CANADA WARRANTY

Three years parts (including electrical) / Three years labor

Limited lifetime against separation on drive rollers

Limited lifetime against wear on stainless steel forming rollers

INTERNATIONAL WARRANTY

Three years parts (including electrical) / Excluding freight

Limited lifetime against separation on drive rollers

Limited lifetime against wear on stainless steel forming rollers

WARNING: Machines should never be operated without the guards in place. Otherwise, severe injury can occur. Machine must be operated by a competent trained individual and never be operated by a person who has not had proper training, studied the video and the latest operating manual found at newtechmachinery.com/resources/machine-manuals. Failure to operate correctly or without guards can result in severe injury.

 All machines are shown with optional equipment.

