

Bohrstar 54 KIT

Rhombic insert 

Ø 8 - 170

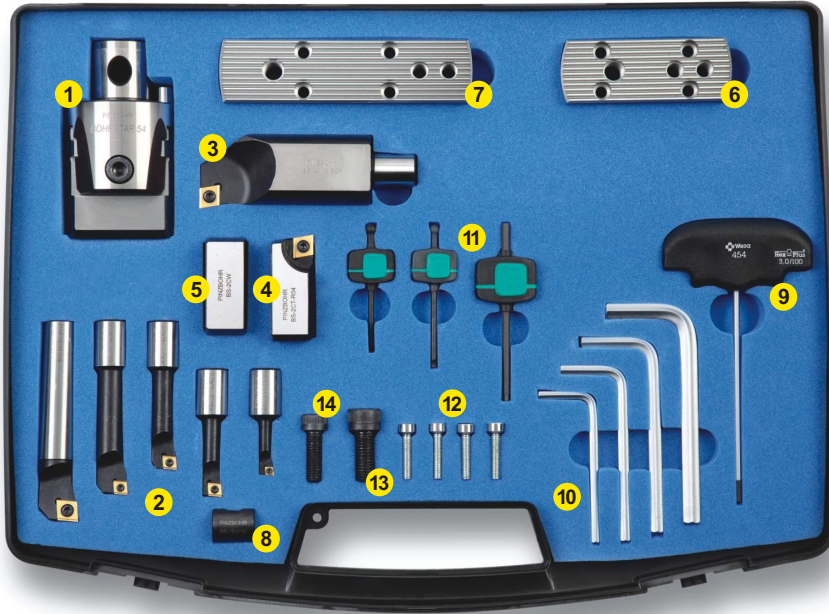

ORDERING NUMBER:
BS 54 KIT R 8-170

| | Description | Product Number | Qty. |
|---|-------------------|----------------|------|
| 1 | Bohrstar head | BS 054 16 | 1 |
| | Boring bar 6 mm. | BS 06 16 R01 | 1 |
| | Boring bar 8 mm. | BS 08 16 R03 | 1 |
| 2 | Boring bar 10 mm. | BS 10 16 R03 | 1 |
| | Boring bar 12 mm. | BS 12 16 R03 | 1 |
| | Boring bar 16 mm. | BS 16 16 R04 | 1 |
| 3 | Boring bar 34 mm. | BS 34 16 R04 | 1 |
| 4 | Cartridge | BS 2CT R04 | 1 |
| 5 | Counterweight | BS 2CW | 1 |
| 6 | Small plate | BS SP 085 130 | 1 |
| 7 | Medium plate | BS SP 125 170 | 1 |
| 8 | Location sleeve | BS 16 M10 | 1 |

| | Description | Product Number | Qty. |
|----|---------------------|----------------|------|
| 9 | Adjusting key | AK 030 | 1 |
| | Hexagonal key 4 | HK 040 | 1 |
| | Hexagonal key 5 | HK 050 | 1 |
| 10 | Hexagonal key 6 | HK 060 | 1 |
| | Hexagonal key 8 | HK 080 | 1 |
| | Torx key 6 | TK 06 | 1 |
| 11 | Torx key 8 | TK 08 | 1 |
| | Torx key 15 | TK 15 | 1 |
| 12 | Plate fixing screws | D 027 21 | 4 |
| 13 | Cartridge screw | CS 10 25 | 1 |
| 14 | Counterweight screw | CS 08 25 | 1 |

