



Equipment Sales
815 Allgood Road • Marietta, GA 30062
USA
Tel: (770) 422-7230 • Fax (770) 428-7315
www.tugtech.com

Parts Sales
TUG Shop: (800) 989-8499 * (770) 422-8021
Fax: (770) 422-8730
www.tugparts.com



Model MX4

AC Electric Baggage Tow Tractor

TUG began offering zero emissions electric powered baggage tractors over twenty years ago. The MX4 AC electric baggage tractor represents the latest in TUG's commitment to clean Ground Support Equipment (GSE). Not only is the MX4 environmentally friendly, it is also user friendly. The MX4 has been designed with the operator and maintenance technician in mind. Its design provides excellent visibility and ergonomics combined with a low center of gravity, which results in less operator fatigue. The MX4 models feature the Ecostar AC drive system.

Compared to standard DC powered baggage tractors, AC drive systems offer the benefits of better electrical efficiency, allowing for longer operation between battery charging and lower maintenance time and cost. Drive motor brushes have been eliminated and the number of electrical contactors sharply reduced. In addition to displaying the conventional battery discharge indicator and hour meter, the dash display of the MX4 serves as a diagnostic tool, allowing the technician to read faults and troubleshoot from the driver's seat. An enclosed cabin, rear inching controls and other options are also available.



Standard features include:

- Recessed headlights
- Back-up lights
- Seat belts
- Power steering
- Split braking systems
- Multiple function dash display with battery discharge indicator, hour meter and fault display
- Four wheel suspension
- Package rail

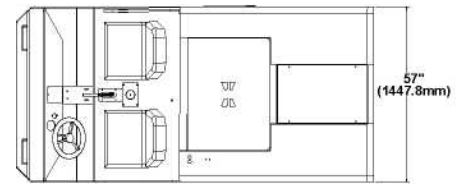
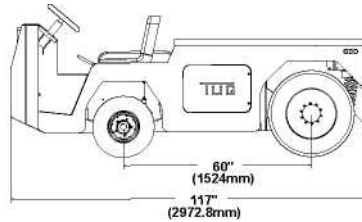
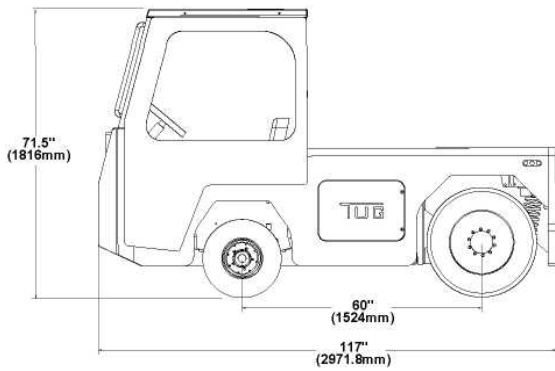

Specifications Model MX4 AC Electric Baggage Tow Tractor

Dimensions

- Length excluding hitch 117" (2972 mm)
- Width 57" (1448 mm)
- Height less cab..... 49" (1245 mm)
- Height with cab..... 71.5" (1816 mm)
- Wheelbase 60" (1524 mm)
- Ground clearance 5.5" (140 mm)
- Turning radius—Outside 150" (3810 mm)
- Inside.....93" (2362 mm)

Weight and Drawbar

Model GVW (w battery) Drawbar Pull*

MX4-45.... 7400 lb (3364 kg) 4500 lb (2041 kg)

Battery weight is approximately 3500 lb (1591 kg)

* At 0.8 traction coefficient +/- 3% variation on published drawbar pull and weight due to manufacturing tolerances

Speed

Maximum governed speed16 mph (25.7 km/h)

Drive System

- Type 80 VAC, Integrated motor/axle
- Power Electronics..... "Ecostar" 80 V
- System Power (Peak)40 hp (30 kW)
- System Power (Continuous)24 hp (18 kW)

Battery Compartment

Dimensions36" x 26 1/8"
(914.00 mm x 663.58 mm)

Battery

Powered by (1) 80 V battery
Battery **Not** included

Brakes

- Service Split hydraulic
- Front..... Dry disc brakes
- Rear Wet disc brakes
- Parking..... Wet disc brakes, lever actuated
- Electrical Intelligent, dynamic regenerative braking

Steering System

Orbitrol-operated hydraulic cylinder
(hydrostatic steering)

Suspension

- Rear Coil spring, shock dampened
- Front..... Leaf spring, shock dampened

Tires

- Front..... 6 x 9 pneumatic radial
- Rear.....8.0 x 16.5

Brakes

- Service Split hydraulic
- Front..... Dry disc brakes
- Rear Wet disc brakes
- Parking..... Wet disc brakes, lever actuated
- Electrical Intelligent, dynamic regenerative braking

Hitch

"E" hitch with extension is standard
Other options available

Instruments

Battery charge, hour meter and diagnostic faults

Partial Option List

- Cab
- Back-up alarm
- Inching controls
- Rubber bumpers
- Programming kit
- Others available upon request



Equipment Sales
815 Allgood Road • Marietta, GA 30062 USA
Tel: (770) 422-7230 • Fax (770) 428-7315
www.tugtech.com

Parts Sales
TUG Shop: (800) 989-8499 * (770) 422-8021
Fax: (770) 422-8730
www.tugparts.com