

WINKLER+ DÜNNEBIER

WD

20M

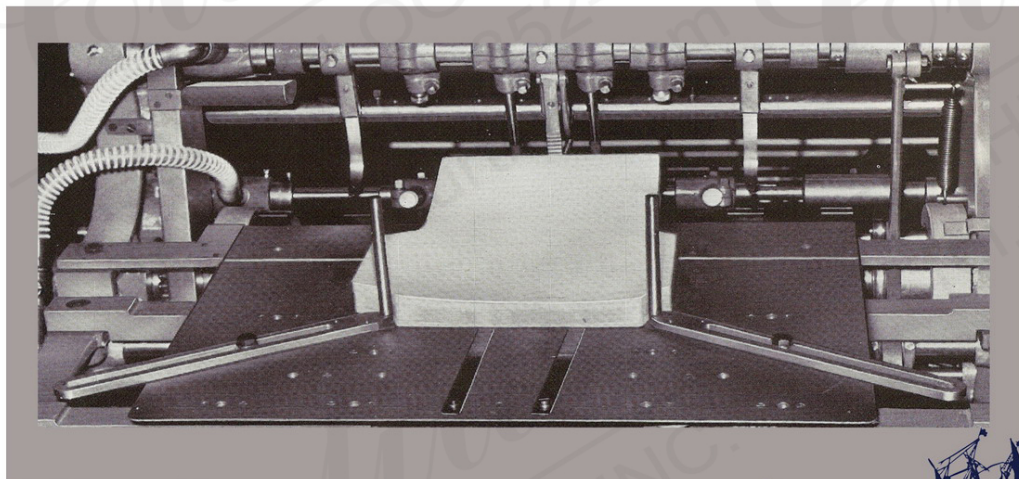
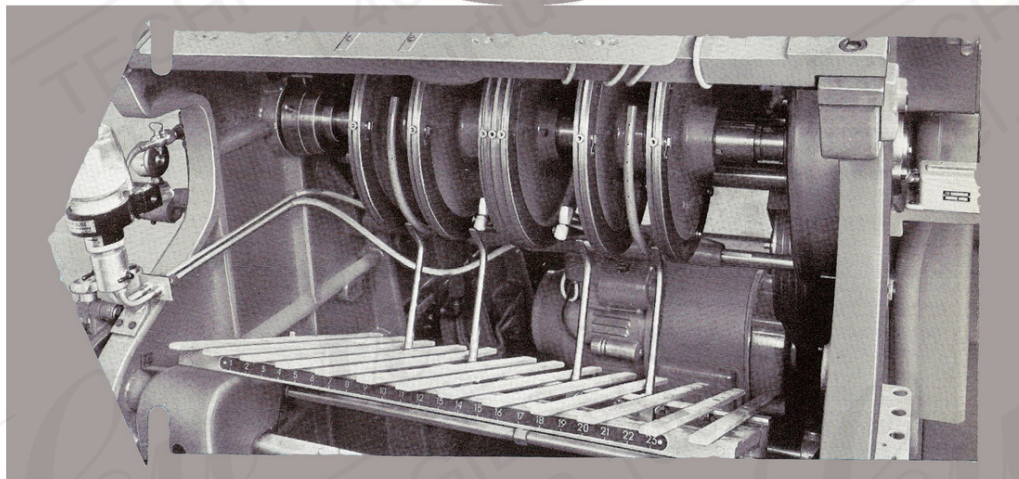

Rotary Letterpress and Flexographic Printing Press

This is the largest of our combined letterpress and flexographic printing machines for blanks and sheets. The high-capacity printing press HELIOS 20 M is mainly used for printing blanks which are subsequently folded on HELIOS machines for large-sized envelopes and pockets, such as 141 G/GS, 327 G/GS, 49 and 149. This machine can be equipped with up to 4 printing units (1 flexographic unit for inside printing, 1 flexographic unit for outside printing and 2 letterpress units for outside printing).

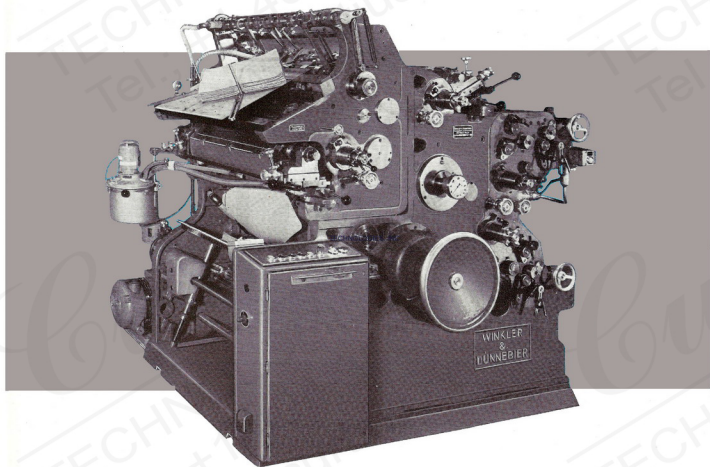

With the new high-efficiency feed unit the output of this machine has been increased. The solid construction of the cast iron frames guarantees an absolutely vibration-free running of the machine which results in extremely good printing quality.

Perfect and intensive inking of the printing plates, even for large printing surfaces. The operation of the approved flexographic printing units, which are also used on our envelope machines, is very simple and uncomplicated.

Feed unit and delivery section are on the same side of the machine, and the printing units are very accessible, facts which are much appreciated by the operators of the



Verstellbarkeit

size ranges

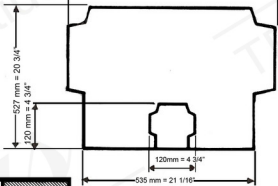
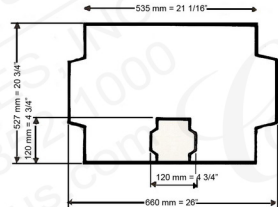
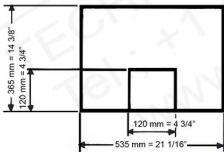
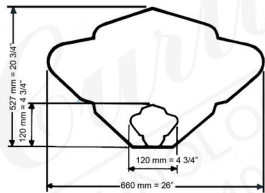

Floor space required

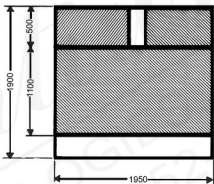

- 1 outside printing units (letterset resp. offset)
- 1 inside printing unit (flexo)
- 2 letterpress printing surface
- maximum printing surface
- 350 max. output impressions per minute
- 16kVA power required abd.
- 3500kg net weight abd.

480x580mm
(18 7/8 x 22 7/8")

Curtius
TECHNOLOGIES, INC

