



**ELECTROLYTIC
OZONE WATER MACHINE
MANUAL**

CATALOGS

1.PRODUCT SPECIFICATIONS.....	02
2.FEATURES OF ELECTROLYZED OXYGEN WATER MACHINE.....	02
3.PRODUCT DESCRIPTION.....	03
4.ATTENTION NOTES.....	04
5.PANEL FUNCTION IDENTIFICATION DISPLAY.....	06
6.BUTTON FUNCTION DESCRIPTION.....	06
7.INSTALLATION STEPS.....	07
8.ELECTROLYTIC OZONE WATER MACHINE SCHEMATIC.....	08
9.INSTRUCTIONS FOR REPLACING THE OZONE GENERATOR MODULE.....	09
10.AFTER-SALES SERVICE.....	10

PRODUCT SPECIFICATIONS

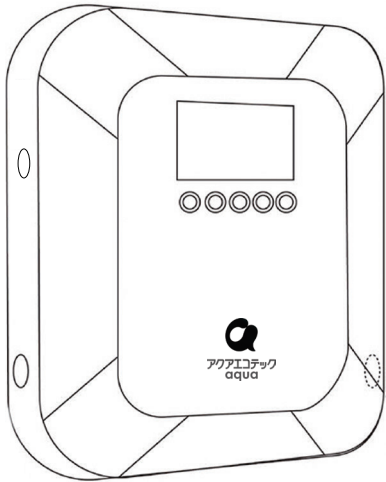

Product Name	Electrolytic ozone water machine
Model number	XY-WB1-B
Maximum Power Consumption	300W
Input voltage	AC100-240V
water flow rate	2.5-9L/MIN
Ozone concentration	0.5-3.5mg/L
Remarks: Recommended for domestic/commercial use, do not use in industrial processes.	

FEATURES OF ELECTROLYZED OXYGEN WATER MACHINE

Electrolysis ozone water system connected to the general tap water, through the advanced titanium electrode generator can be immediately generated; ozone, high concentration of hydrogen molecules, OH⁻, micro-nano bubbles of water, such as active oxygen factors, for efficient bactericidal cleaning, removal of fruits and vegetables, surface dirt, fresh water production of freshness, color-enhancing chemicals, pesticides, and other chemical residues, prolonging the role of freshness of the ingredients, the role of the washer has a bactericidal and deodorant, cleaning clothes, Soften clothing fibers, light oil removal, and maintain the tank body clean, eliminate moldy odor (recommended when the washing machine is not in use to maintain ventilation), reduce the amount of laundry detergent can be up to 90% or more advantages, extend the life of the clothing; can also be cleaned skin, bathing and other personal cleaning and household cleaning, ozone water has an anti-inflammatory, astringent wounds, wounds, or skin abnormalities can be commonly used in ozone water to improve the ozone has a certain degree of anti-inflammatory and antiallergic effect, can relieve and alleviate the skin, and can also help to improve the skin, and can be used in the washing machine, and can help to improve the skin. Ozone has a certain anti-inflammatory and anti-allergic effect, can relieve and alleviate skin allergies, eczema, acne, etc. to improve the repair effect. It is recommended to consult with relevant qualified medical personnel before use.

Electrolyzed ozone water is zero-chemical, environmentally friendly, non-irritating, and can be used by sensitive skin without residue or secondary pollution. Ozone molecules will be reduced to oxygen within 30 minutes, and electrolyzed ozone water can help accelerate the healing process of wounds, reduce the risk of infection, and promote the regeneration of skin cells.

Electrolysis ozone water machine application time:

- Medical sanitizing hand washing, clinic cleaning, dental chair water, surgical hand and appliance cleaning, toilet tanks
 - Mother's helper, daily household cleaning, fruits and vegetables to remove pesticide residue, prolong the freshness and safety of ingredients, toys cleaning and disinfecting, mopping floors, gardening watering and so on.
 - bath cleaning care: effective and rapid removal of bacteria and viruses on the surface of the skin, help to improve skin luster and skin discomfort or abnormalities, so that the body is more refreshing and healthy, pleasant, (This equipment is only for improvement, do not use it for treatment, please consult the relevant professional qualified medical personnel if you have any questions).
 - Grooming and bathing water for furry children, highly effective in improving skin problems, preventing skin diseases, and promoting the repair and healing of surface wound tissue, so that furry children are healthier and closer to you.
 - Provide high concentration of ozone sterilizing water for washing machine, reducing the use of detergent by more than 90%; even completely eliminating the need for detergent and shortening the washing time and water consumption (normal condition is also possible).
- It can even eliminate the need of detergent and shorten the washing time and water consumption (you can also use the right amount of detergent according to the state of dirtiness of the clothes), solving the discomfort and allergic reaction of chemical contact with the skin, the smell of the clothes and the washing machine, the bacteria breeding, the mold and mildew, and the biofilm breeding in the washing machine.
- It eliminates allergens and cleans the laundry tank, making it easy to take care of your health and save your wallet.
- Provide dishwasher with high concentration of ozone sterilized water to remove bacteria and viruses from food, kitchenware and countertops, and solve the problem of odors and bacteria growth in dishwasher ducts.
 - Can be used in other areas and applications where cleaning is essential.

PRODUCT DESCRIPTION

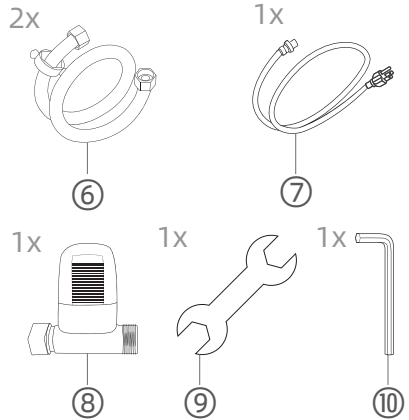
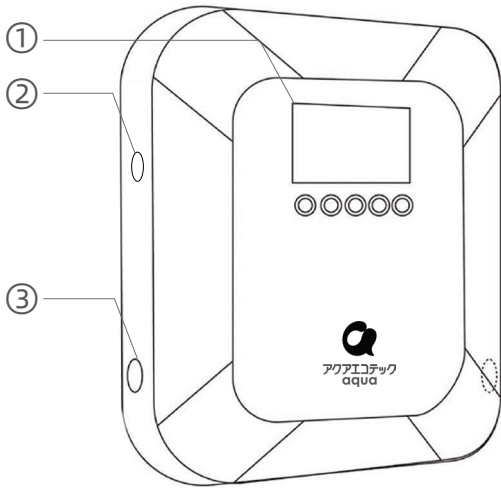

- ① Display screen
- ② DC12V Power Supply Interface
(DC5.5*2.5 Female Socket) (Max Power: 58W)
- ③ Ozone water outlet
- ④ Power cord connector
- ⑤ Water Inlet
- ⑥ 1.5 Meter (59 Inch) Water Hose
(1/2 Inch Internal Threaded Connector)
- ⑦ 3 Meter (118 Inch) Power Cord
- ⑧ Dual Threaded filter (one end with 1/2 inch internal thread,
and the other end with 1/2 inch external thread)
- ⑨ Wrench
- ⑩ Hex key

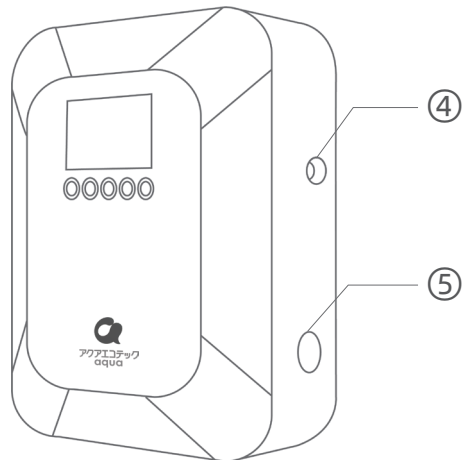

This manual includes basic installation instructions, usage guidelines, and maintenance information for this product. For more detailed information, please contact our service center or your local authorized dealer.

IMPORTANT INFORMATION FOR INSTALLERS

This manual contains important information about the installation, operation and safe use of this product, which should be provided to the product owner or user at the time of product installation, and unauthorized disassembly or modification of this product is strictly prohibited to avoid the loss of warranty (repair) rights and create a safety hazard.

USER INFORMATION

This manual contains important information regarding the use and maintenance of this product. Please keep it for future reference.

To prevent accidents, injuries, or property damage when installing, using, or maintaining this product, it is essential to follow these safety instructions:

EXPLANATION OF SAFETY AND NOTIFICATION SYMBOLS:

 "WARNING" : Indicates a potential hazard which, if not avoided, could result in death or serious injury.

 "CAUTION" : Indicates a potential hazard which, if not avoided, may result in personal injury or property damage.

ELECTRICAL SAFETY AND FUNDAMENTAL PROTECTION MEASURES

All maintenance work (excluding machine maintenance and filter replacement) must be carried out by authorized and qualified technicians. Do not attempt to dismantle, repair, or modify this product yourself. Doing so will void the warranty and may result in fire or electric shock.

If the product malfunctions or is damaged in any way, please unplug the device power cord and contact the international service department or its authorized local distributor to arrange for service or repair.

- Please do not damage the power supply and power cord. Damaged power supply or power cord lines may cause fire or electric shock.
- Do not stretch, bend, pull, twist, fold, tie, or attempt to modify the power cord or plug.
- If the power supply or plug is damaged, it must be replaced by the manufacturer, authorized service dealer, or professional to avoid danger.
- Plugging too many devices into the same outlet may cause the power outlet to overheat and result in a fire.
- Do not use power voltages other than those specified on the product and power supply. Using any other power voltage may cause fire or electric shock."

WARNING

- Do not insert or remove the power plug when your hands are wet, as it may result in electric shock or injury.
- If the prongs of the power plug are loose, do not use this product, as it may cause fire, electric shock, or short circuit. Before use, ensure that the power plug is fully inserted into the power outlet.
- Keep the product and power cord away from heat sources or hot surfaces, including electric heaters, stoves, and similar appliances.
- Do not immerse the machine in water or spray water on it, as it may damage the machine or cause electric shock.
- If any abnormalities or malfunctions are observed, please discontinue use of this product immediately:
 - Power supply or power cord/plug damaged.
 - Power supply or power cord/plug abnormally heating up.
 - Abnormal heating or deformation of the product body.
 - Product emitting smoke or a burnt smell.
 - Cracks, looseness or instability in some parts of the product, or abnormal and unrecognizable conditions.
- If any of the above phenomena occurs, please unplug the product immediately and report to after-sales service for professional assistance. Continued use of the product may result in fire, electric shock or injury.

ATTENTION NOTES

USAGE PRECAUTIONS

- ☒ This machine is designed to be directly supplied with tap water, preferably with a conductivity of >110 μ s, and the temperature maintained between 1-45°C or 33.8-113°F.
- ☒ Do not use sources of water other than tap water, such as seawater or distilled water.
- ☒ An alarm will sound 'drip drip...' if the water temperature exceeds 45°C or 113°F.
- ☒ In case of a malfunction of the turbo pump, an icon will appear on the screen accompanied by an alarm sound 'drip drip...' and the screen will display a pump malfunction icon.
- ☒ If there is a malfunction or damage to the electrolysis module, an icon will appear on the screen accompanied by an alarm sound 'drip drip...' and the screen will display an electrolysis module malfunction icon.
- ☒ In the event of a malfunction of the vortex switch, an icon will appear on the screen accompanied by an alarm sound 'drip drip...' and the screen will display a vortex switch malfunction icon.
- ☒ After proper installation, the machine needs to be activated for the first time by pressing the ON/OFF button on the panel and ensuring that all components are correctly installed. At this point, the machine is in standby mode. When the faucet is turned on, the machine will automatically activate. When the faucet is turned off, the machine will automatically return to standby mode (the water flow switch icon on the display panel will be red, no alarm sound, indicating normal standby status).
- ☒ This machine is for indoor use only. Please use it at normal room temperature (1°C - 45°C) to avoid freezing and damaging the internal components of the machine.

SPECIFIC SECURITY INFORMATION

For your own personal safety and to prevent accidental product damage, please ensure that you read and understand this instruction manual.

- ☒ For your personal safety and to prevent product damage, please ensure that you read and understand this manual.
- ☒ Always ensure that all circuits are disconnected before performing repair, maintenance, or installation work.
- ☒ After performing repair, maintenance, or installation work, always ensure that all original factory-installed parts and components are correctly reinstalled and in good condition. Do not use inappropriate tools, instruments, or replacements, as they may damage equipment components. Do not remove any parts attached to the equipment. They may be necessary for correct and safe installation and operation and keep away from any open flame (greater than 1 meter away) to ensure prevention of any potential hazards or damages.
- ☒ Do not attempt any repairs when the equipment is wet. Before performing any maintenance work, be sure to turn off the power and disconnect the power source. Otherwise, serious injury or death may occur due to electric shock.
- ☒ Ensure that the power and water supply meet the requirements in the product specifications. Failure to install, operate, and maintain this equipment as directed may result in warranty voidance, as well as personal injury or product damage.

Remarks:

FAULT DESCRIPTION

Failure manifestation	Solution
When the water temperature exceeds 113°F, an alert will be triggered.	Turn off the machine first, then adjust the water temperature to (5~43°C) or (41~109.4°F) range can work normally
When using the circulating water pump, too many water bubbles into the pump, the pump is not working properly and there is a prompt display	Keep the distance between the water suction outlet and the water outlet greater than 35CM
When used without a circulating water pump, the machine cannot generate ozonated water	Turn circulating water pump mode off, no circulating water pump icon is shown on the display

PANEL FUNCTION IDENTIFICATION DISPLAY

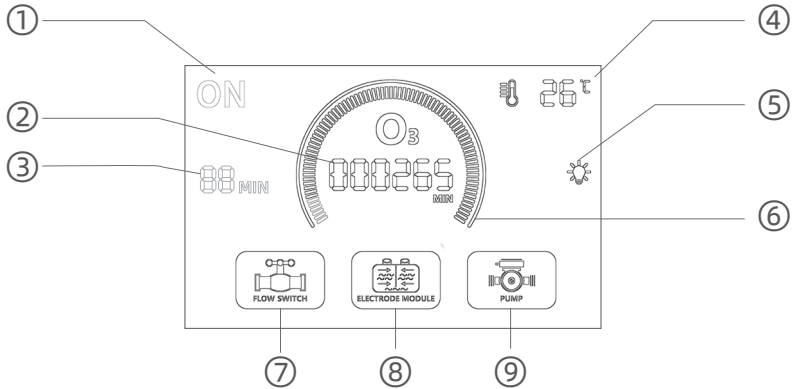

- ① Device Switch Status ② Accumulated Work Hours ③ Set Working Hours ④ Water Temperature
 ⑤ Fault Indicator Light ⑥ Work Status Display ⑦ Water Flow Switch ⑧ Electrolytic Ozone Module
 ⑨ Water Pump

BUTTON FUNCTION DESCRIPTION



C/F	Short press this button to switch between Celsius and Fahrenheit.
ON/OFF	<p>1. Short press this button to power on or off the device; (Once this mechanical switch mode is activated, subsequent ozone electrolysis startup and shutdown can be controlled via the terminal faucet switch).</p> <p>2. Long press this button to turn off or activate the water pump. If no need to connect water pump, pressing and holding this button for 5 seconds will turn off the water pump, and the pump icon will disappear from the screen. If need to connect water pump, need to buy water pump and an additional power cord separately, connect the power cord one end to "DC 12V" port and the other end to water pump, the water pump will work.</p>
MODE	Long press this button to activate "Fault Indicator Light " at ⑤ position. When this light turn yellow, it means something goes wrong for the device.
T+	Long press this button for 2 seconds to activate the timer function. The original time setting is 50minutes. Short press this button (or hold it down without releasing) to increase the time, with a maximum display value of 99.
T-	After long press "T+" button to show time setting at ③ position, short press this button (or hold it down without releasing), the time will decrease, with a minimum display value of 02
<p>Memory Function for Timed Settings: Upon each startup, the device will remember the previously set time for timed operations. To set a new time, adjust using the T+ and T- keys as described above.</p>	

INSTALLATION STEPS

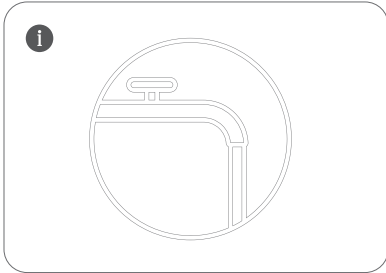

- 1** Ensure it's city tap water source.
Make sure there are no pre-installed filtration devices.
Ensure the TDS of tap water source is above 50

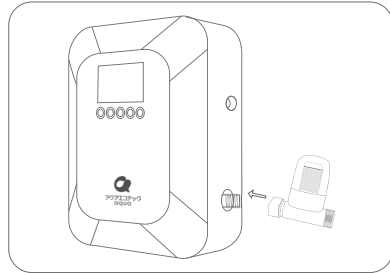

- 2** Install the filter to the screw at the lower right "IN" position

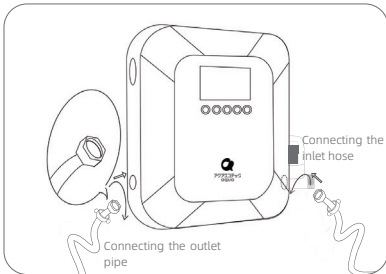

- 3** Connect the outlet pipe to the left side "OUT" position, and connect the inlet pipe to the filter on the right side.

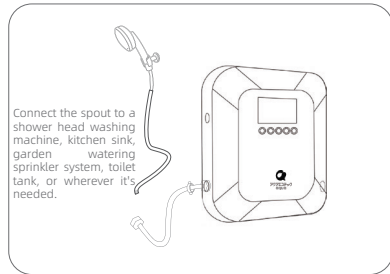

- 4** Connect the water outlet pipe to other outlet device as needed such as shower head, kitchen sink, washing machine etc.

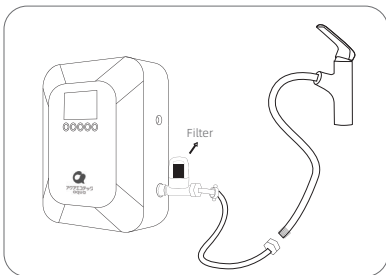

- 5** Connect the water inlet pipe to the water supply source

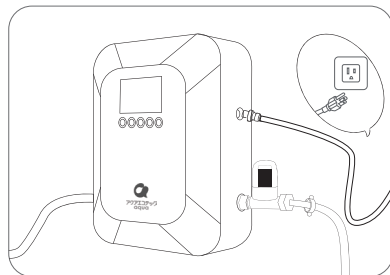

- 6** Connect the power cord to the power port on the upper right side "INPUT: AC100-230V" position, and plug the other side into the power socket.

INSTALLATION STEPS

CAUTION

- After connecting the waterway, check for any leakage. If leakage occurs, please identify the source and reinstall accordingly.
- Ensure the product is securely installed. Connect one end of the power supply adapter to the product's power interface and the other end to a standard 110V household power outlet. At this point, the product is in standby mode.

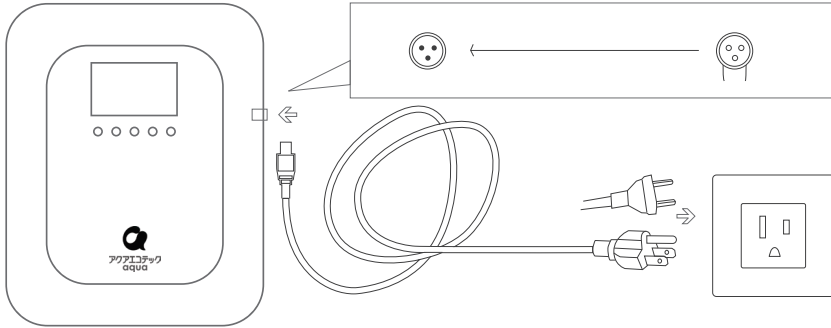

·Product Usage Instructions

- After water and electricity are connected, the machine enters standby mode.
- When water flows from the machine's outlet, the machine is in operation and instantly produces ozone water.
- Use as needed based on actual usage.

ELECTROLYTIC OZONE WATER MACHINE SCHEMATIC

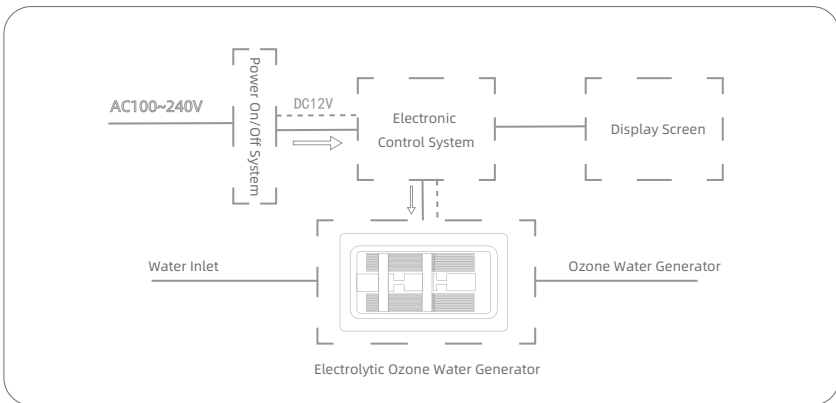

INSTRUCTIONS FOR REPLACING THE OZONE GENERATOR MODULE

MODULE REPLACEMENT CYCLE

Recommended Replacement Time for Electrolytic Ozone Module: It is recommended to replace the module every 12 months or after the machine sounds an alarm.

SPECIAL PRECAUTIONS WHEN REPLACING THE ELECTROLYTIC OZONE MODULE:

1. Close the water source inlet.
2. Unplug the power plug.
3. Open the faucet to drain the water from the pipeline.
4. Proceed with the following steps as illustrated in the diagram.

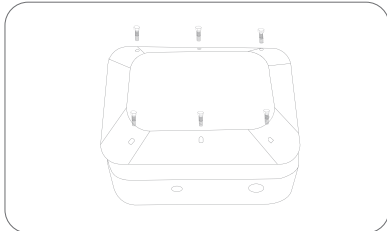

① Remove the rear panel of the chassis

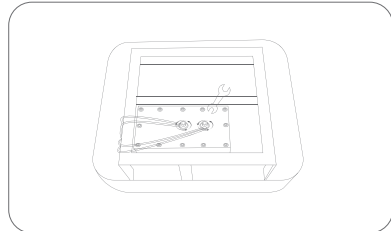

② Use a wrench to loosen the center electrode nut.

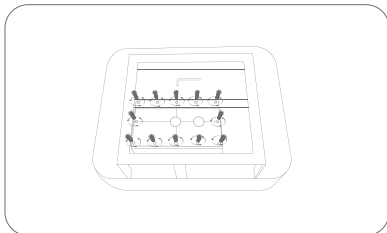

③ Use a hex key to loosen the screws around the perimeter.

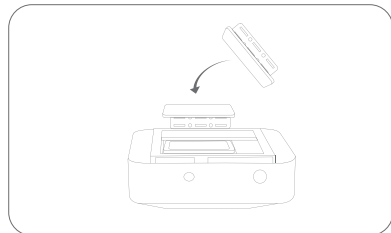

④ Replace Ozone Generator Module

Please follow the installation steps in reverse order (③-②-①) to uninstall

After replacing the module, please check for any accumulated water inside the machine. If found, dry it off before replacing the back cover.