

# Venta™ Pontoon Anchor Winch

## Installation and Owner's Manual

(For Aftermarket Applications)

Part #	Description
2022120902	Pontoon Anchor Winch

## Table of Contents

<b>Introduction</b> .....	2	<b>Wiring</b> .....	9
<b>Safety</b> .....	2	General Wiring .....	9
<b>Parts List</b> .....	3	Electric Cable Selection .....	9
Additional Components Required for Installation and Operation .....	3	Appropriate Cable Gauge/Size by Cable Length .....	9
Compatible Bow Roller .....	3	Circuit Protection .....	9
Compatible Anchors .....	3	Disconnect Isolator .....	9
<b>Specifications</b> .....	3	<b>Power Specifications</b> .....	9
Product Dimensions .....	3	<b>Wiring Diagram</b> .....	10
Operational Specifications .....	4	<b>Operation</b> .....	11
Rope Specifications .....	4	Prior to Operation .....	11
<b>Resources Required</b> .....	4	Dropping the Anchor .....	11
<b>Installation</b> .....	4	Raising the Anchor .....	12
Installing the Winch and Bow Roller Directly to Decking or a Mounting Plate .....	4	<b>Maintenance</b> .....	12
Installing the Winch and Bow Roller to the Aluminum Beams .....	6	<b>Troubleshooting</b> .....	13
Installing the Controller .....	7	<b>Limited Warranty and Key Terms of   Supply by Lewmar</b> .....	14
Installing the Switch .....	8	<b>Switch Mounting Template</b> .....	15
Installing the Anchor .....	8		
Releasing Additional Chain From the Winch for Anchor Installation .....	8		

## Venta™ Pontoon Anchor Winch Installation and Owner's Manual (For Aftermarket Applications)

### Introduction

The Venta™ Pontoon Anchor Winch is used to raise and lower the anchor with ease at the touch of a button.

In this manual the term “rode” is used to define the length of rope and chain that attaches the winch to the anchor. The term “rope” is used to define the rope that is used in conjunction with the chain to make up the rode.

Additional information about this product can be obtained from [lci1.com/support](https://lci1.com/support) or by using the LippertNOW app. Replacement kits can be ordered from <https://store.lci1.com/> or by using the LippertNOW app.

The LippertNOW app is available for free on Apple App Store® for iPhone® and iPad® and also on Google Play™ for Android™ users.

App Store® and iPad® are registered trademarks of Apple Inc.

Google Play™ and Android™ are trademarks of Google Inc.

### Safety

Read and fully understand all instructions before installing or operating this product.

Consult the boat manufacturer for information regarding the strength or suitability of the mounting location chosen for this product.

Adhere to all safety labels.

#### **⚠ WARNING**

ALWAYS PROPERLY STOW THE ANCHOR AND RODE BEFORE LEAVING PORT/ANCHORAGE ACCORDING TO PREVAILING SEA/LAKE/RIVER CONDITIONS. ACCIDENTAL DEPLOYMENT MAY CAUSE SIGNIFICANT PROPERTY DAMAGE OR HARM INCLUDING DEATH.

#### **⚠ WARNING**

KEEP LIMBS, DIGITS, CLOTHING, AND HAIR CLEAR OF WINDLESS, RODE, AND ANCHOR DURING OPERATION. SEVERE BODILY HARM COULD RESULT.

#### **⚠ WARNING**

NEVER DROP THE ANCHOR WHEN SWIMMERS OR DIVERS ARE PRESENT.

#### **⚠ WARNING**

WINCHES MUST NOT BE USED AS THE SOLE MEANS OF SECURING THE ANCHOR TO THE BOW FITTING, PARTICULARLY IN STORM CONDITIONS.

#### **⚠ WARNING**

DO NOT USE THE WINCH FOR ANY PURPOSE OTHER THAN DEPLOYMENT AND RECOVERY OF THE ANCHOR.

#### **⚠ WARNING**

ALWAYS PROPERLY STOW THE ANCHOR AND RODE ACCORDING TO PREVAILING SEA/LAKE/RIVER CONDITIONS. ACCIDENTAL DEPLOYMENT MAY CAUSE SIGNIFICANT PROPERTY DAMAGE OR HARM INCLUDING DEATH.

#### **⚠ CAUTION**

WINCHES ARE INTENDED AND SUPPLIED FOR ANCHOR CONTROL IN MARINE APPLICATIONS AND NOT TO BE USED IN CONJUNCTION WITH ANY OTHER USE.

#### **⚠ CAUTION**

THE CIRCUIT BREAKER INCLUDED WITH THIS PRODUCT MUST NEVER BE DEACTIVATED OR BYPASSED. DOING SO MAY CAUSE DAMAGE TO THE MOTOR AND CABLES FROM OVERHEATING.

#### **⚠ CAUTION**

FLYING DUST, DIRT, AND DEBRIS CAN CAUSE SEVERE IRRITATION AND DAMAGE TO SOFT TISSUE. USE APPROPRIATE PERSONAL PROTECTIVE EQUIPMENT (PPE), SUCH AS SAFETY GLASSES AND GLOVES BEFORE INSTALLATION.

## Venta™ Pontoon Anchor Winch Installation and Owner's Manual (For Aftermarket Applications)

### Parts List

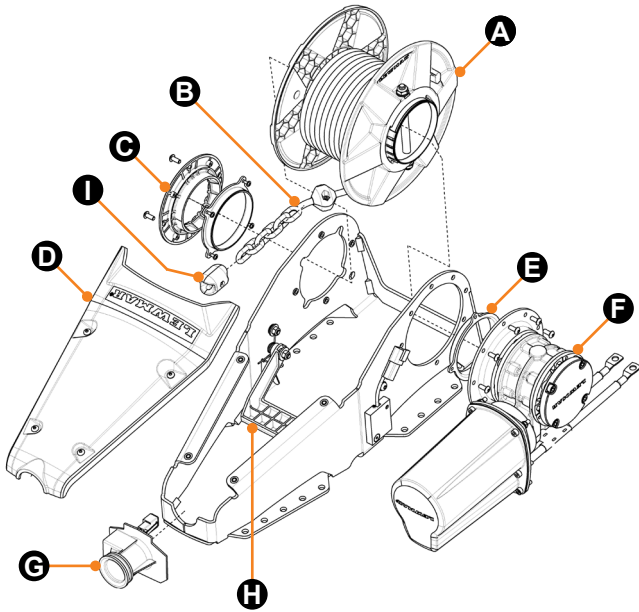

Letter	PN	Description
A	2022375378	Composite drum
B	2023041350	Rope / chain rode with sensor clasps
C	2022373342	Bearing support
D	2022373347	Chute cover
E	2022373349	Drum Bearing
F	2022375378	Motor gearbox
G	2023032311	Rope guide with chain sensor
H	2022448705	Slack line sensor
I	2023025031	Chain sensor clasp
Not Pictured	2022453745	Fixing hardware kit containing: <ul style="list-style-type: none"> <li>• 6x M8 Cap head screws</li> <li>• 6x M8 Button head screws</li> <li>• 12x M8 Nyloc nuts</li> <li>• 24x M8 Washers</li> <li>• 4x Cable ties</li> </ul>
Not Pictured	n/a	5m (16') controller to switch harness

**NOTE:** Part numbers are shown for identification purposes only. Not all parts are available for individual sale. All parts with a link to the Lippert Store can be purchased.

### Additional Components Required for Installation and Operation

A bow-roller and anchor are required for operation of the Venta™ winch and must be purchased separately. The following tables suggest a compatible bow roller and compatible anchors.

#### Compatible Bow Roller

Part #	Description
2022375783	Pontoon Bow Roller
2023049445	Pontoon Extendable Bow Roller

#### Compatible Anchors

Part #	Description
2020329216	5.5kg (13lbs) Short Shank Delta Style Anchor (Galvanized)
2020221486	6kg (14lbs) Short Shank Epsilon Style Anchor

### Specifications

#### Product Dimensions

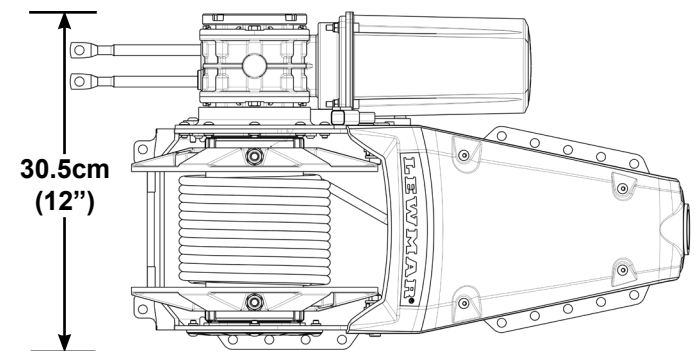
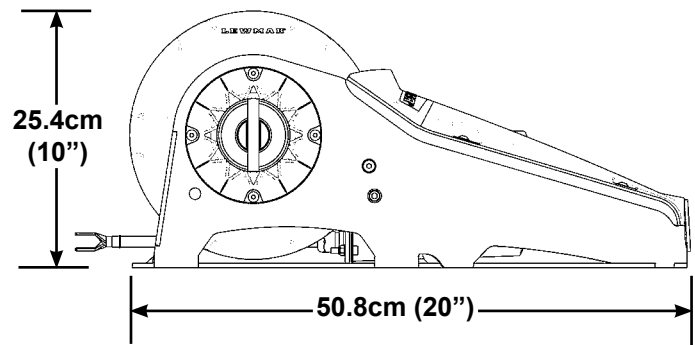

### Operational Specifications

Maximum Line Speed	Maximum Tackle Weight	Maximum Pull*	Product Weight
3 m/minute (75 ft/minute)	40 kg (88 lbs)	100 kg (220 lbs)	15 kg (33 lbs)

**NOTE:** \*Maximum Pull refers to the maximum amount of weight the winch can experience for **ONLY** short bursts while breaking the anchor free from the bottom of the bed of water.

### Rope Specifications

The winch comes equipped with 28.04m (92') of 8mm (0.3") rope and 2m (6 1/2') of setting chain.

## CAUTION

**ONLY LEWMAR-SUPPLIED REPLACEMENT ROPE KITS ARE COMPATIBLE WITH THIS PRODUCT. DO NOT USE OTHER ROPE KITS OR THE AUTO-STOP FEATURE WILL NOT FUNCTION CAUSING DAMAGE TO THE UNIT.**

## Resources Required

- Electric drill
- 8.5mm (2 1/64") drill bit
- 5.5mm (7/32") drill bit
- Crimping tool
- Painter's tape
- 25mm (1") drill or hole saw
- 70mm (2 3/4") drill or hole saw
- Jig saw
- Flat head screwdriver (medium)
- Allen wrench/hex key
- Adjustable wrench
- 6mm allen/hex key
- 5mm allen/hex key
- 4mm allen/hex key
- Four #6 (9/64") screws
- Hand file or sandpaper
- Suitable electrical cable and crimp terminals (see the Wiring section of this manual)

## Installation

A pontoon bow roller and anchor are recommended for use with the Venta™ winch. For best results, bow roller part number 2022375783 or extendable bow roller part number 2023049445 and anchor part number 2020329216 are designed specifically to work together for trouble-free deployment and anchoring with the Venta™ winch.

To facilitate the winch and bow roller beneath the deck of the boat it may be necessary to use a mounting plate. This plate will bolt to the lateral aluminum structural beams.

There are several options for installing the winch and bow roller depending on the setup of the vessel. It may be installed directly to the deck itself (if the deck has the requisite thickness of 10mm), a mounting plate, or the lateral aluminum structural beams of the vessel. Follow the appropriate instructions guidelines in this manual for your vessel's setup.

### Installing the Winch and Bow Roller Directly to Decking or a Mounting Plate

The deck must be flat and a minimum of 10mm (.39") thick for proper mounting.

If the deck is not thick enough or flat, a suitable mounting plate is required to take up camber or sheer. This mounting plate must bolt to the lateral aluminum structural beams and be a minimum of 10mm (.39") thick. This will act as the decking. It is recommended that one plate be used for both the winch and the bow roller. Double check the length of the intended plate to make sure it can accommodate the full length of the winch and the bow roller, with a maximum of 2.54cm (1") between the two.

**NOTE:** If in doubt about the suitable construction of a mounting pad or location consult a qualified marine engineer. The deck/pad is an integral component of the winch's mounting; it must secure the winch and bow roller and be strong enough to cope with the high stresses involved in recovering the anchor.

## Venta™ Pontoon Anchor Winch Installation and Owner's Manual (For Aftermarket Applications)

1. Switch off the boat's battery power supply.
2. If a plate is needed for installation, install the plate first to the beams of the vessel. The plate position should be decided then attachment holes drilled in the beams and through the plate by carefully measuring and marking the locations of the beams on the plate. Fasten the plate to the beams using customer-supplied hardware. The plate should be firmly fastened to all the beams that it spans on both the left and right sides symmetrically.
3. Dry fit the winch and bow roller to the decking or mounting plate and mark the position of each. The bow roller should be installed forward of the winch with the aft end of the bow roller spaced a maximum of 2.54cm (1") (Fig. 1A) from the fore end of the winch. A larger gap will cause the chain and warp to become slack and snag. The assemblies must be in line and parallel with each other. Make sure the center line of the anchor shank or bow roller aligns with the center line of the winch housing and bow roller (Fig. 1).

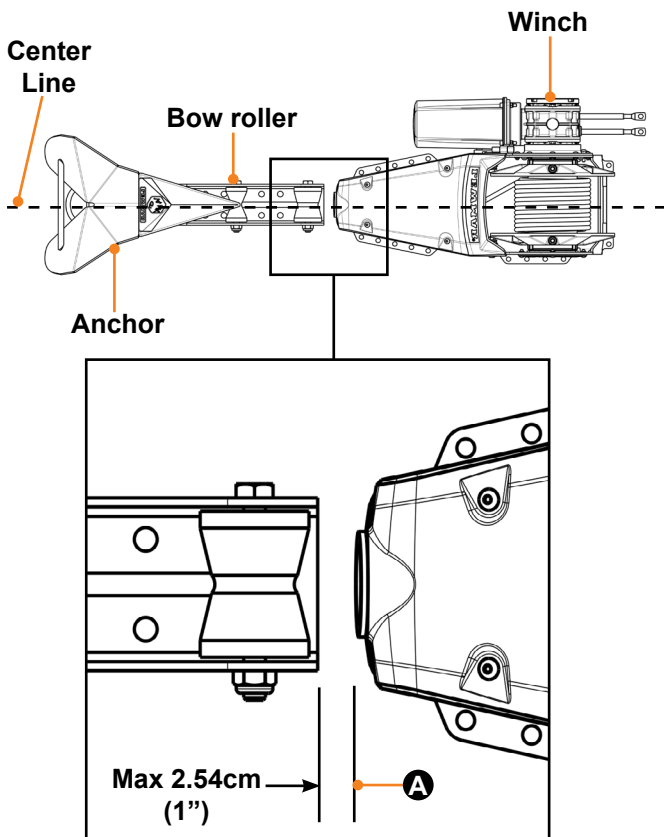

Fig.1

4. The lead from the bow roller should be fed horizontally back to the winch rope feeder, and not at an angle (Fig. 2).

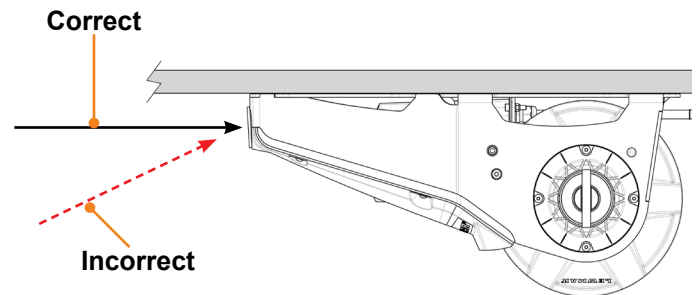

Fig.2

5. Fasten the winch chassis to the decking or plate using two of the included M8 (5/16") bolts in the two aft most holes (Fig. 3A).
6. Install the remaining four bolts based on the layout of the mounting location. It is recommended that two bolts are placed symmetrically near the fore of the chassis (Fig. 3B), and two are placed symmetrically near the middle (Fig. 3C).

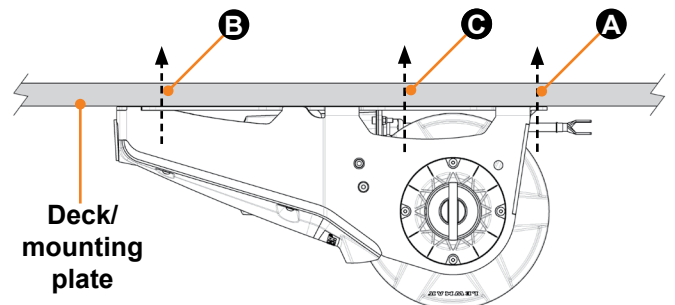

Fig.3

7. Fasten the bow roller to the decking or plate using the six button head fasteners included with the winch. Use two screws at the aft end (Fig. 4A), two at the fore (Fig. 4B), and two at the center of the bow roller (Fig. 4C).

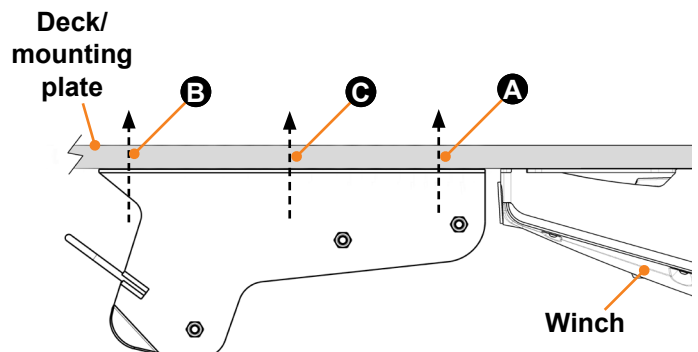

Fig.4

### Installing the Winch and Bow Roller to the Aluminum Beams

1. Switch off the boat's battery power supply.
2. Examine the beams. If the beams are not flat a mounting plate is required. Follow the instructions in the "Installing the Winch and Bow Roller to Decking or a Mounting Plate" section in this manual for guided installation.
3. Dry fit the winch assembly to the beams and mark its location. The aft most mounting holes on the winch must align with a beam (Fig. 5A) and at least two pairs of symmetrical, left and right holes near the middle (Fig. 5B) and fore (Fig. 5C) of the winch must also align with a beam. If the beams do not line up with the pre-drilled mounting holes of the winch a mounting plate is required for installation. Follow the instructions in the "Installing the Winch and Bow Roller to Decking or a Mounting Plate" section in this manual for guided installation.

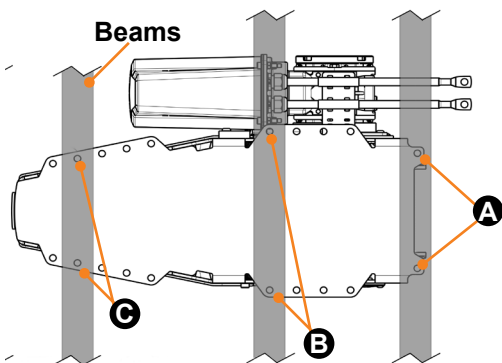

Fig.5

**NOTE:** If in doubt about the suitable construction of a mounting location consult a qualified marine engineer. The aluminum beams are an integral component of the winch's mounting; they must secure the winch and be strong enough to cope with the high stresses involved in recovering the anchor.

4. Dry fit the bow roller to the beams noting the marked location of the winch. The bow roller should be installed forward of the winch with the aft end of the bow roller spaced a maximum of 2.54cm (1") from the fore end of the winch (Fig. 6A). A larger gap will cause the chain and warp to become slack and snag. The aft most mounting holes (Fig. 6B) and fore most holes (Fig. 6D) on the bow roller must align with a beam (Fig. 6B). Optionally, for extra security a set of third holes can be aligned near the center of the bow roller where a beam is available (Fig. 6C). The winch and bow roller assemblies must be in line and parallel with each other. Make sure the center line of the anchor shank or bow roller aligns with the center line of the winch housing and bow roller (Fig. 6). If the beams do not line up with the pre-drilled mounting holes of the bow roller, the winch and bow roller can not be placed close enough together, or the assemblies can not be placed parallel and centered in relation to each other a mounting plate is required. Follow the instructions in the "Installing the Winch and Bow Roller to Decking or a Mounting Plate" section in this manual for guided installation.

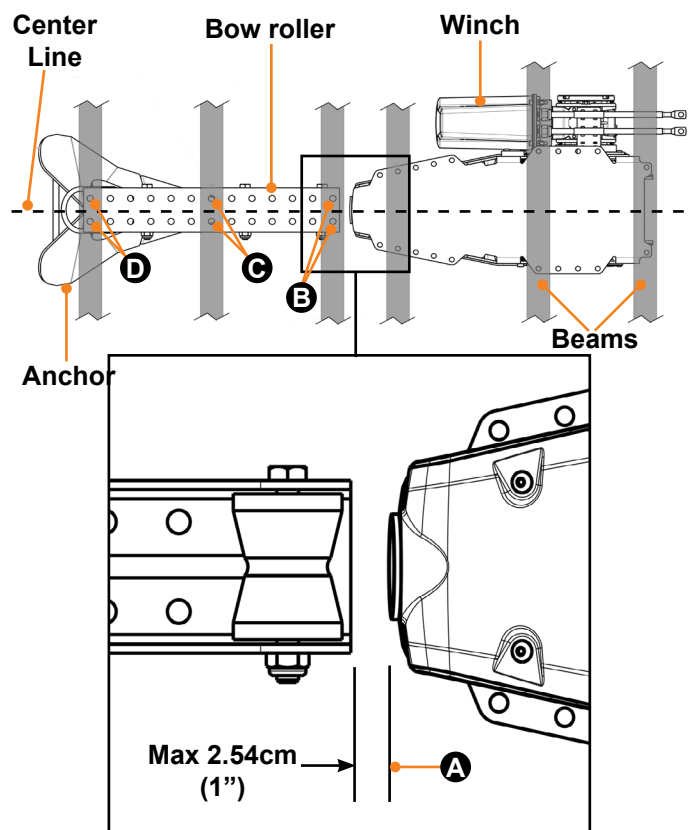

Fig.6

## Venta™ Pontoon Anchor Winch Installation and Owner's Manual (For Aftermarket Applications)

5. The lead from the bow roller should be fed horizontally back to the winch rope feeder, and not at an angle (Fig. 7).

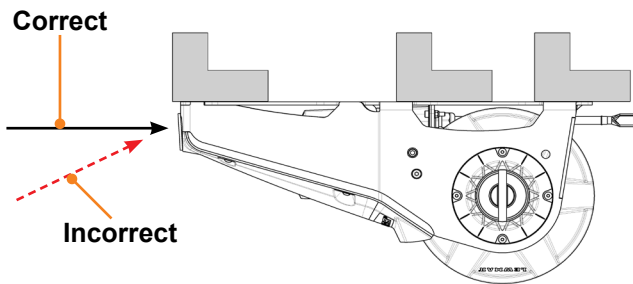

Fig.7

6. Fasten the winch chassis to the aluminum beam using two of the included M8 (5/16") bolts in the two aft most holes (Fig. 8A).

7. Install the remaining four bolts based on the layout of the remaining beams. It is recommended that two bolts are placed symmetrically near the fore end of the chassis (Fig. 8B) and two are placed symmetrically near the middle (Fig. 8C).

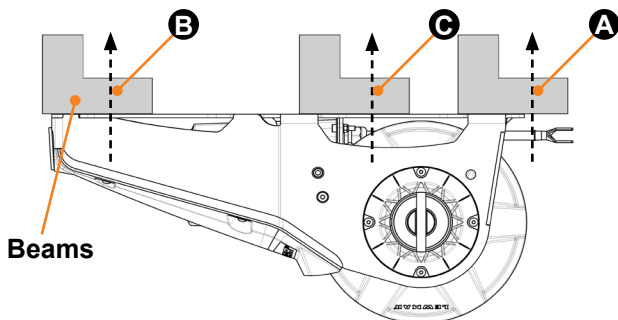

Fig.8

8. Fasten the bow roller to the aluminum beams the six button head fasteners included with the winch. Use two screws at the aft end (Fig. 9A) and two at the fore end (Fig. 9B) of the bow roller. Optionally, if a third beam aligns with a set of holes in the middle of the bow roller (Fig. 9C), it may be fastened for extra security.

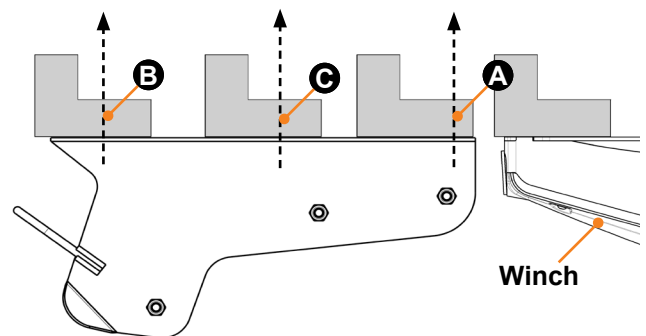

Fig.9

### Installing the Control Box

The control box should be installed in a dry compartment above deck to a solid surface.

**NOTE:** Do not connect or power-on the control box during installation.

Remove the control box lid by turning the plastic screws counter clockwise using a flat head screwdriver.

Locate the elongated fixing wings at each corner of the box. Mark holes through the wings to the mounting surface.

Use 4x #6 (9/64") screws to fasten the box in place.

Replace the box lid and gently tighten the plastic screws to form a good seal.

**NOTE:** Do not interfere with the internal electrical circuitry of the box. Doing so will void product warranty.

### Installing the switch

The operating switch should be installed in a suitable deck location where the operator has a clear view of the anchor payout when operating the winch via the switch to ensure no snags or tangles impede operation. Operator also needs a clear view of the anchor for proper stowing during retrieval.

## Venta™ Pontoon Anchor Winch Installation and Owner's Manual (For Aftermarket Applications)

**NOTE:** Printer settings may vary. To ensure the printed template is accurate, measure the diameter of the holes when printed. The diameter should be 70mm (~2 3/4"). It is recommended to also verify the template against the actual switch prior to starting installation.

1. Print or remove the Switch Mounting Template page included in this manual and place it on the deck where there is sufficient space and no underlying equipment or wiring will be damaged by installation. Once satisfied with switch position, tape the template to the intended mounting location using painter's tape.

2. Using an electric drill and 5.5mm (7/32") drill bit, drill holes at the three marked locations on the switch template (Fig. 13A).

3. Using a 70mm (2 3/4") drill or hole saw, cut two holes where indicated by the template for either side of the switch (Fig. 13B).

4. Use a jigsaw to connect the two 70mm (~2 3/4") holes into one hole following the template (Fig. 13C).

5. De-burr and sand any rough edges.

6. Place the switch in the hole to test its fit, adjusting as needed.

7. Install the switch to the deck using the provided M5 nuts and bolts. Do not over tighten.

8. Wire the switch to the controller using the included 5m (16') harness.

**NOTE:** Do not loosen any existing screws on the deck switch.

### Installing the Anchor

**NOTE:** Controller and switch must be fully installed and wired before installing an anchor.

1. Firmly hold the winch chain, and release it from the winch by cutting the transit cable tie.

**NOTE:** Make sure you have a firm grip before cutting the tie to prevent the chain from sliding back into the winch.

**NOTE:** Only once the winch and bow roller is installed and the anchor is on-hand should the chain be released from the winch by cutting the transit cable tie.

2. Run the chain over the top of the bow roller.

3. Place the anchor inside the bow roller and connect it

to the chain using a suitable shackle or swivel.

4. Installation is complete.

**NOTE:** If there is not sufficient chain to connect to the anchor, more chain will need to be released from the winch. Refer to the "Releasing Additional Chain From the Winch for Anchor Installation" section in this manual.

### Releasing Additional Chain From the Winch for Anchor Installation

ONLY Follow these steps if more chain is needed to install the anchor. Keep in mind the winch will need to be fully wired to the switch, control box, and power supply before performing this procedure.

#### **WARNING**

**DO NOT TOUCH CHAIN OR MOVING PARTS. DO NOT PLACE HANDS NEAR THE ANCHORING EQUIPMENT DURING OPERATION.**

#### **WARNING**

**UNLESS THERE IS NOT SUFFICIENT CHAIN TO REACH THE ANCHOR, DO NOT ATTEMPT TO POWER ON OR OPERATE THE WINCH UNTIL THE BOW ROLLER AND ANCHOR ARE INSTALLED TO COMPLETE THE ANCHOR SYSTEM.**

1. Check that all fasteners are tight before operating the winch.

2. Make sure all persons are clear of the winch, and maintain a safe distance until anchor is properly attached to the chain.

3. Switch on the boat's battery or power supply.

4. Open both protective lids of the deck switch. Use a quick pulse on the "Down" button to verify the spooling direction is correct and wiring is correct.

5. If wiring and spooling is correct, release the required amount of chain needed to reach the anchor.

6. Cover the switch buttons with their respective lids.

7. Turn the power off and disconnect the isolator before approaching the anchor and chain.

8. Place the anchor inside the bow roller and connect it to the chain using a suitable shackle or swivel.

9. Installation is complete.

## Venta™ Pontoon Anchor Winch Installation and Owner's Manual (For Aftermarket Applications)

### Wiring

#### ⚠ WARNING

COMPLY WITH ALL LOCAL WIRING AND ELECTRICAL SAFETY REGULATIONS. WHEN UNSURE, ALWAYS SEEK GUIDANCE FROM A QUALIFIED MARINE ELECTRICIAN.

#### General Wiring

The winch must be connected to a suitable 12V DC power supply.

The power source must be suitably sized for the expected duration of winch use.

The wiring system should be fully insulated to avoid possible electrolytic corrosion. It is recommended to use type III stranded, tinned copper wire with copper crimp terminals. Most modern installations are negative return (negative ground) but polarity should be checked.

The winch is supplied with a 5m (16') harness to allow through-deck connection to the control box. The control box should be installed in an enclosed, dry area above deck.

#### Electric Cable Selection

Cable connecting the winch control box to the power supply must be customer supplied. Note the total cable length needed ((Fig. 10A) plus (Fig. 10B) in wiring diagram) prior to choosing cable and refer to the Appropriate Cable Gauge/Size by Cable Length table to determine the gauge of wire needed. Longer runs will require cable with a smaller gauge.

**NOTE:** Winch performance is directly related to cable size and length. Voltage drop over the complete wiring run must not exceed 10%.

### Power Specifications

Motor Supply	Motor Power	Zero-Load Current Draw	Current Draw While Hoisting Tackle	Current Draw While at Maximum Pull	Maximum Draw in Stall Condition
12 Volts	850 Watts	40A	65A	100A	447A

#### ⚠ NOTICE

ALL ELECTRICAL WIRING HARNESSSES SHALL BE LOOMED AND SECURED TO PREVENT POSSIBLE DAMAGE AND INSTALLED IN ACCORDANCE WITH ABYC (AMERICAN BOAT AND YACHT COUNCIL) ELECTRICAL STANDARDS [E11 AND S31](#).

#### Appropriate Cable Gauge/Size by Cable Length

Up to 14 m	Up to 40 ft	15-24 m	41-66 ft
16mm <sup>2</sup>	4 AWG	25mm <sup>2</sup>	2 AWG

#### ⚠ CAUTION

DO NOT CONFUSE CABLE LENGTH WITH THE LENGTH OF THE VESSEL.

#### Circuit Protection

The winch is supplied with a circuit breaker for overload protection. This must be installed between the power source (battery) and the winch control box on the positive cable. The button on the breaker will pop out when an overload occurs. Depress the button to reset the breaker. It may need time to cool to allow reset. Do not hold button in to attempt to override.

Installation **MUST** use the supplied circuit breaker to protect the wiring between the power source and the winch control box. Refer to local standards for exceptions and restrictions.

**DO NOT** remove circuit breaker from unit or otherwise bypass.

#### Disconnect Isolator

The installation requires a customer-supplied power disconnect isolator switch between the power source (battery) and the provided circuit breaker. The isolator switch should be appropriately sized to safely handle both the current draw at maximum pull and the momentary current draw in a stall condition.

The isolator is to be used to switch off the winch system for safety when it is not in use.

See the Power Specifications table in this manual for assistance in determining a proper isolator.

### Wiring Diagram

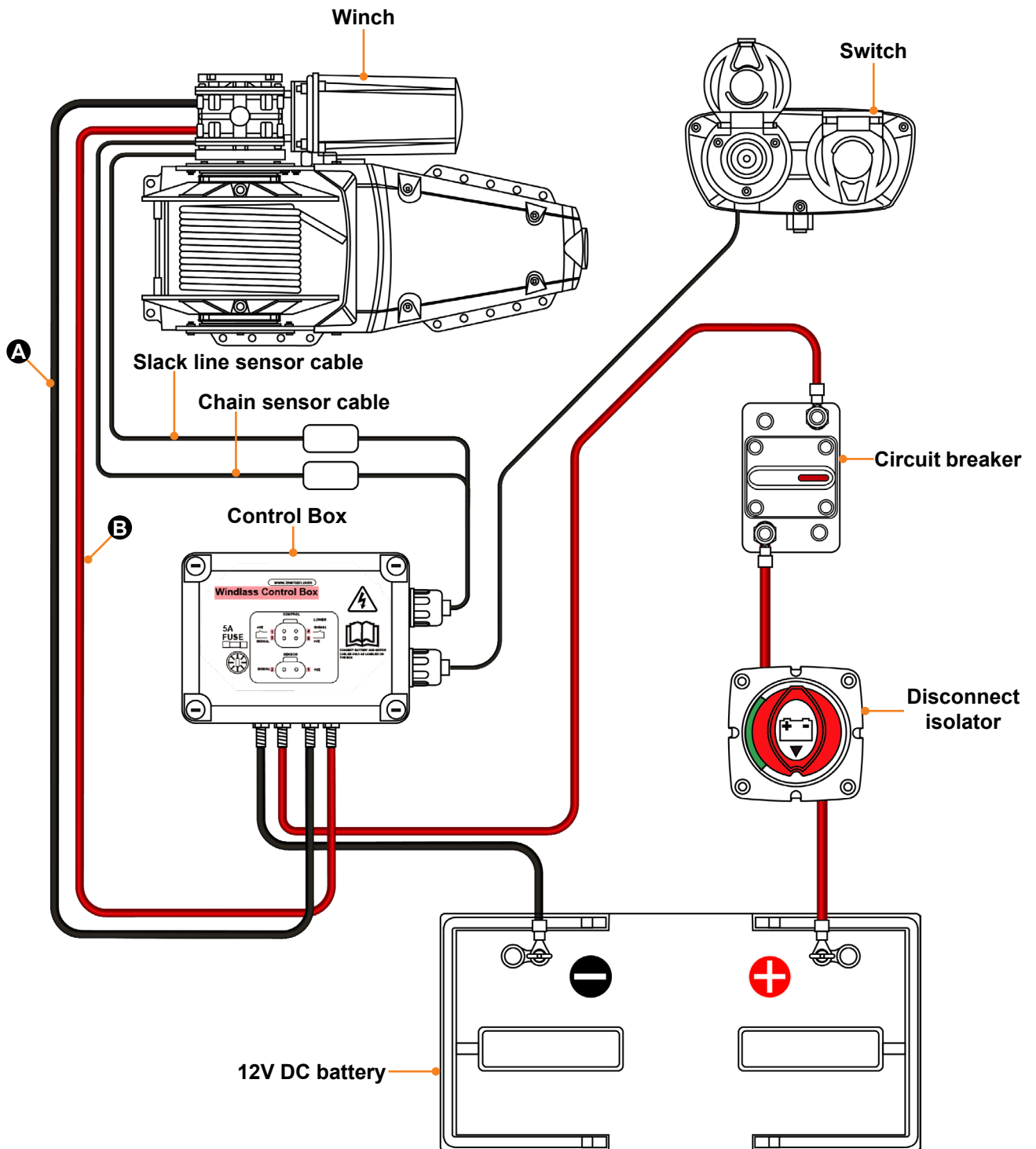

Fig.10

## Venta™ Pontoon Anchor Winch Installation and Owner's Manual (For Aftermarket Applications)

### Operation

#### Prior to Operation

The winch includes a slack line sensor that prevents the rope jamming or entangling during deployment. The winch will stop paying out if it senses slack in the line. If this occurs during operation, either gently power the boat astern or wait for tidal forces to take up the slack so that the winch continues paying out.

The winch features 'a bitter end sensor' which automatically prevents deployment of the final 2m (6ft) of anchor rope. This ensures that a few turns of rope always remain on the drum for safety purposes, and prevents the spool from deploying too much rope and reverse winding. When enough rope is deployed to trigger the bitter end sensor, winding will stop and the sensor will override the "Down" button.

The "Auto Pulse" feature automatically pulses the anchor when the shank is 100mm away from entering the bow roller. This provides the anchor adequate time to settle and right itself and protects the winch from shock loads as the anchor homes against the bow roller. The winch senses the incoming chain and enters pulse mode while the anchor is homing. Once the anchor is homed, the pulses continue until the foot switch is released. The "Auto Pulse" feature will remain in place until a set number of pulses have completed or the "down" button is pressed.

Both the bitter end sensor and Auto Pulse feature serve to protect equipment and reduce noise. Exercise good anchoring practice and pay careful attention to equipment and surroundings when using the winch.

Before operating the winch, check that retrieval of the anchor will not foul or entangle other vessels or objects in the water.

### ⚠ WARNING

**KEEP LIMBS, DIGITS, CLOTHING, AND HAIR CLEAR OF WINDLESS, RODE, AND ANCHOR DURING OPERATION. SEVERE BODILY HARM COULD RESULT.**

### ⚠ WARNING

**NEVER DROP THE ANCHOR WHEN SWIMMERS OR DIVERS ARE PRESENT.**

### ⚠ WARNING

**DO NOT HOLD THE CHAIN, RODE, OR ANCHOR WHEN WINCH IS IN USE.**

#### Dropping the Anchor

1. Check that power is turned on and that the circuit breaker is not tripped. (Push the button on the breaker to reset it if it's tripped.)
2. Flip open the protective lid with the downward-facing arrow on the deck switch (Fig. 11A). Hold the revealed "Down" button to drop the anchor (Fig. 11B).

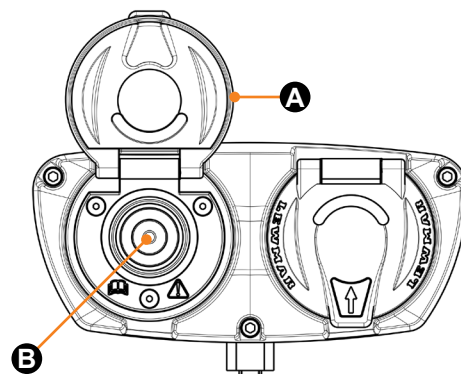

Fig.11

3. Release button when the desired length of rode has been deployed. The bitter end sensor will automatically stop the winch if all the available rope has been deployed.
4. If the winch stops operating prematurely, there is slack in the system. Gently power the boat astern or wait for tidal forces to take up the slack so that the winch continues paying out.
5. Close the protective lid of deck switch.

### Raising the Anchor

#### **CAUTION**

**ALWAYS WATCH THE ANCHOR STOWING ONTO THE BOW ROLLER**

**NOTE:** When retrieving the anchor, avoid overloading or stalling the winch.

1. Check that power is turned on and that the circuit breaker is not tripped. (Push the button on the breaker to reset it if it's tripped.)
2. Flip open the protective lid with the upward-facing arrow on the deck switch (Fig. 12A). Hold the revealed "Up" button to retrieve the rode and anchor (Fig. 12B).

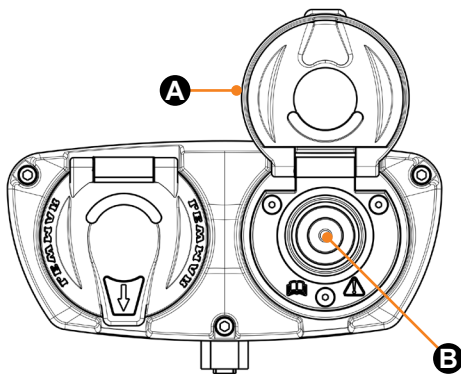

Fig.12

### Maintenance

The service period is determined by the frequency of use. Frequent users will need to carry out maintenance more often than weekend or casual users.

#### **CAUTION**

**BEFORE PERFORMING ANY MAINTENANCE OR SERVICE, ISOLATE THE WINCH FROM THE POWER SOURCE VIA THE CIRCUIT BREAKER/ISOLATOR.**

1. Check that the winch chassis mounting bolts are tight, and tighten if required.
2. Use light machine oil sparingly to lubricate moving parts including drum bearings and slack line sensor pivot.
3. Examine all electrical connections to make sure they are sound and corrosion hasn't set in. Tighten and/or protect connections if needed.

3. To aid recovery, slowly and safely power the vessel at idle speed towards the anchor but not over and beyond as this can risk entanglement and damage to topsides.
4. Once the boat is above the anchor, it should easily break out from the bed of water using the winch. If the anchor is set deeply, do not overload the winch in attempt to break it out; instead use the engine and boat movement. Be aware of underwater obstacles, debris and other boat's mooring lines which may pose an entanglement hazard.
5. Continue retrieving the anchor and rode by pressing the "Up" button. As the chain passes through the bow roller and into the windlass, Auto Pulse mode will be triggered and the retrieval speed will slow. When the anchor homes onto the bow roller it will come to a stop. Release the "Up" button when this happens.
6. Close the protective lid of the deck switch.

4. Check rode and rode entry guide for wear, and replace either if severely worn.
5. Check main chassis case for damage, and replace if needed.
6. Check the motor gearbox plastic cover for any impact damage or cracks.
7. If any screws need to be re-engineered, use a medium strength thread locker such as Loctite® 243.

### Troubleshooting

What is happening?	Why?	What should be done?
Anchor will not deploy or return when buttons are pressed.	Circuit breaker is tripped	Let breaker cool, then rest by pressing button on breaker.
	Motor not engaging	Check wiring connections. If voltage is reaching the motor wires when the DOWN button is pressed, the motor must be replaced.
Anchor stops deploying mid-payout	Winch sensor not triggered	Gently power the boat astern or wait for tidal forces to take up the slack so that the winch continues paying out under load.
Rode is becoming tangled	Rode is tangled or snagged	Check for debris or that rode is not caught on the chassis of the winch, or knotted in the drum. Remove any debris and free any snags.
	Improper rope used in unit	Only use approved Lewmar rope.
Rode is backwound	Switch/button pressed for too long during deployment	Press the "Up" button for 5 seconds to unspool the chain past the red section of rope and rewind it.
Auto Pulse mode isn't engaging	Electronic logic malfunction	Press the "Down" button until 2m (6ft) of rope/chain is deployed. Wait 30 seconds, then try retrieval.
	Chain sensor not triggered	Check chain clasp for signs of damage and replace if necessary. Check chain rope guide module (with integral sensor) for damage and replace if necessary. Any replacement of the clasp should only be performed with the boat secured by means other than the winch and with the winch isolated from the power source via the circuit breaker / isolator.
Auto Pulse mode engages too early	Chain Sensor clasp is too far away from anchor	Move clasp 2 links at a time towards anchor until pulsing starts 50mm / 2inches before entering bow roller.
Auto Pulse mode engages too late	Chain Sensor Clasp is too close to anchor	Move clasp 2 links at a time away from anchor until pulsing starts 50mm / 2 inches before entering bow roller.
Bitter end sensor isn't engaging	Bitter end rope clasp damaged	Trailer and secure the boat (or remove the winch from the boat for service) and remove the chute cover to access the rope clasp. Check that the clasp is intact and clamped onto the rope 6ft from the bitter end. Replace clasp if needed.

# Limited Warranty and Key Terms of Supply by Lewmar

Lewmar warrants that in normal private pleasure boat usage and with proper maintenance its products will conform with their specification for a period of three years from the date of purchase by the end user, subject to the conditions, limitations and exceptions listed below. Any product, which proves to be defective in normal usage during that three-year period, will be repaired or, at Lewmar's option, replaced by Lewmar.

## A CONDITIONS AND LIMITATIONS

- i** Lewmar's liability shall be limited to the repair or replacement of any parts of the product which are defective in materials or workmanship.
- ii** Responsibility for the selection of products appropriate for the use intended by the Buyer shall rest solely with the Buyer and Lewmar accepts no responsibility for any such selection.
- iii** Lewmar shall not be liable in any way for Product failure, or any resulting loss or damage that arises from:
  - a.** use of a product in an application for which it was not designed or intended;
  - b.** corrosion, ultra violet degradation or wear and tear;
  - c.** a failure to service or maintain the product in accordance with Lewmar's recommendations;
  - d.** faulty or deficient installation of the product (unless conducted by Lewmar);
  - e.** any modification or alteration of the product;
  - f.** conditions that exceed the product's performance specifications or safe working loads.
  - g.** Abuse
- iv** Product subject to a warranty claim must be returned to the Lewmar outlet that supplied the product for examination unless otherwise approved by Lewmar in writing.
- v** This warranty does not cover any incidental costs incurred for the investigation, removal, carriage, transport or installation of product.
- vi** Service by anyone other than authorized Lewmar representatives shall void this warranty unless it accords with Lewmar guidelines and standards of workmanship.

- vii** Lewmar's products are intended for use only in the marine environment. Buyers intending to use them for any other purpose should seek independent professional advice as to their suitability. Lewmar accepts no liability arising from such other use.

## B EXCEPTIONS

Cover under this Warranty is limited to a period of one year from the date of purchase by the end user in the case of any of the following products or parts of products:

- Electric motors and associated electrical equipment
- Electronic controls
- Hydraulic pumps, valves and actuators
- Hatch & Portlight weather seals
- Products used in "Grand Prix" racing applications
- Products used in commercial or charter applications
- Anchor rode

## C LIABILITY

- i** Lewmar's liability under this warranty shall be to the exclusion of all other warranties or liabilities (to the extent permitted by law). In particular (but without limitation):
  - a.** Lewmar shall not be liable for:
    - Any loss of anticipated turnover or profit or indirect, consequential or economic loss;
    - Damages, costs or expenses payable to any third party;
    - Any damage to yachts or equipment;
    - Death or personal Injury (unless caused by Lewmar's negligence).Some states and countries do not allow the exclusion or limitation of incidental or consequential damages, so the above limitation or exclusion may not apply to you.
  - b.** Lewmar grants no other warranties regarding the fitness for purpose, use, nature or satisfactory quality of the products.
- ii** Where applicable law does not permit a statutory or implied warranty to be excluded, then such warranty, if permitted by that state or country's law, shall be limited to a period of one year from the date of purchase by the end user. Some states and countries do not allow limitations on how long an implied warranty lasts, so this limitation may not apply to you.

## D PROCEDURE

Notice of a claim for service under this warranty shall be made promptly and in writing by the end user to the Lewmar outlet that supplied the product or to Lewmar Limited, Southmoor Lane, Havant, Hampshire PO9 1EX, England.

## E SEVERANCE CLAUSE

If any clause of this warranty is held by a court or other competent authority to be invalid or unenforceable in whole or in part, the validity of the remaining clauses of this warranty shall not be affected.

## F OTHER RIGHTS

This warranty gives you specific legal rights and you may also have other legal rights, which vary from state to state and country to country. In the case of European States a consumer customer (as defined nationally) has legal rights under the applicable national law governing the sale of Consumer Goods; this Warranty does not affect those rights.

## G LAW

This warranty shall be governed by and interpreted in accordance with the laws of England or state or country in which the first end user is domiciled at the time of purchase of the product.

## H DISPUTES

Any dispute arising under this warranty may, at the option of the end-user, be referred to alternative dispute resolution under the rules of the British Marine Federation or to the Courts of the State whose law shall govern the warranty or to the Courts of England and Wales.

The British Marine Federation may be contacted at:

Marine House  
Thorpe Lee road,  
Egham,  
England  
TW20 8BF

### Switch Mounting Template

**NOTE:** Printer settings may vary. To ensure the printed template is accurate, measure the diameter of the holes when printed. The diameter should be 70mm (~2 3/4"). It is recommended to also verify the template against the actual switch prior to starting installation.

1. Print this page or tear it out of the manual. Tape it using painters tape to the intended mounting location where the switch will be installed.
2. Using an electric drill and 5.5mm (7/32") drill bit, drill holes at the three marked locations on the template (Fig. 13A).
3. Using a 70mm (2 3/4") drill or hole saw, cut two holes where indicated by the template for either side of the switch (Fig. 13B).
4. Use a jigsaw to connect the two 70mm (~2 3/4") holes into one hole following the lines on the template (Fig. 13C).

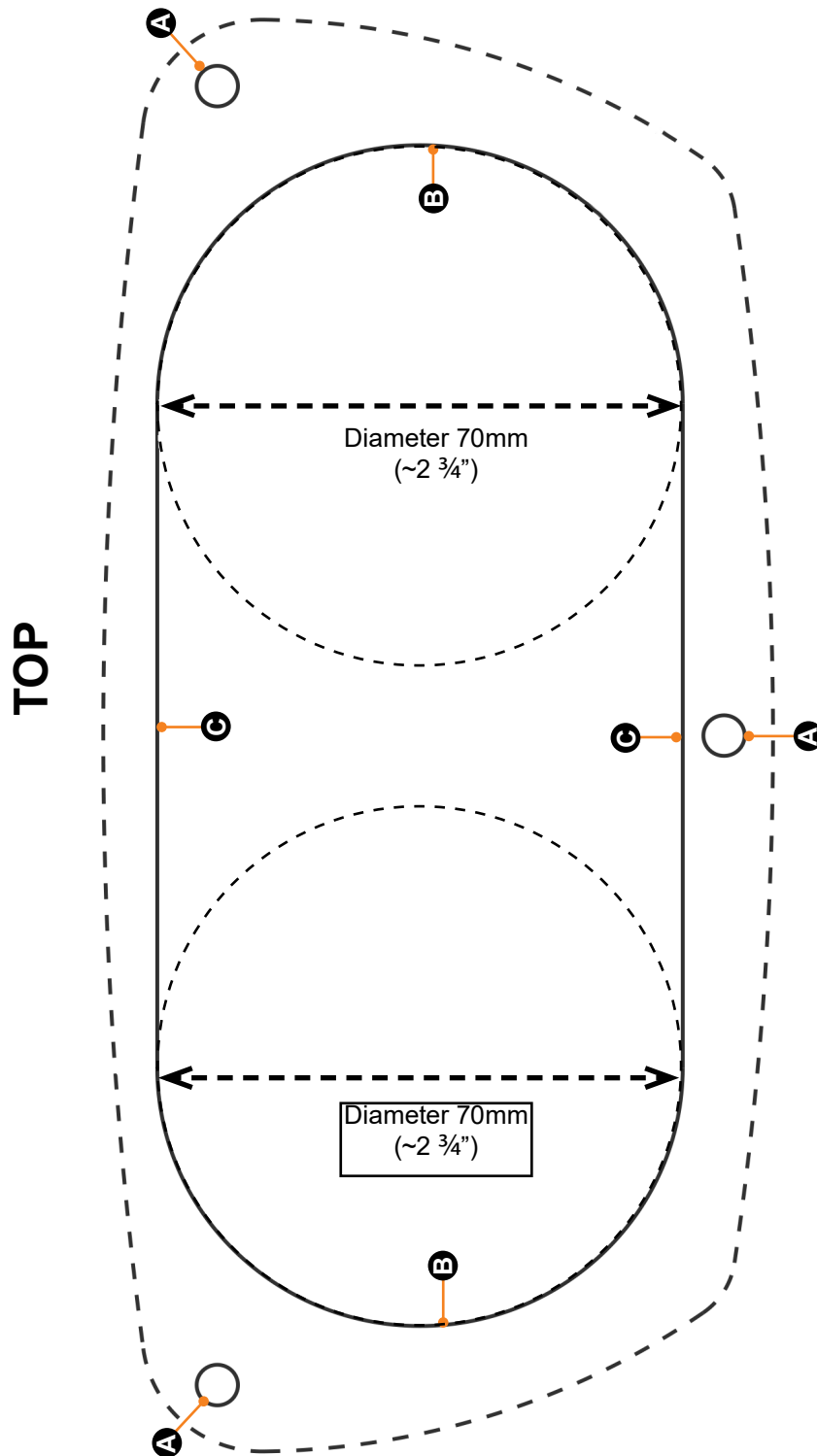

Fig.13

# LEWMAR®

## Venta™ Pontoon Anchor Winch Installation and Owner's Manual (For Aftermarket Applications)



**MARINE GROUP EUROPE**

**LEWMAR®**



For Product Support contact:

**Lewmar Havant Plant No. 404**

Southmoor Lane  
Havant  
P09 1JJ  
United Kingdom

T: +44 (0) 23 9247 1841

[Email: techsupport@lewmar.com](mailto:techsupport@lewmar.com)

The contents of this manual are proprietary and copyright protected by Lippert. Lippert prohibits the copying or dissemination of portions of this manual unless prior written consent from an authorized Lippert representative has been provided. Any unauthorized use shall void any applicable warranty. The information contained in this manual is subject to change without notice and at the sole discretion of Lippert. Revised editions are available for free download from [lippert.com](http://lippert.com).

Please recycle all obsolete materials.