

CATEGORY A,B WELDING JOINT
NOT TO SCALE

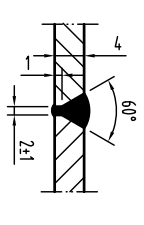

NOZZLE WELDING JOINT
NOT TO SCALE

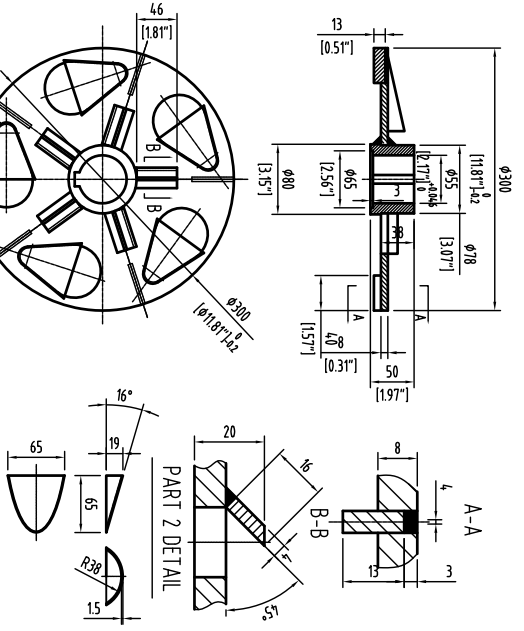
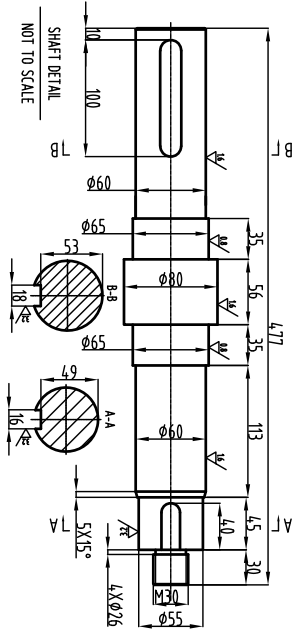
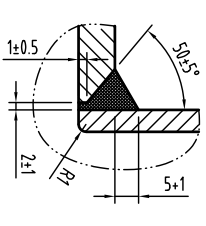

MATERIAL SCHEDULE

ITEM	QTY.	SIZE/THICK	MATERIAL	DESCRIPTION
1	4	φ76x6	SS 304	LEG
2	1	4mm (9 GA)	SS 316L	CONE
3	1	4mm (9 GA)	SS 316L	SHELL
4	1	4mm (9 GA)	SS 316L	HEAD

NOZZLE SCHEDULE

ITEM	QTY	MATERIAL	SIZE	DESCRIPTION
N1	1	316L SS	2" YAB	MANWAY
N2	1	316L SS	2.5" TC	OUTLET
N3	2	316L SS	2" TC	INLET
N4	1	316L SS	1.5" TC	CP
N5	1	316L SS	2" TC	Vent

STANDARD INFORMATION & NOTES

DESIGN PRESSURE & TEMP.	NA
HYDRO TEST AT AMBIENT.	NA
WORKING TEMPERATURE.	NA
SHOP TOLERANCE.	+1/8"
TOTAL CAPACITY.	≈582 USG
APPROX. EMPTY WEIGHT.	≈650 KG
FINISH:	INTERIOR: 316L S.S. SURFACES - #4 SANITARY FINISH (3A STANDARD-R4 RANGE 23-32) WELDS - GROUND SMOOTH & FLUSH TO #4 SANITARY FINISH (3A STANDARD-R4 RANGE 23-32) EXTERIOR: 304 S.S. SURFACES - #4 SANITARY FINISH WELDS: STRIPE BUFFED W/ DISCOLORATION REMOVED PASSIVATION REQ'D: NA

3									
2									
1									
REV. NO.	REV.	DESCRIPTION	DATE	DESIGNED BY	DATE	PROJECT NUMBER	DRAWING NO.	500 gallon 316LSS	
PREPARED BY	DESIGNED BY	APPROVED BY	SCALE	LIQUIFIER LK500	GENERAL DRAWING	DATE	REV. 1	TOTAL 1	PAGE 1
<p>陕西宏达实业有限公司 SHAANXI HONGDA INDUSTRY CO., LTD</p>									