

PRIMINER

VERTICAL MACHINING CENTERS

PRECISE · DYNAMIC · RELIABLE

Top price/performance ratio

High-quality components

Numerous options

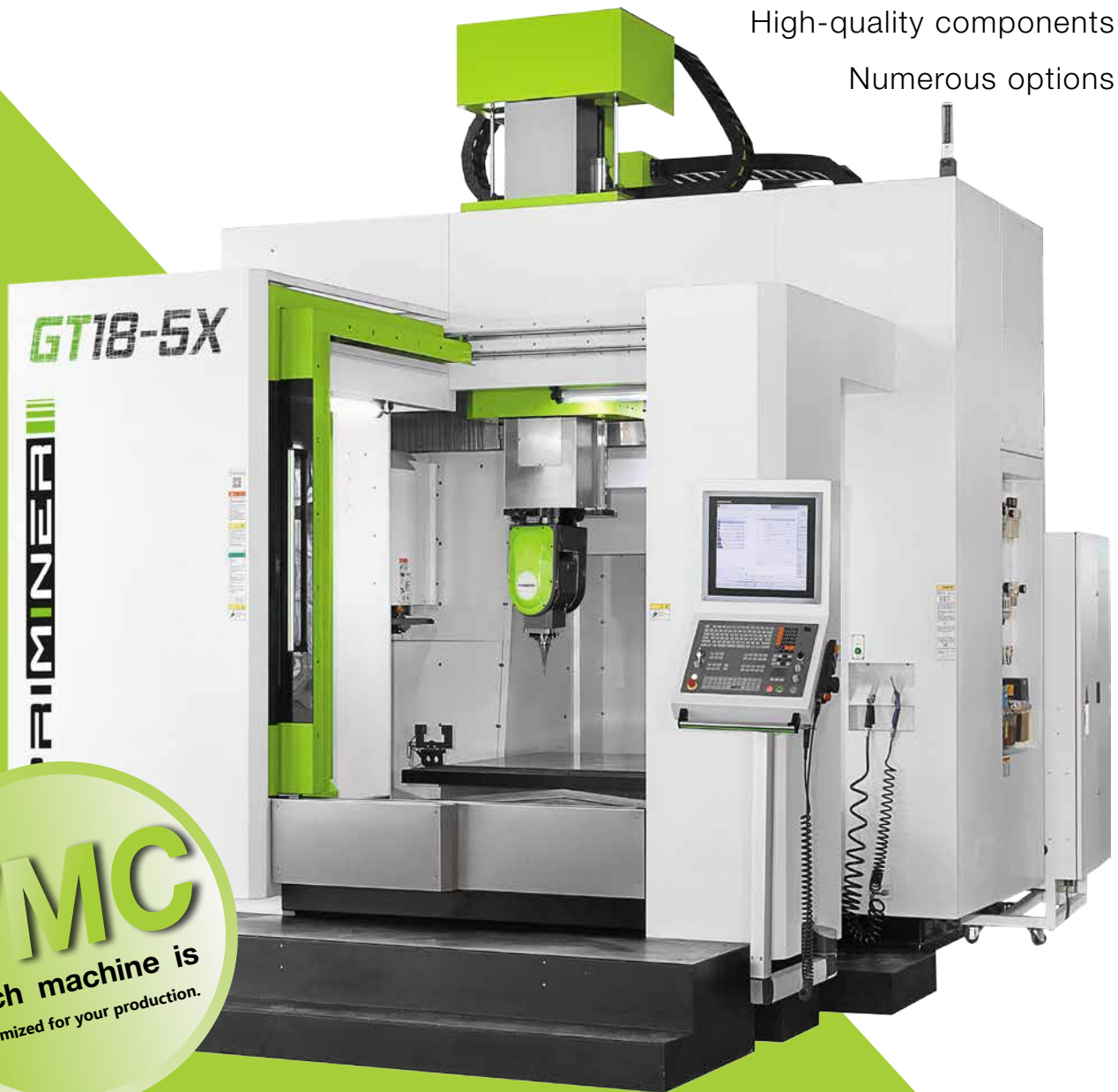

VMC
Each machine is
customized for your production.





PRIMINER

The Company



Jack Chen | CEO Priminer Company Group
Benjamin Kaehlcke | General Manager, Germany



PRIMINER

PRIMINER

PRIMINER



We stay up to date

“Only employees which are regular trained and involved in the development of our production process can understand the requirements of present and future as a whole.” According to Mr. Kaehlcke GF of Priminer Germany. “This is the case for our German and China team members. We have an intensive exchange program between our two major spots, additional to our permanent training course at our global leading sub-suppliers.”





HOW WE DO IT

Consequent QC-management according to international norms, a highly motivated team of specialists, advantages of serial production and reliable top sub-suppliers with global leading positions are columns of our success. An open and result-oriented company culture through all levels is the basement for a permanent high level of our reliability and products.



Our Team

International, competent, highly motivated and always open for new ideas... This is our team. The cooperate culture is a mirror of these attitudes. Our management has got a "open ear" from bottom to top and we are and we practise flat hierarchy.

PRIMIN

PRIMINER



ER Global TEAM

Double Column Center V2015 · V3320 · V4028

- Extra wide column to increase to connection surface with the crossbeam to avoid vibration during cutting.
- Roller type linear guideway, which offers super high rigidity and loading capacity
- Hydraulic balancing system on Z axis



| Technical Specifications | | V2015 | V3320 | V4028 |
|--|---------|------------------------|--------------------------|---------------------------|
| Table | | | | |
| Table size | mm | 2100×1200 | 3300×1700 | 4000×2400 |
| T-slot (width x number x distance) | mm | 22×7×150 | 22×9×180 | 28×11×200 |
| Max. load | kg | 4000 | 10000 | 12000 |
| Travel | | | | |
| X/Y/Z Travel | mm | 2000/1500/800 | 3300/2700/1000 | 4200/3300/1200 |
| Spindle nose to table | mm | 170-970 | 200-1200 | 300-1500 |
| Distance between columns | mm | 1500 | 2000 | 2800 |
| Spindle | | | | |
| Spindle speed | rpm | BT50, 6000 rpm | | |
| Power/torque(SIEMENS) | kW / Nm | 22/60 kW, 172/380 Nm | | |
| Power/torque(FANUC) | kW / Nm | 15/18.5 kW, 143/259 Nm | 22/45 kW, 140/286 Nm | |
| Spindle speed(optional, only available on SIEMENS) | rpm | / | HSK A100, 12000 rpm | |
| Power/torque | kW / Nm | / | 20/22.5 kW, 298/346 Nm | |
| Feed | | | | |
| Rapid feed X/Y/Z | m/min | 15/15/12 | 24/24/30 | 20 |
| Cutting speed | mm/min | 1-12000 | | |
| Accuracy (VDI3441 Full travel) | | | | |
| Positioning accuracy (without linear scales) | mm | 0.015 | 0.020/0.020/0.015(X/Y/Z) | 0.0250/0.020/0.015(X/Y/Z) |
| Positioning repeatability (without linear scales) | mm | 0.012 | 0.015/0.015/0.010(X/Y/Z) | 0.020/0.015/0.010(X/Y/Z) |
| Positioning accuracy (with linear scales) | mm | 0.015 | 0.015/0.015/0.010(X/Y/Z) | 0.020/0.015/0.010(X/Y/Z) |
| Positioning repeatability (with linear scales) | mm | 0.008 | 0.010/0.010/0.006(X/Y/Z) | 0.015/0.010/0.006(X/Y/Z) |
| Dimensions & Weight | | | | |
| Dimensions | mm | 7090×4120×4250 | 10000×5700×5400 | 10500×6200×5850 |
| Weight | kg | 19000 | 30000 | 52000 |

* The above specifications are subject to change without prior notice, no liability for mistakes. Machines may be shown with optional equipment.



Hydraulic balancing system in Z axis



Chip conveyor



Standard configuration:

- ✓ Half enclosed splash guard
- ✓ Air-conditioned electrical cabinet
- ✓ Rigid tapping
- ✓ Chip conveyor (two screw type and one chain type)
- ✓ Ethernet, CF card and USB interface
- ✓ Automatic lubrication system
- ✓ Coolant system
- ✓ Spindle oil cooler
- ✓ LED working lamp
- ✓ End of program light
- ✓ Electronic handwheel (MPG)
- ✓ Tool box
- ✓ Leveling bolts and blots
- ✓ Coolant gun
- ✓ Air gun
- ✓ User Manual

Optional configuration:

- Built-in type spindle 12000RPM, HSK A100 (V3320, V4028, only available on SIEMENS)
- 24 pockets arm tool changer (Only available on V2015)
- 40 pockets chain type tool changer
- CTS coolant through spindle + ATS
- Gearbox
- Linear scales (V3320, V4028)

* The above specifications are subject to change without prior notice, no liability for mistakes. Machines may be shown with optional equipment.

Measurements control during the production

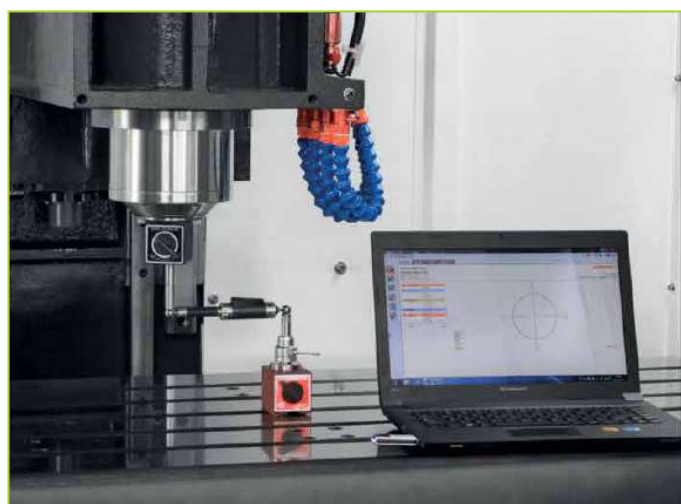

Spindle unit final unbalancing inspection

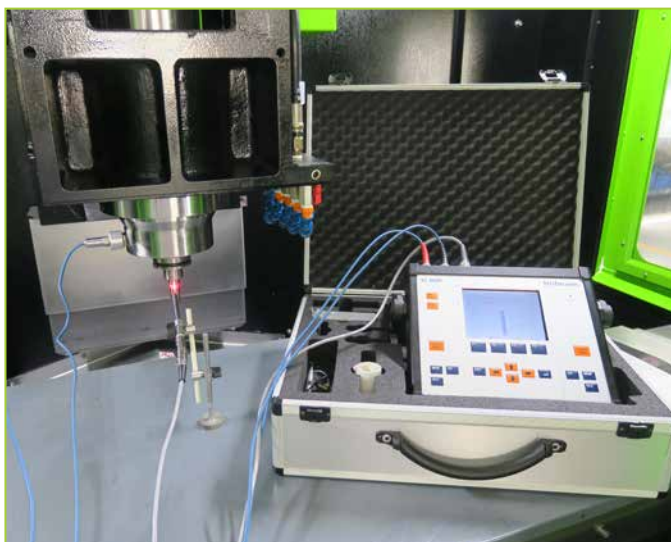

Hand scraping

pl LEHMANN®



Swiss Rotary Table Technology

High speed

- ✓ Up to 210rpm
- ✓ up to 0.21 sec / 90°

More space

- ✓ Extended travel in Z- and X-direction

Heavy duty

- ✓ High spindle load, heavy-duty bearing

High torque

- ✓ Feed torque up to 850 Nm

Adaptability

- ✓ Multifunctional spindle HSK

Precision

- ✓ On the workpiece, as precise as 2µm / 100 mm

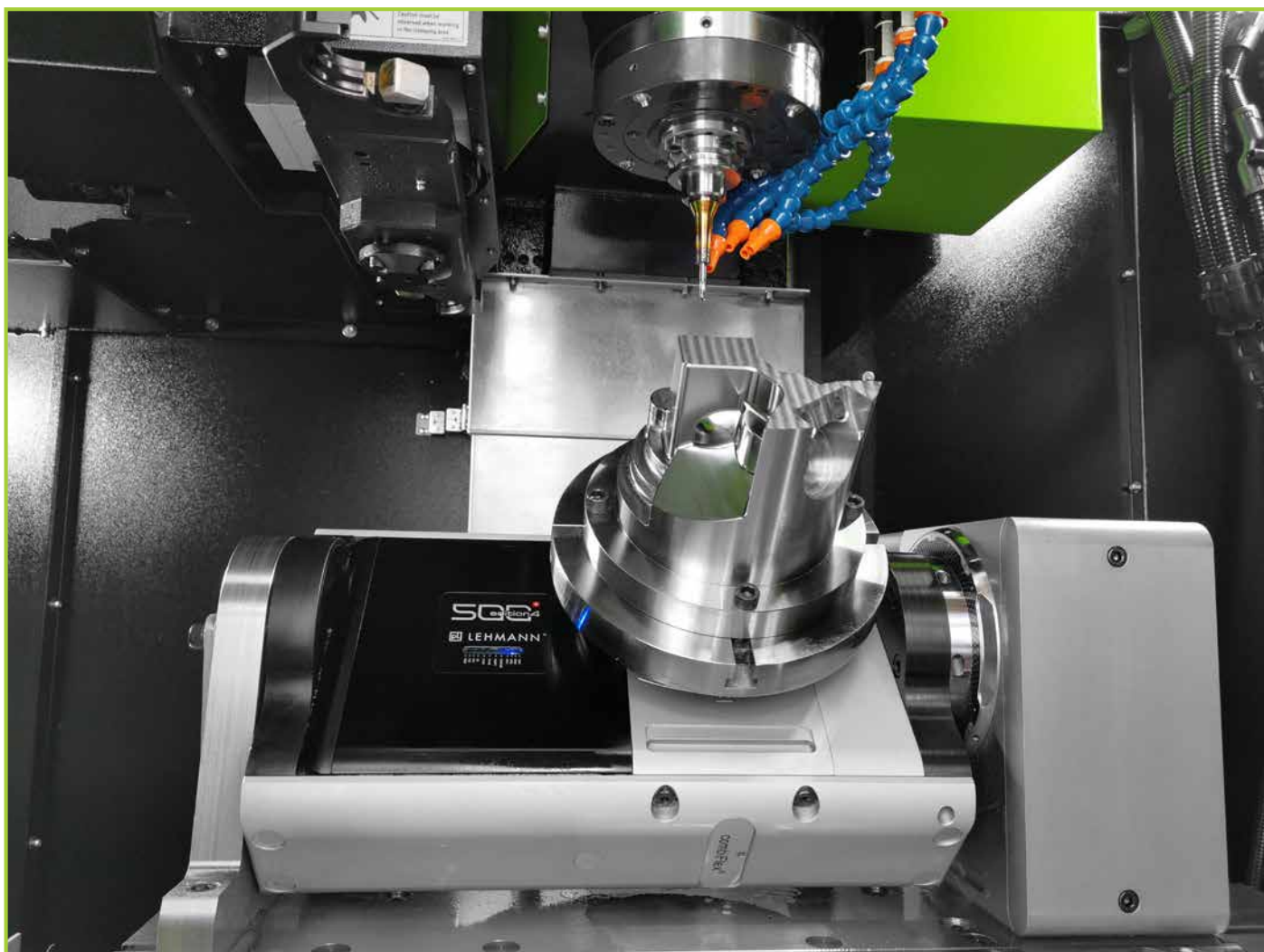

* The above specifications are subject to change without prior notice, no liability for mistakes. Machines may be shown with optional equipment.



SIEMENS



HEIDENHAIN



FANUC



FAGOR

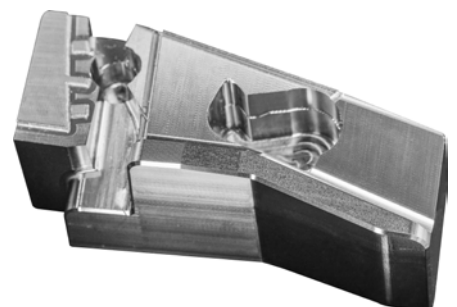
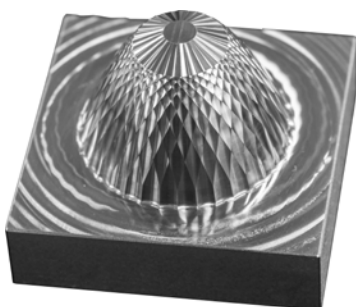
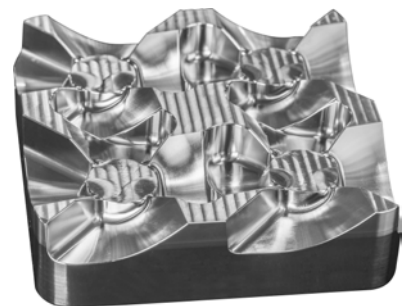
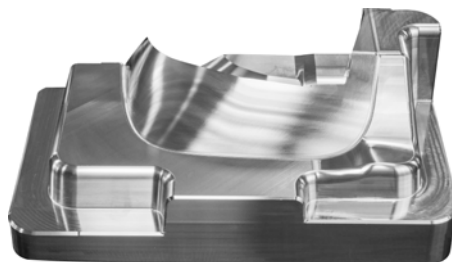
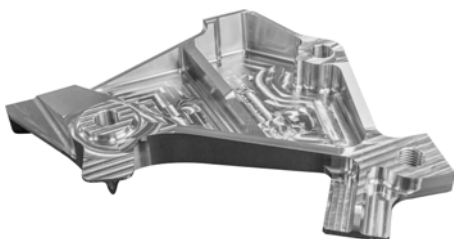
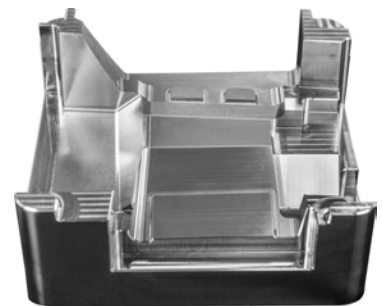
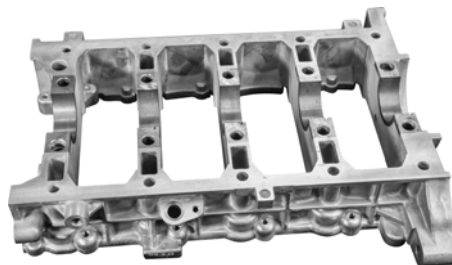
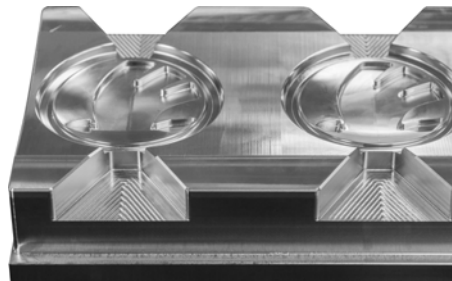



hyperMILL
SolidCAM
The Leaders in Integrated CAM



DIJET NS TOOL
GÜHRING



LEHMANN



MST



SCHUNK



Blaser.
SWISSLUBE



REGO-FIX



BLUM
focus on productivity



Workpiece measuring by CMM

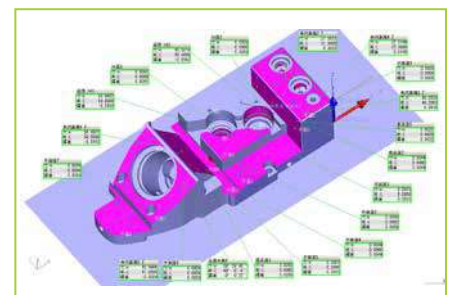
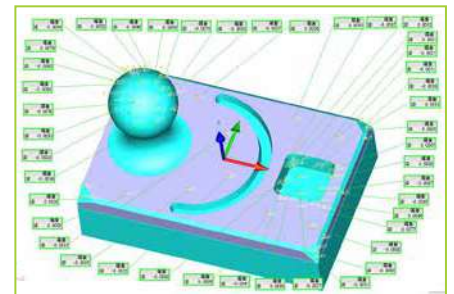
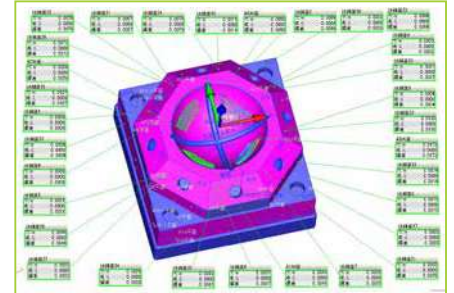
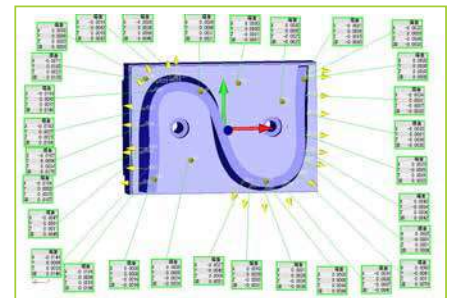

The above specifications are subject to change without prior notice, no liability for mistakes. Machines may be shown with optional equipment.

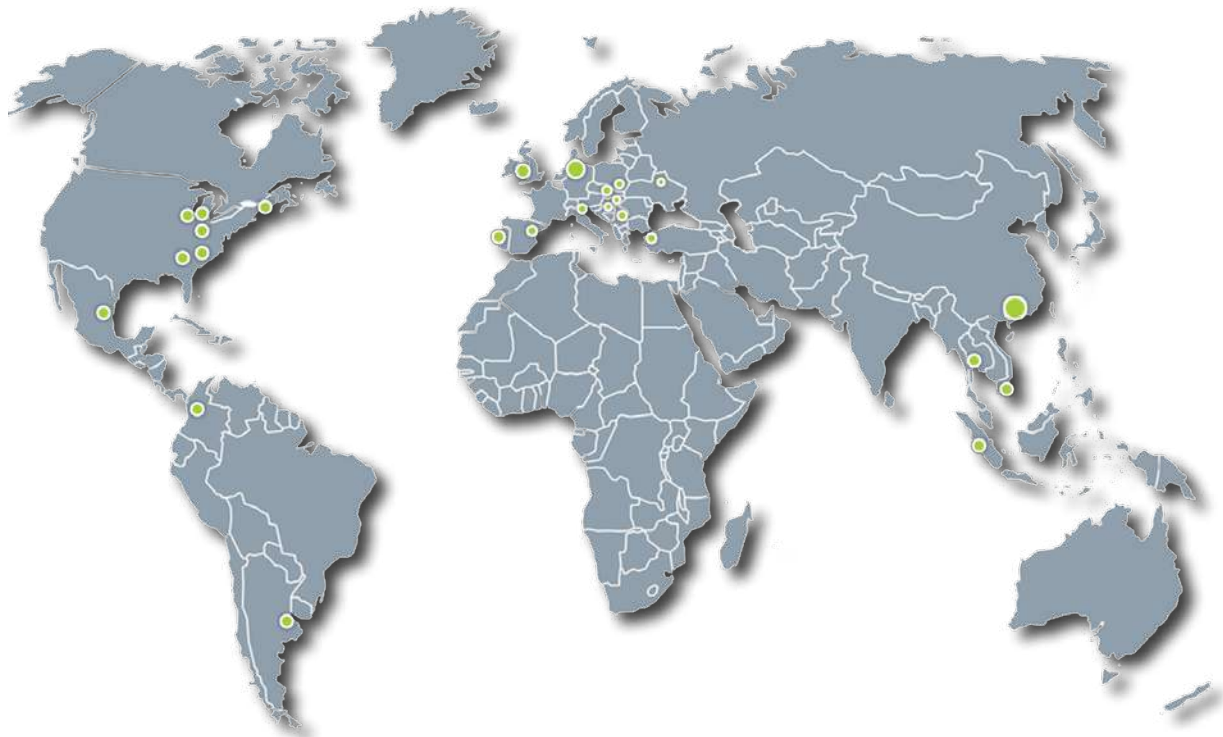

PRIMINER Werkzeugmaschinen GmbH

Gadelander Str. 172 · D-24539 Neumünster / Germany

Tel: +49 (0) 4321-53 9946-0

Fax: +49 (0) 4321-25 20 03-90

E-mail: info@priminer.de

PRIMINER SOUTH EAST EUROPE · PRIMINER d.o.o. BEOGRAD

Vladimira Popovica 38-40 · GTC - 11070 Beograd / Srbija

Tel: +381 69 702 705

Fax: +381 11 715 69 00

E-mail: office@priminer.de

PRIMINER RUSSLAND LLC

Building 3, 29, Staroye Yaskino Str., 143002 Odintsovo, Moscow Region, Russia.

Tel : +7 (495) 120-20-98

Website: www.priminer.ru

E-mail: info@priminer.ru

PRIMINER MACHINE TOOLS DONGGUAN CO., LTD

XinRuYi Industrial Park, Fuxing Road, Xingguang Village, Huangjiang Town, Dongguan, P.R.China

Tel: +86 769 838 490 61

Fax: +86 769 838 490 62

E-mail: sales@priminer.de

www.priminer.de