

PRIMINER

VERTICAL MACHINING CENTERS

PRECISE · DYNAMIC · RELIABLE

Top price/performance ratio

High-quality components

Numerous options

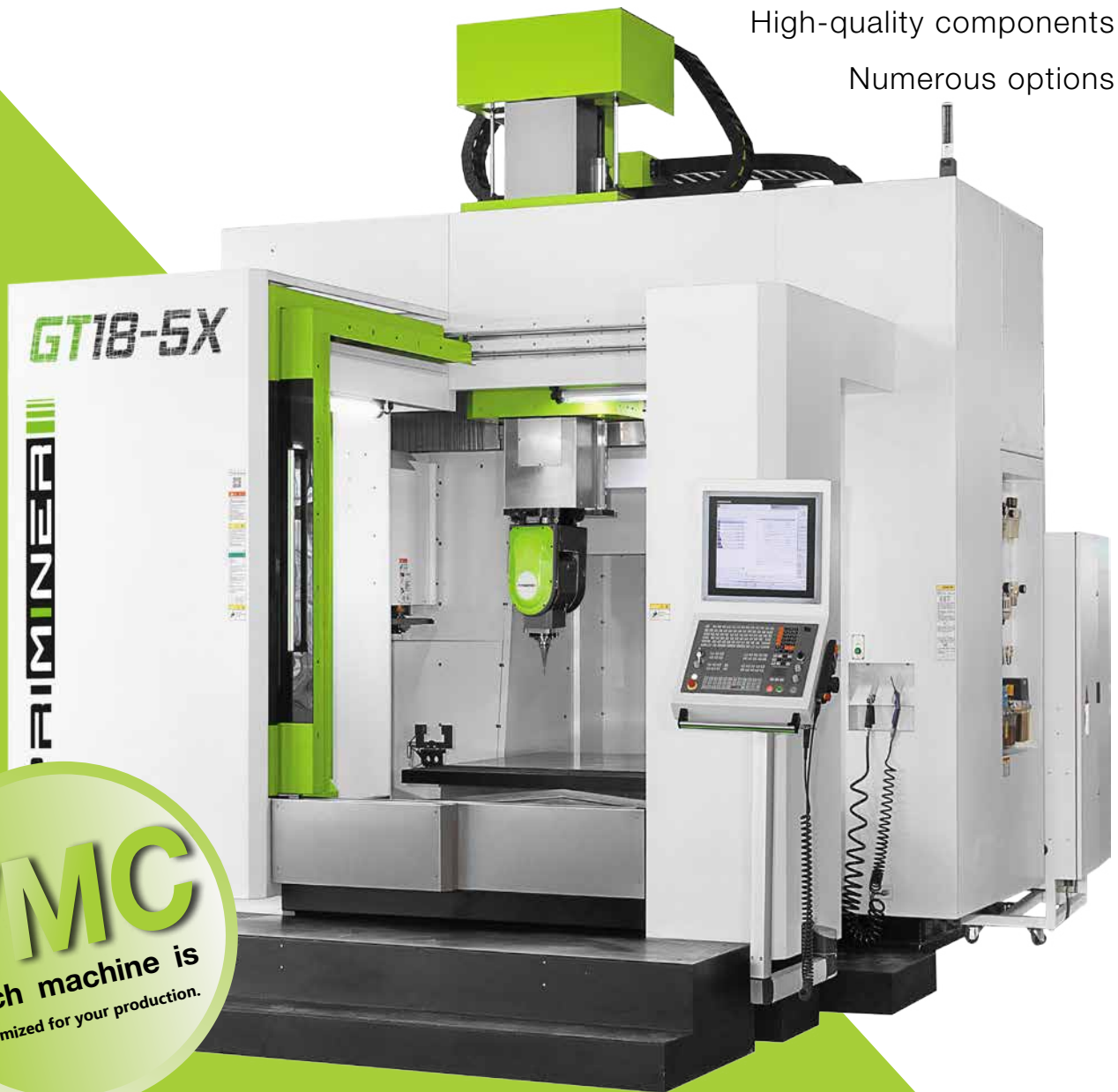

VMC
Each machine is
customized for your production.





PRIMINER

The Company



Jack Chen | CEO Priminer Company Group
Benjamin Kaehlcke | General Manager, Germany



PRIMINER

PRIMINER

PRIMINER



We stay up to date

“Only employees which are regular trained and involved in the development of our production process can understand the requirements of present and future as a whole.” According to Mr. Kaehlcke GF of Priminer Germany. “This is the case for our German and China team members. We have an intensive exchange program between our two major spots, additional to our permanent training course at our global leading sub-suppliers.”





HOW WE DO IT

Consequent QC-management according to international norms, a highly motivated team of specialists, advantages of serial production and reliable top sub-suppliers with global leading positions are columns of our success. An open and result-oriented company culture through all levels is the basement for a permanent high level of our reliability and products.



Our Team

International, competent, highly motivated and always open for new ideas... This is our team. The cooperate culture is a mirror of these attitudes. Our management has got a "open ear" from bottom to top and we are and we practise flat hierarchy.

PRIMIN

PRIMINER



ER Global TEAM

The background of the entire page is a photograph of a CNC machine. At the top, a white sign with black and red text shows a 3D coordinate system with axes labeled +X, -X, +Y, -Y, +Z, and -Z. A blue flexible cable is connected to the machine, and a small orange and blue tool is visible at the bottom right. The machine itself is dark grey and black.

OUR KNOW-HOW FOR YOUR BUSINESS

Technology & Know-how

We think and plan the future already now. A growing in-house R&D department with experienced engineers which develop our machine concepts are our warrantor that we are prepared for the upcoming trends of the machine tools business. We are listening to the market. Flexibility in the matter of CNC controllers is for us a must, here we only go with the market leaders. Without any compromise!

Alpha Center V7L



Technical Specifications		Alpha Center V7L
Table		
Table size	mm	900 x 420
T-slot (width x number x distance)	mm	14 x 3 x 125
Max. load	kg	500
Travel		
X/Y/Z Travel	mm	760 / 450 / 520
Spindle nose to table	mm	100 - 620
Spindle center to column	mm	517
Spindle		
Spindle taper	-	SK 40 / BT 40 / CAT 40
Spindle speed	rpm	10000
Spindle motor power/torque	-	9/22kW; 63/135Nm(SIEMENS) 7.5/15kW; 35.8/95.5Nm(FANUC)
Feed		
Rapid feed X/Y/Z	m/min	48
Cutting speed	mm/min	1-12000
Tool changer		
Number of tools	pcs	24
Max. tool length	mm	300
Max. tool diameter	mm	Φ78 / Φ125
Max. tool weight	kg	8
Accuracy (VDI 3441 Full travel)		
Positioning accuracy	mm	0.008
Positioning repeatability	mm	0.006
Dimensions & Weight		
Dimensions	mm	3250x2710x2900
Weight	kg	4500



Standard configuration:

- ✓ Fully enclosed splash guard
- ✓ Belt drive spindle 10000 rpm
- ✓ 24 pockets arm tool changer
- ✓ Chain type chip conveyor
- ✓ Air-conditioned electrical cabinet
- ✓ Rigid tapping
- ✓ Ethernet CF card and USB interface
- ✓ Automatic lubrication system
- ✓ Coolant system
- ✓ LED working lamp
- ✓ End of program light
- ✓ Electronic handwheel (MPG)
- ✓ Tool box
- ✓ Leveling bolts and blocks
- ✓ Coolant gun
- ✓ Air gun
- ✓ Chip flushing system
- ✓ User Manual

Optional configuration:

- Direct drive spindle 12000 rpm
- Spindle oil cooler
- CTS Coolant through spindle + ATS
- Oil skimmer
- Workpiece probe
- Tool probe
- 4th axis
- 4/5th axis

Measurements control during the production

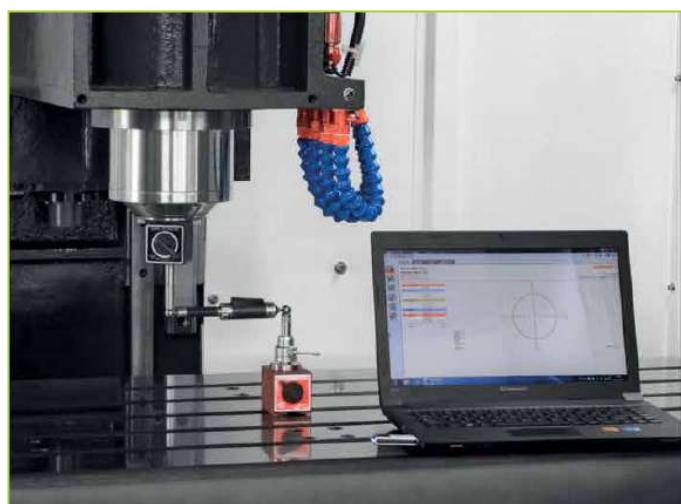

Spindle unit final unbalancing inspection

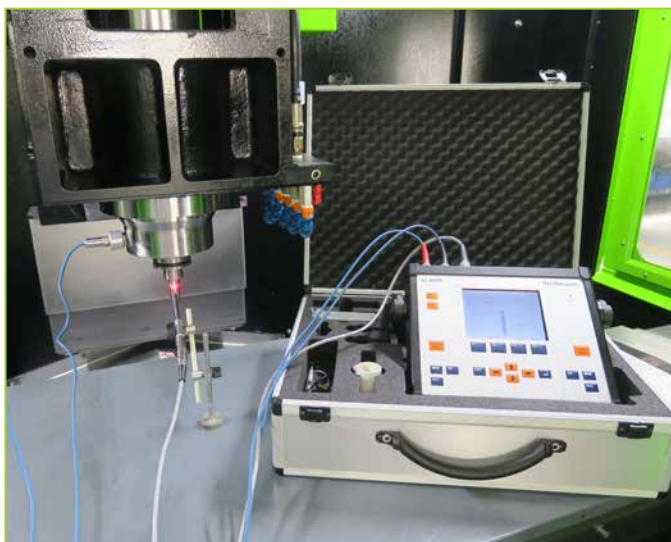

Hand scraping



pl LEHMANN®



Swiss Rotary Table Technology

High speed

- ✓ Up to 210rpm
- ✓ up to 0.21 sec / 90°

More space

- ✓ Extended travel in Z- and X-direction

Heavy duty

- ✓ High spindle load, heavy-duty bearing

High torque

- ✓ Feed torque up to 850 Nm

Adaptability

- ✓ Multifunctional spindle HSK

Precision

- ✓ On the workpiece, as precise as 2µm / 100 mm

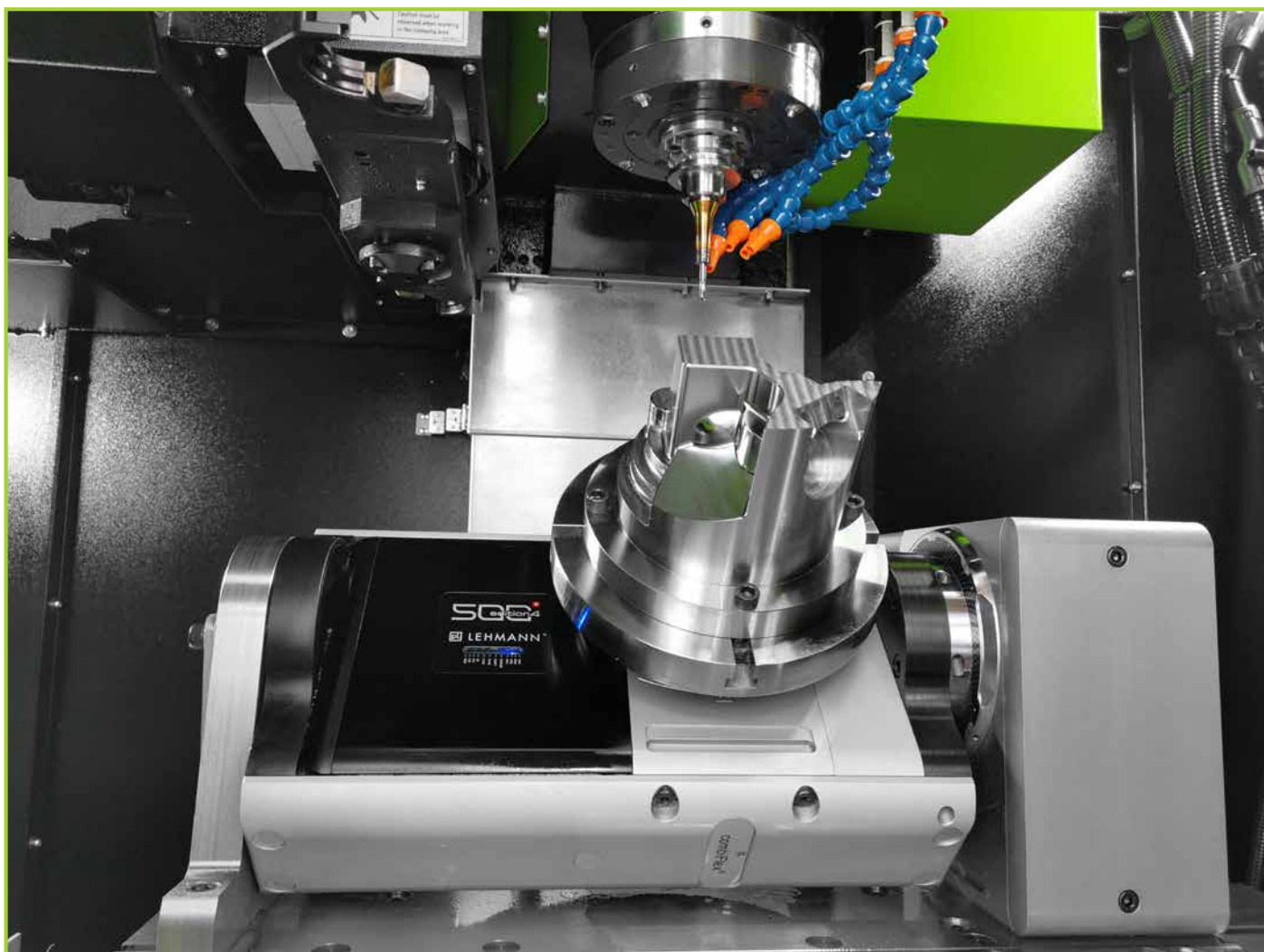

* The above specifications are subject to change without prior notice, no liability for mistakes. Machines may be shown with optional equipment.



SIEMENS



HEIDENHAIN



FANUC



FAGOR

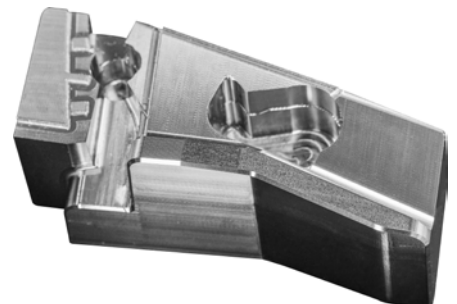
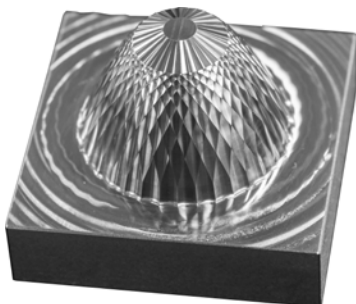
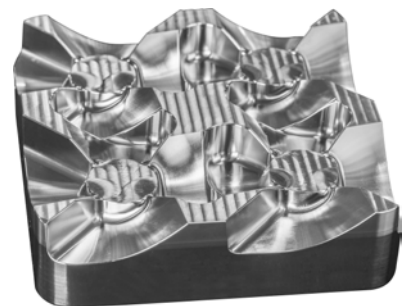
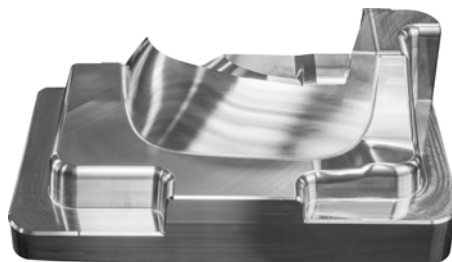
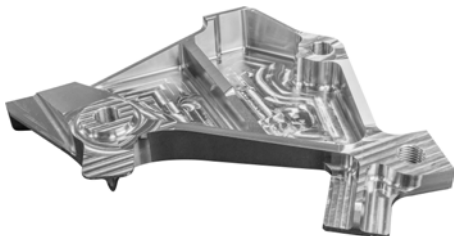
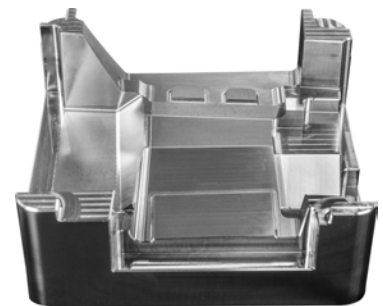
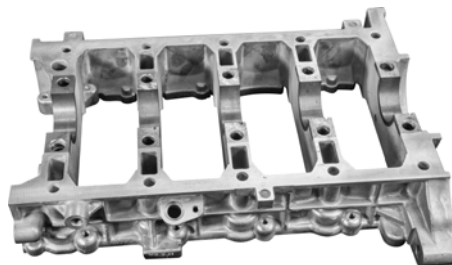
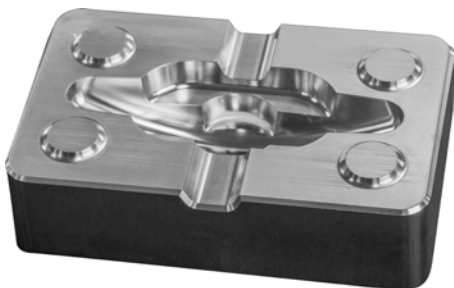
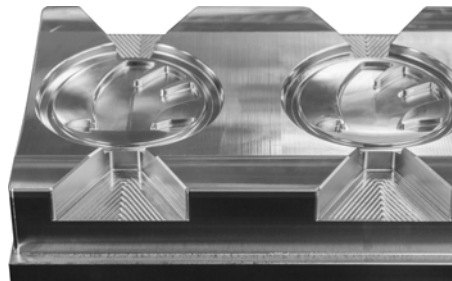



hyperMILL
SolidCAM
The Leaders in Integrated CAM



DIJET NS TOOL
GÜHRING



LEHMANN



MST



SCHUNK



Blaser.
SWISSLUBE



REGO-FIX



BLUM
focus on productivity



Workpiece measuring by CMM

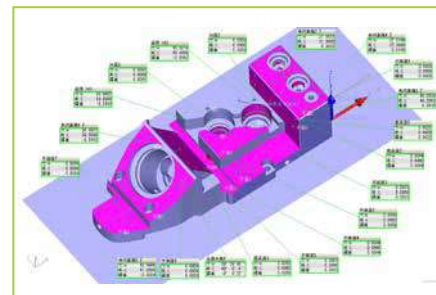
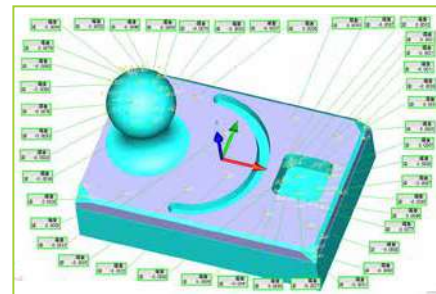
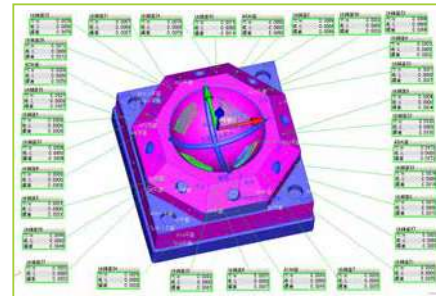
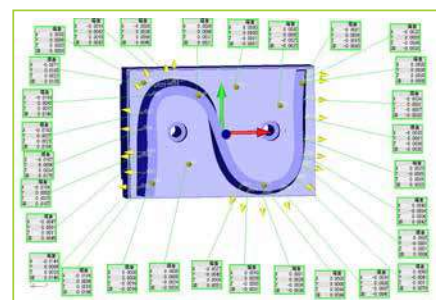

The above specifications are subject to change without prior notice, no liability for mistakes. Machines may be shown with optional equipment.

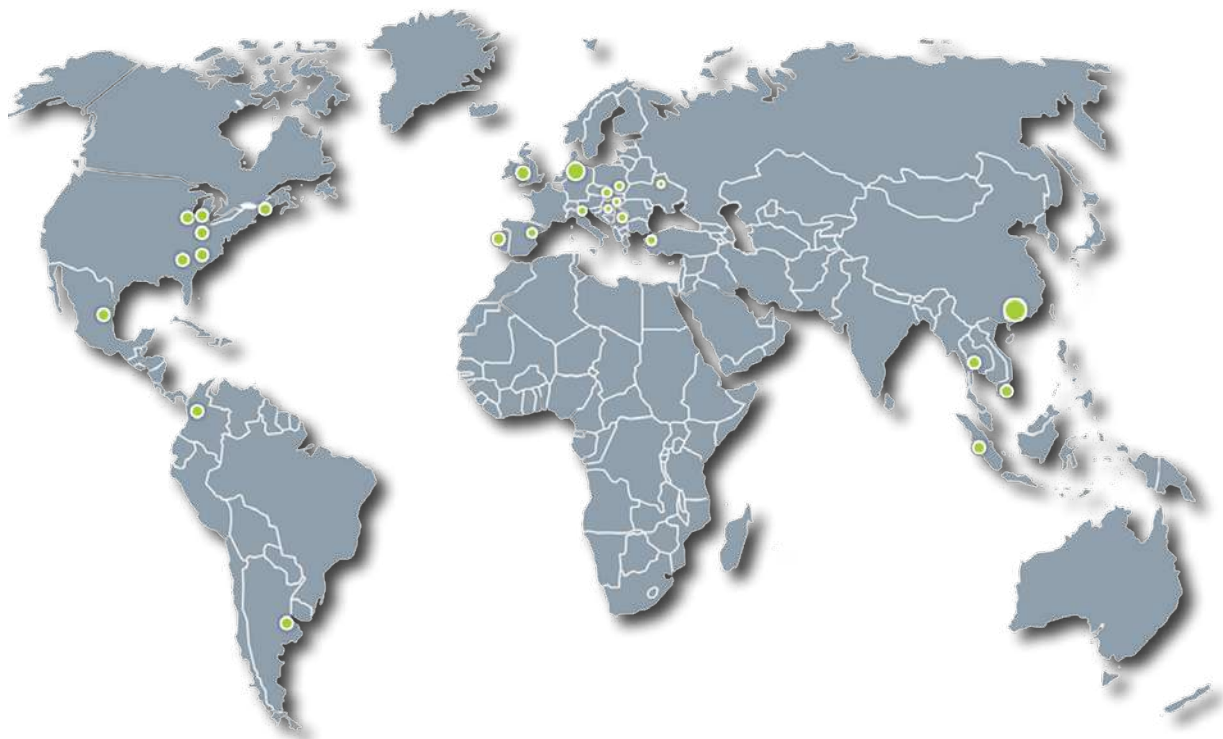

PRIMINER Werkzeugmaschinen GmbH

Gadelander Str. 172 · D-24539 Neumünster / Germany

Tel: +49 (0) 4321-53 9946-0

Fax: +49 (0) 4321-25 20 03-90

E-mail: info@priminer.de

PRIMINER SOUTH EAST EUROPE · PRIMINER d.o.o. BEOGRAD

Vladimira Popovica 38-40 · GTC - 11070 Beograd / Srbija

Tel: +381 69 702 705

Fax: +381 11 715 69 00

E-mail: office@priminer.de

PRIMINER RUSSLAND LLC

Building 3, 29, Staroye Yaskino Str., 143002 Odintsovo, Moscow Region, Russia.

Tel : +7 (495) 120-20-98

Website: www.priminer.ru

E-mail: info@priminer.ru

PRIMINER MACHINE TOOLS DONGGUAN CO., LTD

XinRuYi Industrial Park, Fuxing Road, Xingguang Village, Huangjiang Town, Dongguan, P.R.China

Tel: +86 769 838 490 61

Fax: +86 769 838 490 62

E-mail: sales@priminer.de

www.priminer.de