

PRIMINER

VERTICAL MACHINING CENTERS

PRECISE · DYNAMIC · RELIABLE

Top price/performance ratio

High-quality components

Numerous options

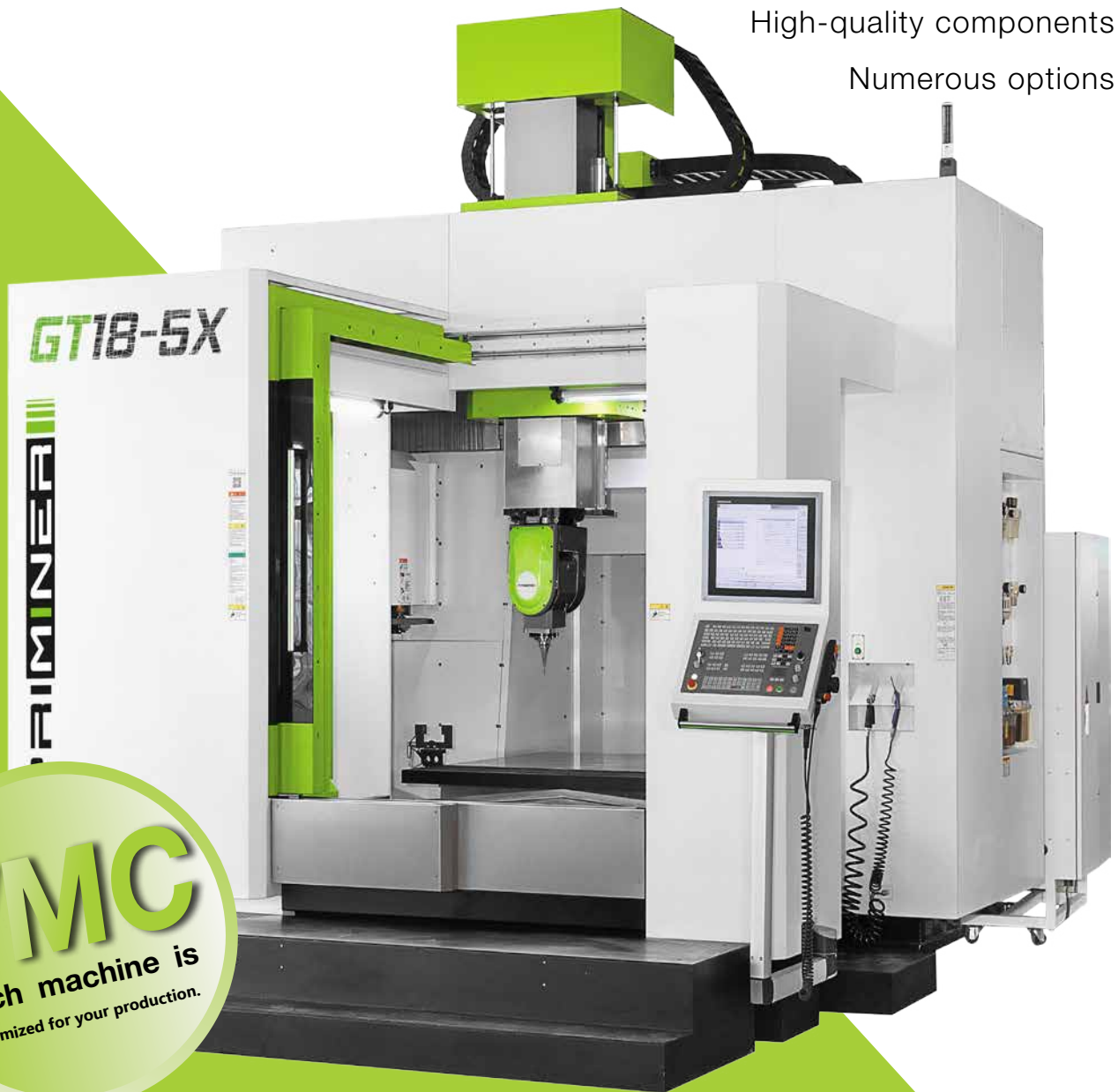

VMC
Each machine is
customized for your production.





PRIMINER

The Company



Jack Chen | CEO Priminer Company Group
Benjamin Kaehlcke | General Manager, Germany



PRIMINER

PRIMINER

PRIMINER



We stay up to date

“Only employees which are regular trained and involved in the development of our production process can understand the requirements of present and future as a whole.” According to Mr. Kaehlcke GF of Priminer Germany. “This is the case for our German and China team members. We have an intensive exchange program between our two major spots, additional to our permanent training course at our global leading sub-suppliers.”





HOW WE DO IT

Consequent QC-management according to international norms, a highly motivated team of specialists, advantages of serial production and reliable top sub-suppliers with global leading positions are columns of our success. An open and result-oriented company culture through all levels is the basement for a permanent high level of our reliability and products.



Our Team

International, competent, highly motivated and always open for new ideas... This is our team. The cooperate culture is a mirror of these attitudes. Our management has got a "open ear" from bottom to top and we are and we practise flat hierarchy.

PRIMIN

PRIMINER



ER Global TEAM

The background of the entire page is a photograph of a CNC machine. At the top center, there is a white square sign with a coordinate system diagram. The diagram shows a central point with six arrows pointing outwards: a black arrow pointing up labeled '+Z', a black arrow pointing down labeled '-Z', a black arrow pointing left labeled '+X', a black arrow pointing right labeled '-X', a red arrow pointing up and to the right labeled '-Y', and a red arrow pointing down and to the left labeled '+Y'. To the right of the sign, there is a green emergency stop button. In the lower half of the image, a blue flexible cable with an orange tip is connected to the machine. The machine itself is dark grey and has a small orange and blue tool holder at the bottom right. The overall lighting is dim, with some highlights on the machine's surfaces.

OUR KNOW-HOW FOR YOUR BUSINESS

Technology & Know-how

We think and plan the future already now. A growing in-house R&D department with experienced engineers which develop our machine concepts are our warrantor that we are prepared for the upcoming trends of the machine tools business. We are listening to the market. Flexibility in the matter of CNC controllers is for us a must, here we only go with the market leaders. Without any compromise!



Power Center V18

- Best choice for super heavy duty cutting with large workpiece
- X and Y axis with roller type linear guideways and Z axis with boxway guideways
- 50 taper spindle with belt drive 6000 rpm as standard, and optional with gearbox



- C3 class ballscrews ensures the highest accuracy and durability
- Pre-tension on all axis minimizes thermal distortion

Technical Specifications		Power Center V18
Table		
Table size	mm	2000 x 900
T-slot (width x number x distance)	mm	22 x 5 x 165
Max. load	kg	2000
Travel		
X / Y / Z Travel	mm	1800 / 900 / 600
Spindle nose to table	mm	110 - 710
Spindle center to column	mm	950
Spindle		
Spindle taper	-	SK 50 / BT 50 / CAT 50
Spindle motor power/torque	-	22/60kW; 172/380Nm(SIEMENS) 15/18.5kW; 143/259Nm(FANUC)
Spindle speed	rpm	6000
Feed		
Rapid speed X/Y/Z	m/min	20/20/15
Cutting speed	mm/min	1-12000
Tool changer		
Number of tools	pcs	24
Max. tool length	mm	400
Max. tool diameter	mm	Φ125 / Φ245
Max. tool weight	kg	15
Accuracy (VDI 3441 Full travel)		
Positioning accuracy	mm	0.016
Positioning repeatability	mm	0.010
Dimensions & Weight		
Dimensions	mm	6050×3270×3650
Weight	kg	17500

Standard configuration:

- ✓ Fully enclosed splash guard
- ✓ Belt drive spindle 6000 rpm
- ✓ 24 pockets arm tool changer
- ✓ Chip conveyor (2 screw type and 1 chain type)
- ✓ Air-conditioned electrical cabinet
- ✓ Rigid tapping
- ✓ Ethernet, CF card and USB interface
- ✓ Automatic lubrication system
- ✓ Coolant system
- ✓ LED working lamp
- ✓ End of program light
- ✓ Electronic handwheel (MPG)
- ✓ Tool box
- ✓ Leveling bolts and blocks
- ✓ Coolant gun
- ✓ Air gun
- ✓ Air blast during cutting
- ✓ User Manual

Optional configuration:

- Spindle oil cooler
- Gear box spindle 6000 rpm with transmission ratio 1:4
- Z axis travel 720 mm (spindle nose table 160-880 mm)
- CTS Coolant through spindle + ATS
- Oil skimmer
- Workpiece probe
- Tool probe
- 4th axis
- 4/5th axis

Measurements control during the production

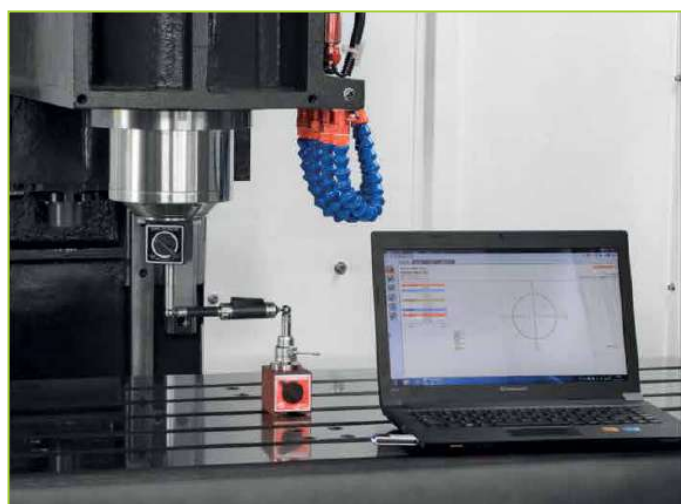

Spindle unit final unbalancing inspection

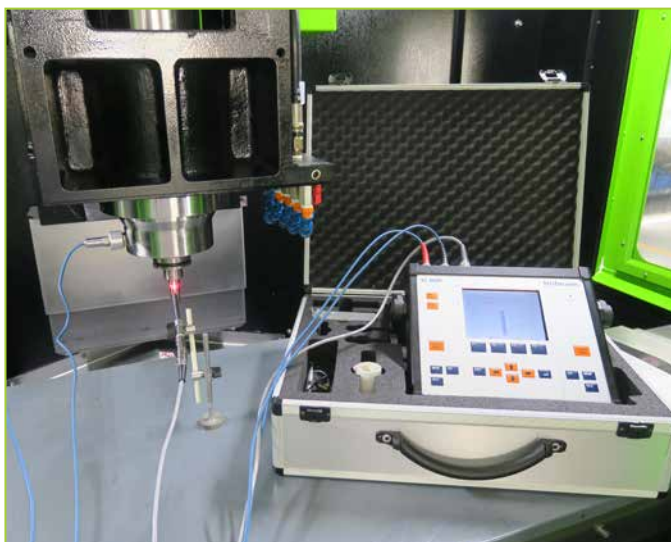

Hand scraping



pl LEHMANN®



Swiss Rotary Table Technology

High speed

- ✓ Up to 210rpm
- ✓ up to 0.21 sec / 90°

More space

- ✓ Extended travel in Z- and X-direction

Heavy duty

- ✓ High spindle load, heavy-duty bearing

High torque

- ✓ Feed torque up to 850 Nm

Adaptability

- ✓ Multifunctional spindle HSK

Precision

- ✓ On the workpiece, as precise as 2µm / 100 mm



* The above specifications are subject to change without prior notice, no liability for mistakes. Machines may be shown with optional equipment.



SIEMENS



HEIDENHAIN



FANUC



FAGOR

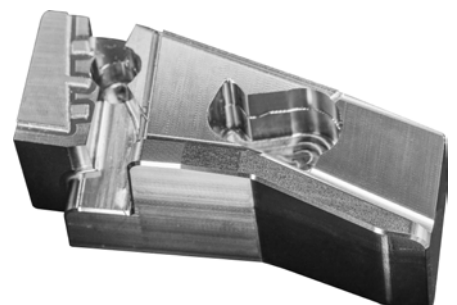
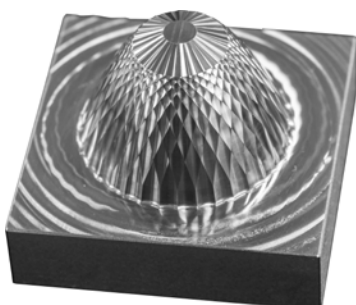
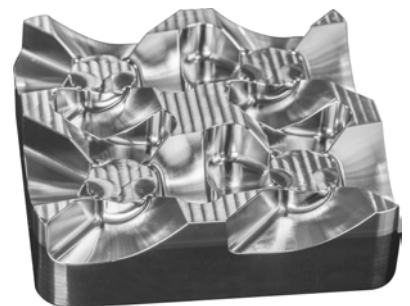
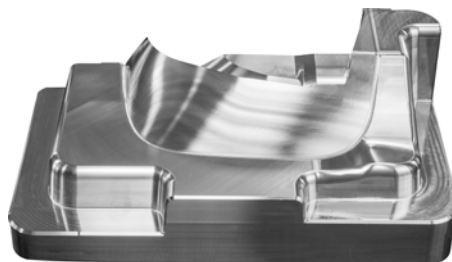
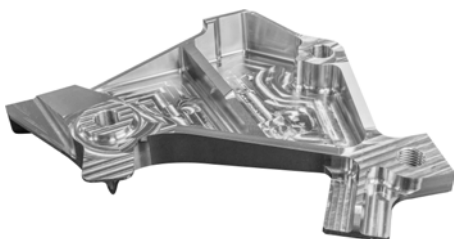
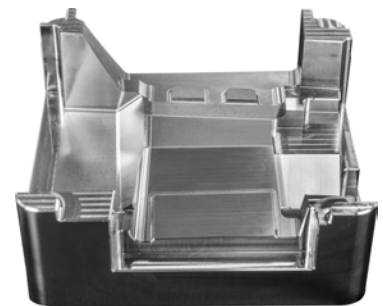
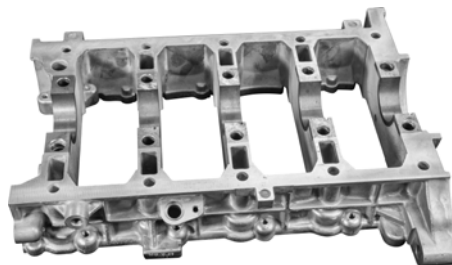
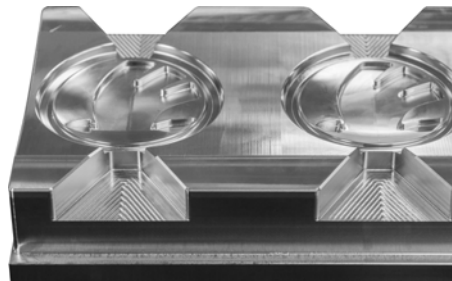



hyperMILL
SolidCAM
The Leaders in Integrated CAM

DIJET NS TOOL
GÜHRING



LEHMANN



MST



SCHUNK



Blaser.
SWISSLUBE



REGO-FIX



BLUM
focus on productivity



Workpiece measuring by CMM

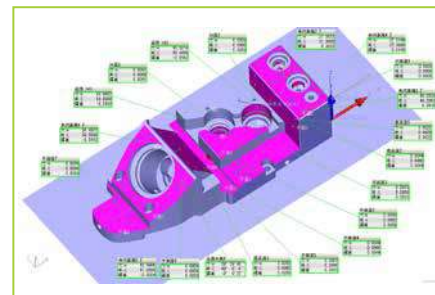
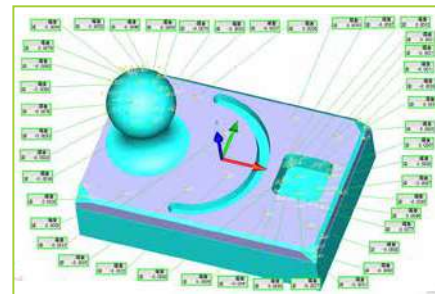
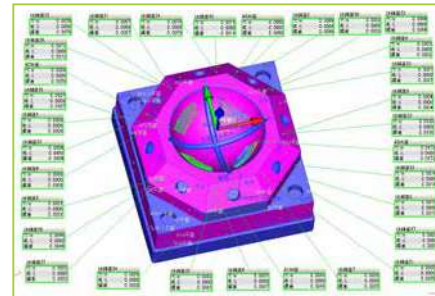
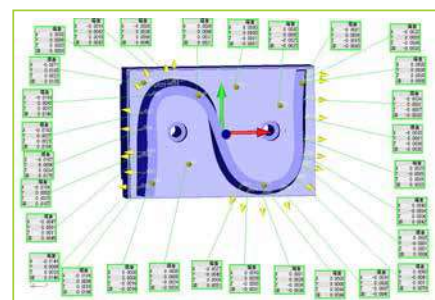

The above specifications are subject to change without prior notice, no liability for mistakes. Machines may be shown with optional equipment.

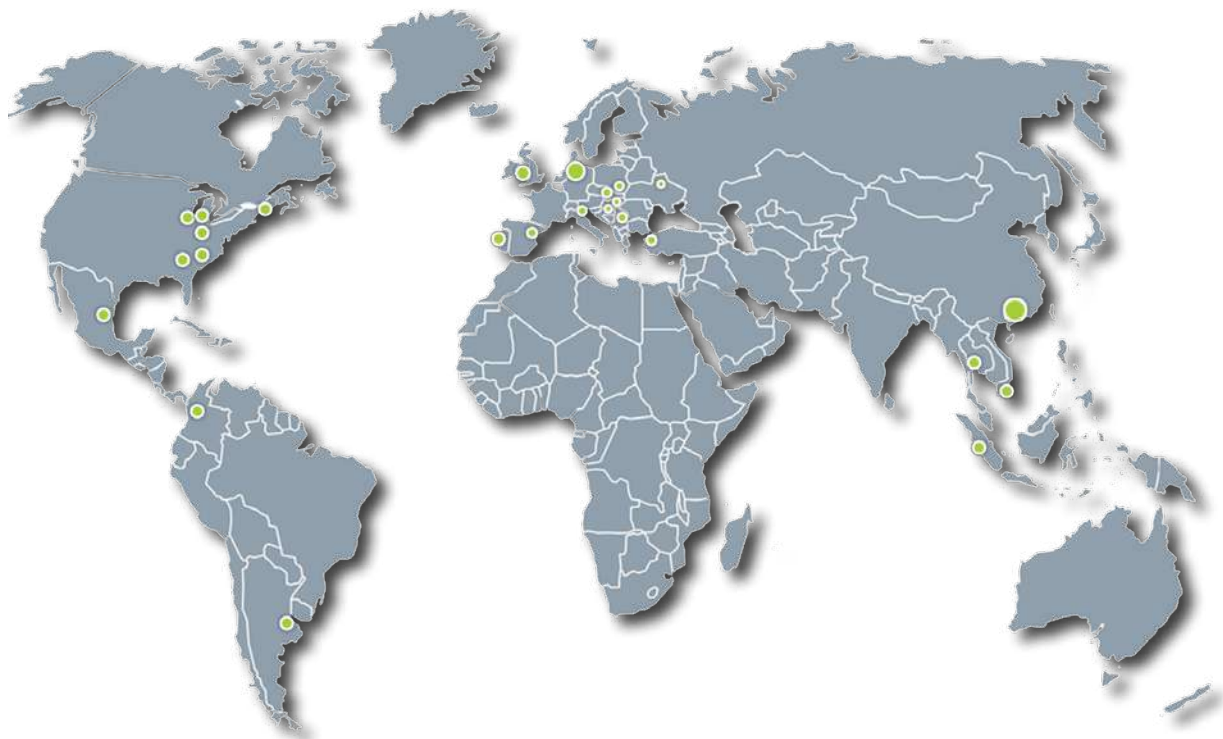

PRIMINER Werkzeugmaschinen GmbH

Gadelander Str. 172 · D-24539 Neumünster / Germany

Tel: +49 (0) 4321-53 9946-0

Fax: +49 (0) 4321-25 20 03-90

E-mail: info@priminer.de

PRIMINER SOUTH EAST EUROPE · PRIMINER d.o.o. BEOGRAD

Vladimira Popovica 38-40 · GTC - 11070 Beograd / Srbija

Tel: +381 69 702 705

Fax: +381 11 715 69 00

E-mail: office@priminer.de

PRIMINER RUSSLAND LLC

Building 3, 29, Staroye Yaskino Str., 143002 Odintsovo, Moscow Region, Russia.

Tel : +7 (495) 120-20-98

Website: www.priminer.ru

E-mail: info@priminer.ru

PRIMINER MACHINE TOOLS DONGGUAN CO., LTD

XinRuYi Industrial Park, Fuxing Road, Xingguang Village, Huangjiang Town, Dongguan, P.R.China

Tel: +86 769 838 490 61

Fax: +86 769 838 490 62

E-mail: sales@priminer.de

www.priminer.de