

STATIONARY COMPACTORS

245HD & 245XHD-WQ

Stationary compactors are the best choice for handling dry waste.

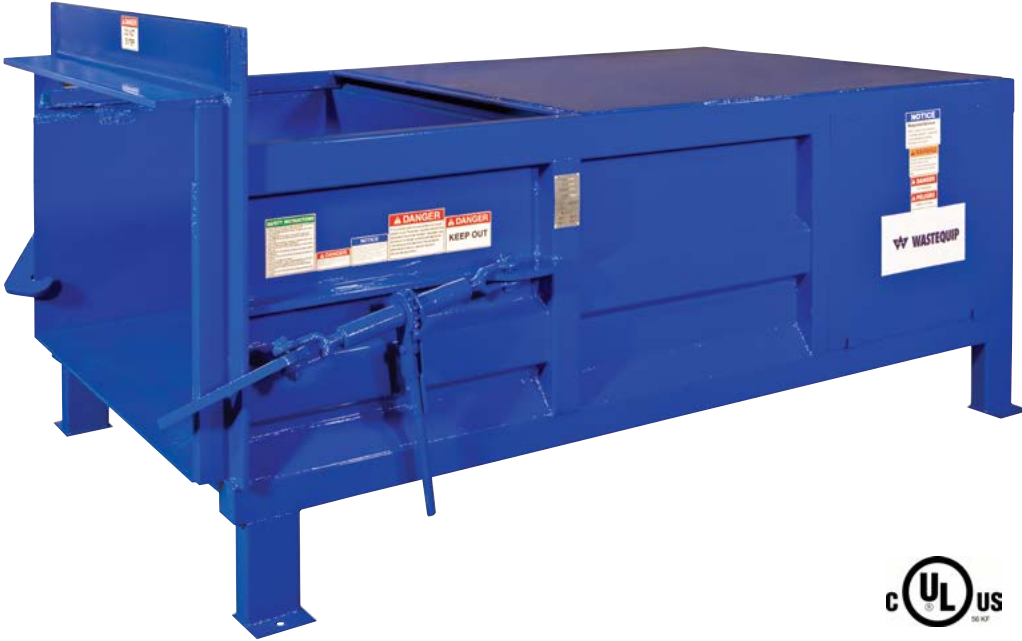

Value-Added Benefits

Reduced life cycle cost	<ul style="list-style-type: none"> Guardian Control System features an Automatic Maintenance Scheduler (AMS) alerts users after 200 hours that preventative maintenance is due
Ease of servicing	<ul style="list-style-type: none"> Guardian Control System is enclosed in a large 16" x 14" panel for faster, easier servicing
Durable	<ul style="list-style-type: none"> NEMA 4 rated enclosure protects against windblown dust, splashing water and hose-directed water
Increased safety	<ul style="list-style-type: none"> Watch Dog timers prevent the power unit from overheating 24-volt operator controls mean the system is safer than 110-volt systems and uses less energy
Standard features included at no additional charge	<ul style="list-style-type: none"> Multi-cycle feature can be set at two (2) cycles to fully empty the charge box. A full light identifies when the container is full "Pack-out - over ride" feature that allows you to continue compacting after the 100% full light illuminates Low temperature oil for harsh climates increases service life*
Ease of ownership	<ul style="list-style-type: none"> Purchase, rental and leasing programs available
Strong warranty	<ul style="list-style-type: none"> 3-1-1 warranty is a 3 year structural, 1 year parts and 1 year labor warranty



24 volt Guardian control system is UL listed



245 series compactor shown with optional side hopper



1 3/8" ratchet binders with 1" hooks are standard to connect with roll off waste container

*Use of an oil heater or extreme cold weather hydraulic oil is recommended in extreme cold conditions.

NOTE: Remote power unit also available.

877.468.9278
 sales@wastequip.com
 www.wastequip.com



STATIONARY COMPACTORS

245HD & 245XHD-WQ

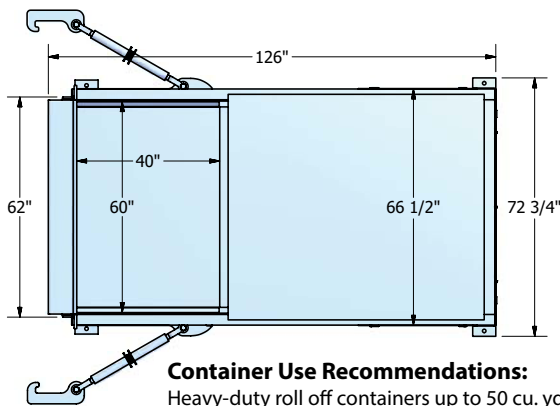
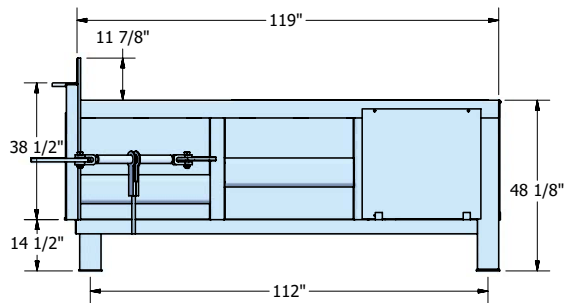

Container Use Recommendations:
Heavy-duty roll off containers up to 50 cu. yds. rated at 70,000 lbs.

Standard Features

- 1/2" steel plate compactor head floor
- 57 second cycle time
- Heavy duty breaker bar 8" x 8" x 1" angled steel
- Full container light
- Low temperature oil
- Multi-cycle timer
- NEMA 4 control panel protects against windblown dust, splashing water and hose directed water
- Operational and service manual
- Primed and painted in several colors

Optional Feature

- Advance warning light
- Pressure gauge - color coded
- Guide rails with stops
- Oil heater
- Photo electric eye
- Odor control system
- Cart dumper



Replacement parts available online at www.gotoparts.com



Specifications

		245HD-WQ	245XHD-WQ*
Charge Box	Wastequip rating	2.00 cu. yds.	
	Wastec rating	1.61 cu. yds.	
	Clear top opening	40" Length x 60" Width	39" Length x 60" Width
	Compactor weight with power unit	4,700 lbs.	4,800 lbs.
Ram	Ram height	30.50"	
	Ram penetration	14.00"	
	Face plate	1/2" steel with 3/4" stiffener plates	
	Base plate	3/8" steel plate with 10 ga. formed stiffeners	
	Top plate	1/4" steel plate with 10 ga. formed stiffeners	
	Side plates	1/4" formed plate	
Compactor Head	Floor	1/2" steel plate with channels at 1/2" spacing	
	Sides	1/4" steel plate sheets with 4" x 3" vertical tube stiffeners	Additional side stiffener
	Breaker bar	8" x 8", 1" angled steel	Additional 1" breaker bar backer plate
	Top deck	12 gauge steel (standard)	
Electrical	Electric motor, fan cooled	10 hp	15 hp
	Voltage	208/230/460, 3 phase 60 Hz	
	Power box	UL rated, TEFC housing	
	Automated cycle operation	Turn key switch-ram extends, retracts & stops automatically	
Hydraulic Performance	Pump	13.0 gpm	
	Pump type	Fixed gear	
	Hydraulic oil tank	25 gallon reservoir	
	Cylinder bore/rod/stroke	6" bore, 2.5" rod, 55" stroke	
	Normal ram face pressure	48,000 lbs at 1,700 psi	59,300 lbs at 2,100 psi
	Maximum ram face pressure	56,500 lbs at 2,000 psi	67,800 lbs at 2,400 psi
	Normal ram psi	26.23 psi	32.4 psi
	Maximum ram psi	30.87 psi	37.05 psi
	Cubic yard per hour	102	
	Power unit location	Internal	
	Cycle time	57 seconds	

* Specifications are the same as the 245HD-WQ, except where indicated.

Standard Color Choices*



Colors shown are as accurate as printing allows. The actual color is subject to variation from the printed color sample. Color choices vary by plant location.

Please contact your local sales representative for available colors. Custom colors are available upon request and are subject to an additional charge.



WASTEQUIP®

877.468.9278 · sales@wastequip.com · www.wastequip.com

Wastequip is the leading North American manufacturer of waste and recycling equipment for collecting, processing and transporting recyclables and solid or liquid waste.

© Wastequip, December 2014. All rights reserved. Specifications subject to improvement without notice. Equipment displayed should be operated by properly trained personnel. Operators should become familiar with OSHA, ANSI and any other applicable standards or laws for using this equipment. Improper use, misuse, or lack of maintenance could cause injury to people and/or property. Photos used in the literature are illustrative only. We assume no liability or responsibility for proper training/operation of equipment not manufactured by Wastequip. We reserve the right to make changes at any time without notice. Information contained within this literature is intended to be the most accurate available at time of printing.