

| DESCRIPTION | |
|-------------|---|
| 1 | 1 |
| 2 | 2 |

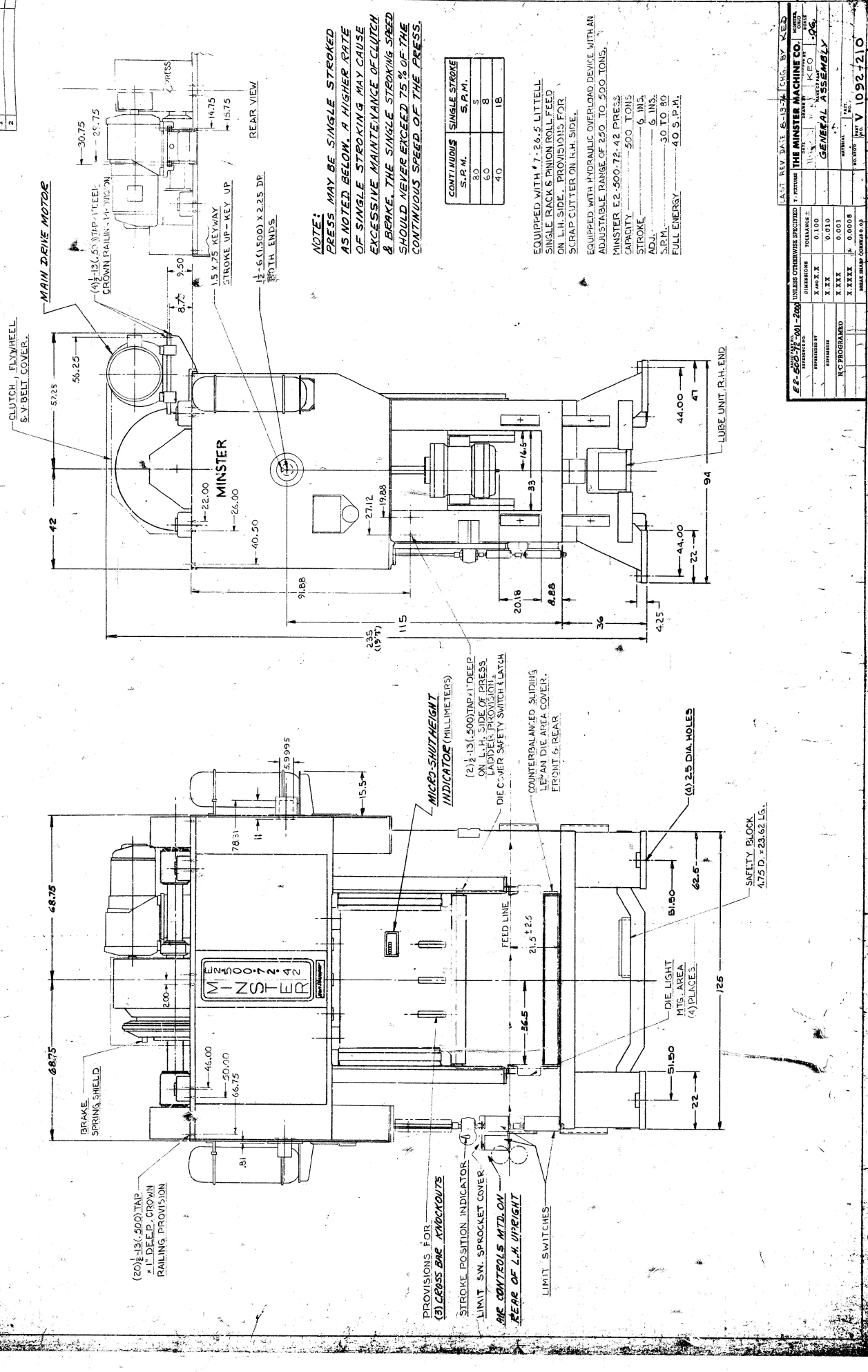

NOTE:
 PRESS MAY BE SINGLE STROKED AS NOTED BELOW. A HIGHER RATE OF SINGLE STROKING MAY CAUSE EXCESSIVE MAINTENANCE OF CLUTCH & BRAKE. THE SINGLE STROKING SPEED SHOULD NEVER EXCEED 75% OF THE CONTINUOUS SPEED OF THE PRESS.

| CONTINUOUS S.R.M. | SINGLE STROKE S.P.M. |
|-------------------|----------------------|
| 80 | 5 |
| 60 | 8 |
| 40 | 18 |

EQUIPPED WITH 7-26.5 UTTELL SINGLE TRACK & ROLLER FEED ON L.H. SIDE. PROVISIONS FOR SCRAP CUTTER ON R.H. SIDE.
 EQUIPPED WITH HYDRAULIC OVERLOAD DEVICE WITH AN ADJUSTABLE RANGE OF 250 TO 500 TONS.
 MINISTER EE-500-72-42 PRESS
 CAPACITY 500 TONS
 STROKE 6 INS.
 ADJ. 6 INS.
 S.P.M. 30 TO 80
 FULL ENERGY 40 S.P.M.

| | | | |
|-----------------------------------|----------|------------------|--------|
| UNLESS OTHERWISE SPECIFIED | | TOLERANCE | |
| FINISH | AS SHOWN | ± .010 | ± .010 |
| FINISH | AS SHOWN | ± .010 | ± .010 |
| FINISH | AS SHOWN | ± .010 | ± .010 |
| FINISH | AS SHOWN | ± .010 | ± .010 |
| FINISH | AS SHOWN | ± .010 | ± .010 |
| LAST REV DATE 8-13-72 ENG. BY KED | | | |
| THE MINISTER MACHINE CO. | | GENERAL ASSEMBLY | |
| MINISTER MACHINE CO. 1092-210 | | | |