

# WINKLER+ DÜNNEBIER

# WD

## 10

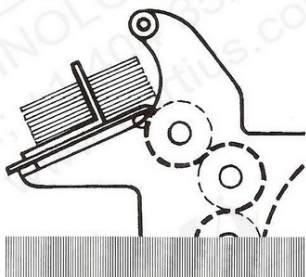
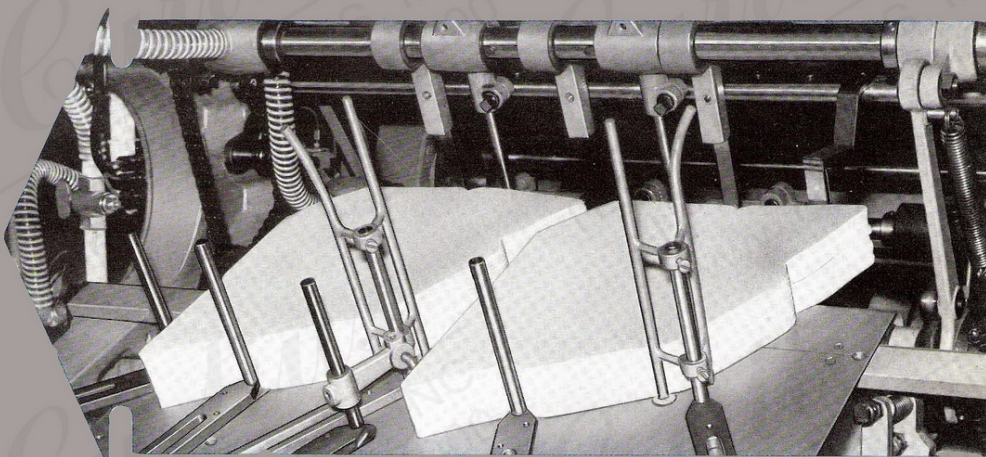

## Four-Colour Offset Printing Press



# Four-Colour Offset Printing Press

The HELIOS 10 four-colour-offset/letterset printing machine, built for more than 10 years and continuously improved is a solid and space-saving construction, designed for the future on the satellite principle, i. e. the blanks and sheets are guided along the printing units in one gripper action. This principle guarantees absolute register.

With an overall machine length of only 3 m (abt. 10') the operator has short ways to watch the individual stations such as delivery, printing units and feed. The moving out of three inking units ensures maximum accessibility of plate and rubber blanket cylinders.

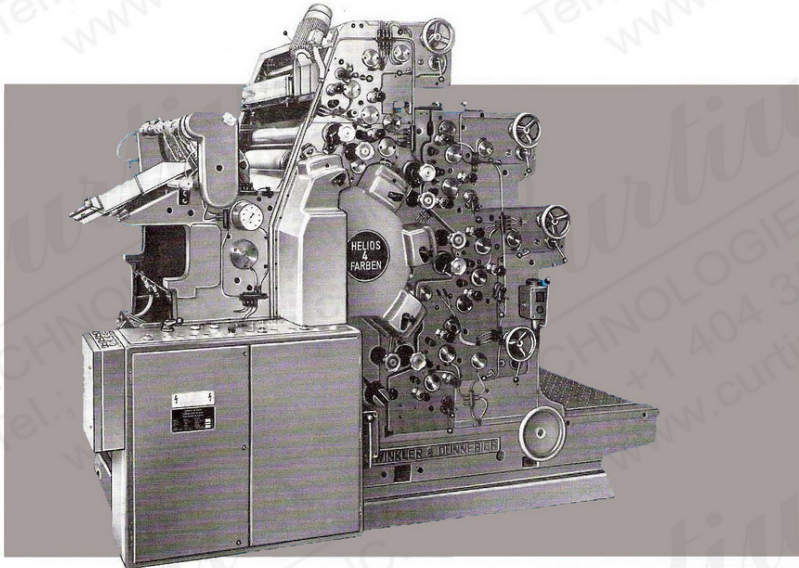

Side and circumference register of all plate cylinders can be adjusted towards each other during the run of the machine. Perfectly designed roller locks ensure an exact adjustment of all ink application rollers, also during operation (diameters: 65, 74, 87 mm). Automatic roller washing devices clean the inking units within a few minutes.

The W & D feed system ensures a continuous paper feed. There is no change of piles and no waste. The paper transport from the impression cylinder to the delivery is effected smear-free over a suction drum to an automatically descending delivery table.

Electronically controlled alcohol damping units guarantee an exact ink-water balance. Infinitely adjustable drive motors for the damping units permit a speed control independent from the speed of the machine. For this purpose, potentiometers are fitted at the delivery end of the machine which allow a direct water control.

Equipped with Baldwin Water Circulation System as standard. A constant circulation and cleaning of the damping solution offers additional operating comfort. On special request the machine can be provided with a cooling system and a device for keeping the alcohol of the damping solution at a constant level.

A centralized lubrication system operating under pressure ensures reliable and exactly dosed lubrication of the complete machine.



Verstellbarkeit

size ranges

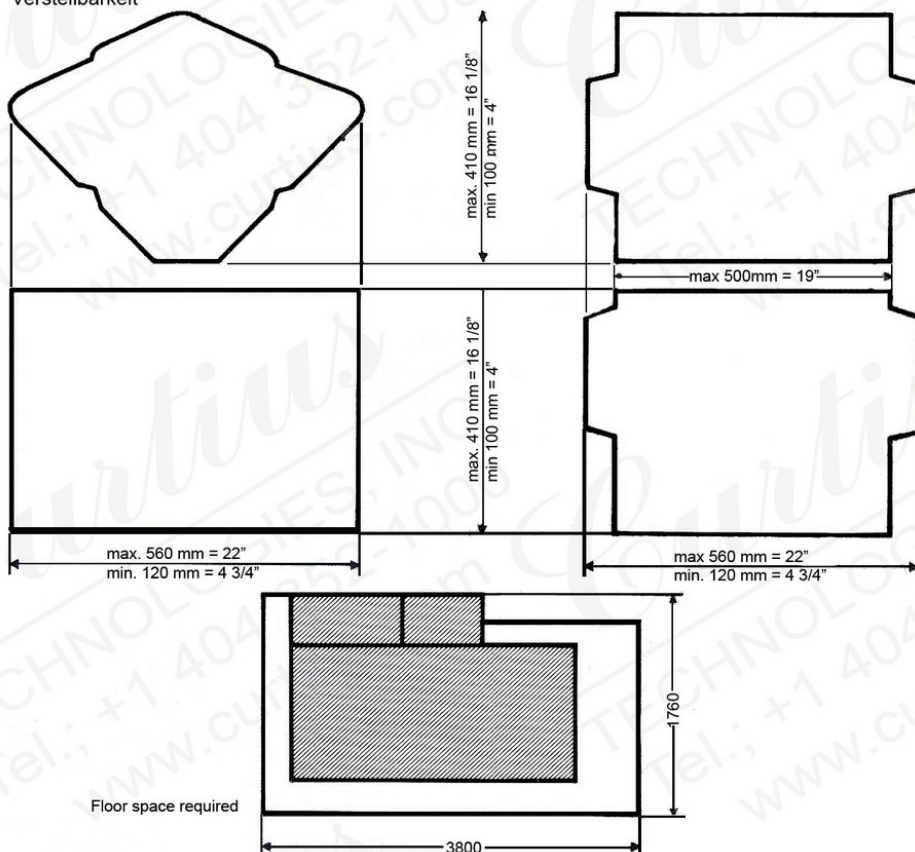

Floor space required

3	outside printing units (letterset resp. offset)
1	inside printing unit (flexo)
380x560mm (15x22")	maximum printing surface
13mm (1/2")	gripper edge
250	max. output blanks resp. sheets per minute
200	letterset
18kVA	offset
	power required abd.
8350kg	net weight abt.

