

Model **V72HS**

Vertical Baler



When Speed and Efficiency are Critical in a High Production Environment, You Need the GPI V72HS

At GPI we understand that time is money, this is why we invented the V72HS, the fastest Vertical Baler you can buy. By combining the awesome strength of two 5" heavy duty cylinders, with the blazing speed of a 20 horsepower motor and our

THE V72HS IS IDEAL FOR:

- **Recycling Centers**
- **Transfer Stations**
- **Super Markets**
- **Hotels/Motels**
- **Department Stores**
- **Manufacturing Facilities**
- **Furniture Stores**
- **Military Bases**
- **Industrial/Commercial Sites**
- **Shopping Centers**

unique regenerative hydraulic system, the GPI V72HS produces cycle times other companies can only dream about. Combine this speed with the oversized feed opening, the V72HS's low operating height, and the ability to make incredibly heavy bales, and you have a formula for success that leads directly to an increase in your bottom line. The V72HS, another great idea from GPI....



GPI Model V72HS Vertical Baler

Features, Specifications and Dimensions

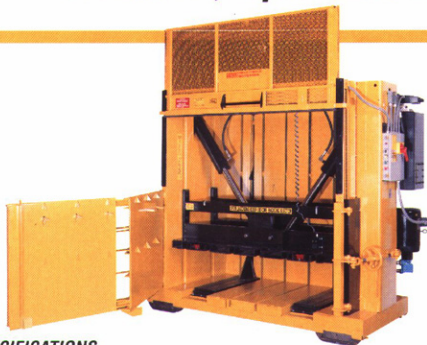

SPECIFICATIONS

BALE SIZE

40" X 72" X UP TO 39"
(102 Cm X 183 Cm X UP TO 99 Cm)

BALE WEIGHT - CORRUGATED

UP TO 1,100 POUNDS (500 Kg)

RAM PRESSURE

98,125 POUNDS MAX (44,510 Kg)

CYCLE TIME

24 SECONDS

CYLINDERS

TWO 5" (13 Cm) BORE, 3" (8 Cm) ROD,
28" (71 Cm) STROKE

MOTOR

20 HORSEPOWER, TEFC

PUMP

VANE TYPE

ELECTRICAL POWER

208/230/460 VOLT, 3 PHASE, 60 HZ

BALE EJECT

DUAL HYDRAULIC

BALE TYING

WIRE OR BANDING

DIMENSIONS

LOADING DOOR OPENING

28" X 72" (71 Cm X 183 Cm)

LOADING DOOR HEIGHT

47" (119 Cm)

OVERALL HEIGHT

111" (282 Cm)

OVERALL DEPTH

51" (130 Cm)

OVERALL WIDTH

101" (257 Cm)

DEPTH WITH DOOR OPEN

93" (236 Cm)

WIDTH WITH DOOR OPEN

101" (257 Cm)

SHIPPING HEIGHT UPRIGHT

88" (224 Cm)

SHIPPING WEIGHT

6,340 POUNDS (2,876 Kg)

INSTALLATION AND

OPERATING AREA

69 SQUARE FEET

(6.41 SQUARE METERS)

Features of the GPI V72HS

- Powerful Twin 5" Cylinders with Heavy Duty 3" Rods for Extra Long Life
- Heavy Duty 20 Horsepower Motor for Extra Long Life
- Unique Hydraulic Circuit for High Speed Applications
- UL® Listed Control Panel
- Operates Under a 10 Foot Ceiling
- Standard Retractable Bale Dogs for Maximum Material Containment
- Standard Voltage Electrical Disconnect Included
- Enclosed Counterbalance for Upper Door Lifting Ease
- Dual Hydraulic Ejection for Extra Dense Bales
- Stronger Heavy Duty Construction than Comparable Balers
- No Fluffing of Material Necessary
- Six Slots for Tying Bales
- Meets or Exceeds All ANSI and OSHA Safety Standards

Another Great Idea From...



A Division Of
Harmony Enterprises, Inc.
704 Main Ave. North
Harmony, MN 55939 U.S.A.
Phone (507) 886-6666
Fax (507) 886-6706

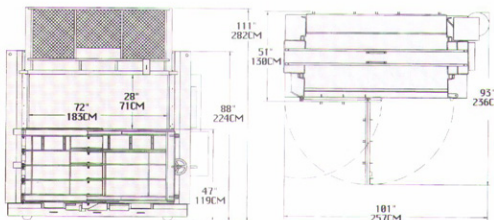

Toll Free: 1-800-658-2320

Specifications Are Subject to Change Without Notice
Form 970201SK