

Caution:
For all platen with several parts,
the difference between the maximum thicknesses
of adjacent parts must not exceed 0,03 mm

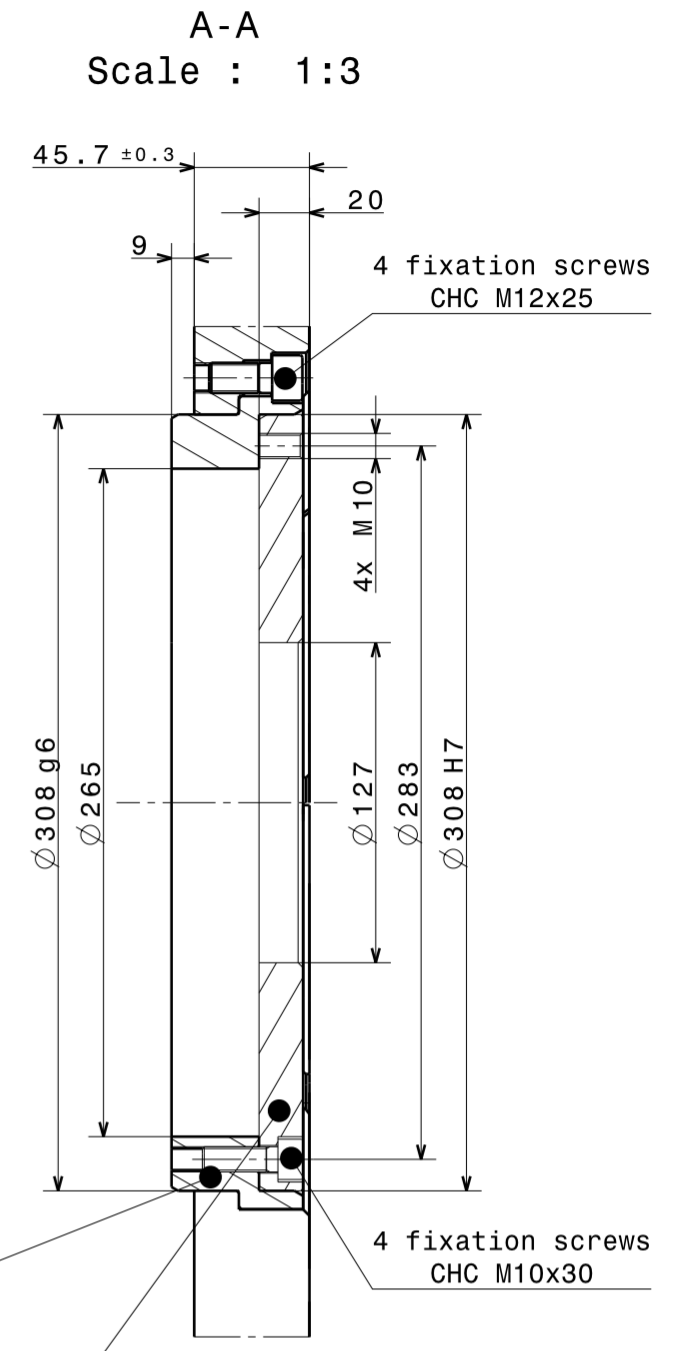
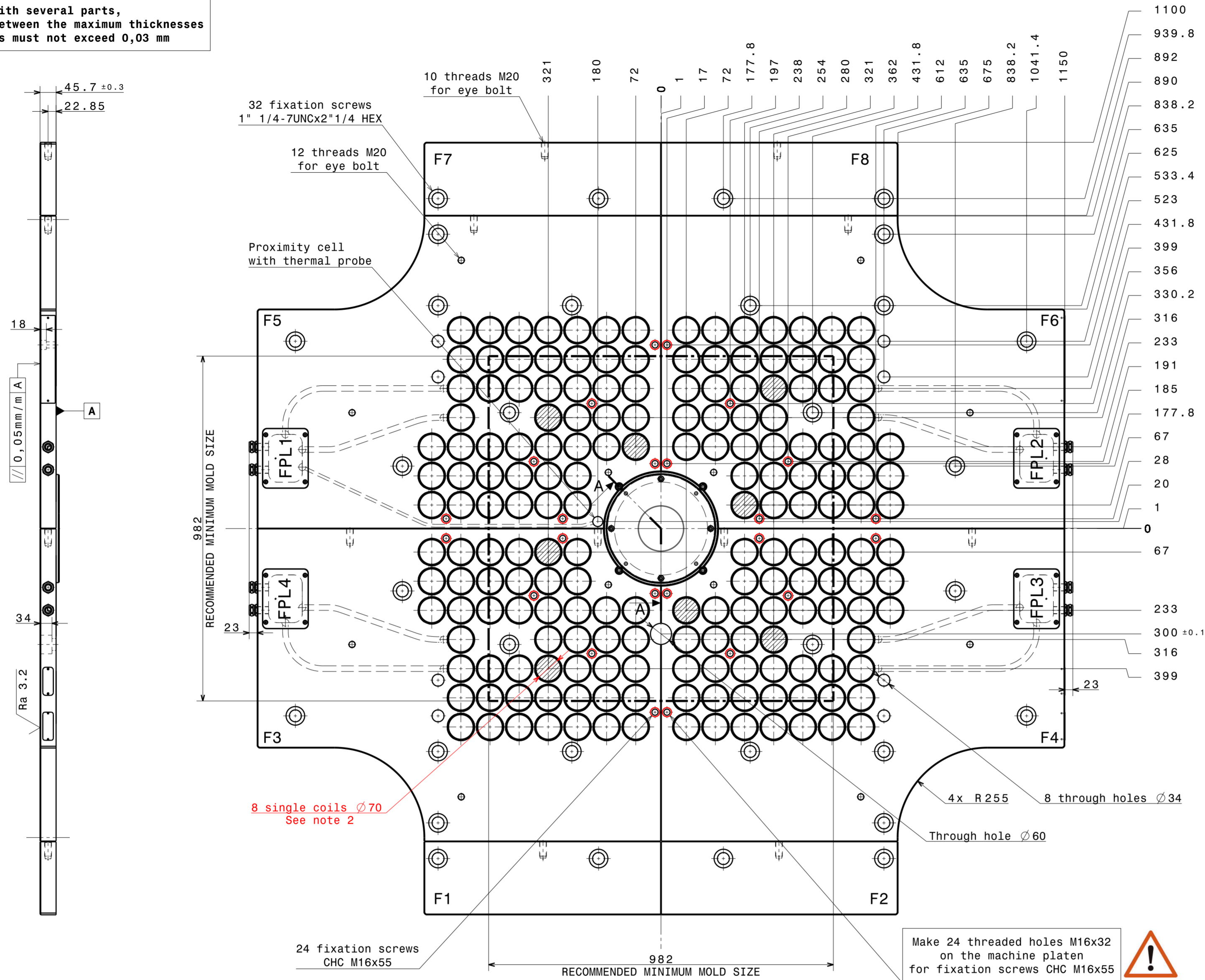

- NOTES:**
- Molder should follow the minimum mold cross sectional area recommended by the injection molding manufacturer to avoid platen deflection therefore affecting the proper operation of magnetic system.
 - The mold has to cover as much as possible the indicated "single coils" (hatched surface).
To be accepted, the mold has to cover more than 85% of 3 "single coils".
 - Excessive temperature can affect the effectiveness of the magnetic system and should remain below 120°C.
 - Each magnet pole clamping force is 5.2 KN. The maximum clamping force of the platen is 956 KN.
 - Electrical junction boxes are located on both sides of the platen.
 - Electrical requirements: 380-480 volt, two phases, 50-60 hertz.
 - Force of the magnetic system in the RECOMMENDED MINIMUM MOLD area, assuming no voids in the mold is 539 KN.
 - WARNING : Always use centering ring when the weight of the half mold is over 1/8 of displayed magnet clamping force, to prevent mold slipping. The opening force must be reduce under displayed magnet clamping force.

Plan pour consultation
For Information only

NUMBER POTS PER PLATEN : 184
NUMBER CIRCUITS : 8
NUMBER POTS PER CIRCUIT : 23
INDICATIVE WEIGHT : 1465 Kg

N.bre	Désignation	Dimension	Rep.	Matière	Norme ou N°d'article
	QMC123/ES				
APPLICATION DRAWING - STATIONARY PLATEN					
HAITIAN - JU18500III - 1850T					
Ce document est la propriété exclusive de STAUBLI FAVERGES. Il est interdit d'en faire usage ou de le communiquer sans autorisation écrite. This document is the exclusive property of STAUBLI FAVERGES. It is forbidden to use or to communicate it without written authorization.					
				Echelle 1/9	Date 11-juin-24
				Créé	11-juin-24
				Contrôlé	11-juin-24
				Visa	BETC
				Créé	11-juin-24
				Contrôlé	11-juin-24
				Visa	BETC
8 000 160 420 A					

Tolérances générales selon : Qualité: Degré de façonnage sauf indications spéciales: