



HYDRAULIC HEDGE MOWERS | *AGRICULTURAL SERIES*

WWW.ORSIGROUP.IT

COMMAND

CLASSIC

Standard

COMMAND WITH PROGRESSIVE TELEFLEXIBLE CABLES

Maximum reliability and robustness, high easy use.



EASY-TRONIC

MECHANICAL CABLE PROPORTIONAL SINGLE LEVER CONTROL 1st AND 2nd MOVEMENT + 3rd AND 4th ELECTRIC MOVEMENT WITH ON-OFF BUTTONS. EASE OF MOVEMENT AND STRENGTH

The EASY-TRONIC control has the proportional movements of the 1st and 2nd arm operated by the joystick. The electric movement of the head inclination takes place via 2 buttons ("ON / OFF", 3rd movement), the floating function is activated with a dedicated switch ("0 / 1"). 2 other buttons on the joystick control the electric movement of the rotation of the hydraulic column (4th movement if present).

The positioning of all the switches on the back of the joystick allows the operation of all movements with a single hand. The rotor is switched on and off by means of a tele-flexible cable control with lever. The rotor control is equipped with an anti-rotation safety lever for involuntary / accidental inversion of the rotor.

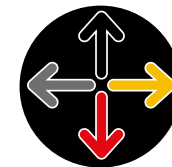

SINGLE MOVEMENTS

NEW
SMART-TRONIC EVO



SINGLE MOVEMENTS



AGRICULTURAL SERIES

UNCOMPENSATED ELECTRO-PROPORTIONAL CONTROL SYSTEM

Ergonomic joystick designed to improve productivity and alleviate the psychophysical effort of the operator; all functions on the palm of one hand, high sensitivity of reaction to inputs, minimal space on the driver's station: the control joystick and the machine-tractor connection is via a thin CAN-bus cable.

The SMART-TRONIC EVO control has all proportional movements, not compensated*. The 1st and 2nd arms are operated from the main handle. With the mini-joystick at the top of the handle, you can control the tilt of the cutting head and the slewing of the boom-mower column with your thumb. With the semi-roller, located at the bottom of the handle, using the index (or middle) finger you can control the movement of the telescopic arm. The middle and ring fingers can be used to activate and deactivate both the electric floating of the cutting head and the electric suspension of the first arm (optional). Rotor activation/deactivation and the sense of rotation are controlled by two buttons on the control console. Rotor reversal, controlled by an electronic timer.

***NO SIMULTANEOUS MOVEMENTS**

THE ORSI QUALITY



ARM ENDING AND JOINT GROUP
IN CAST IRON

HYDRAULIC SYSTEM

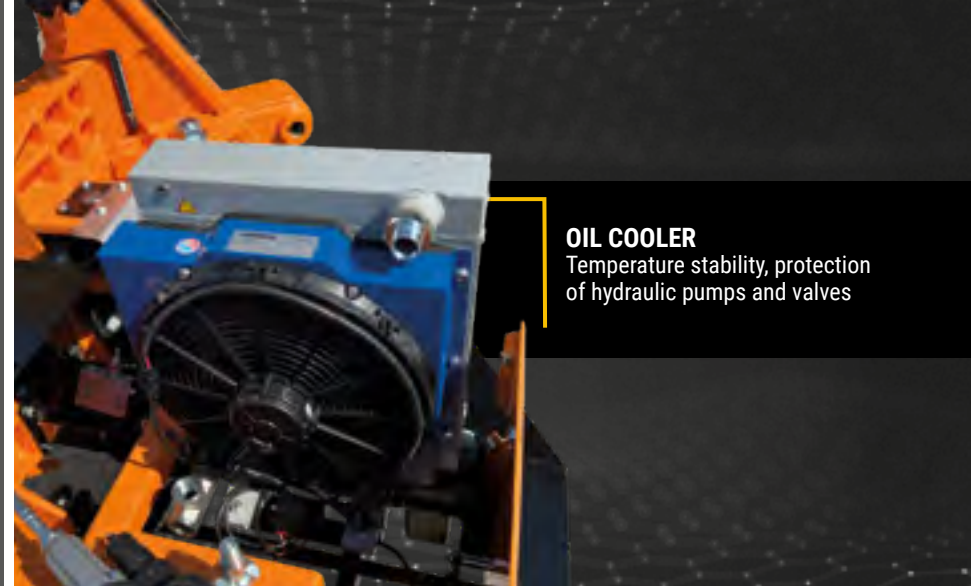

OIL COOLER
Temperature stability, protection of hydraulic pumps and valves



GEAR PUMP AND MOTOR



OVERCENTER VALVES
(only Smart-Tronic EVO)

CAST-IRON GEARBOX



FILTERING SYSTEM TO PROTECT HYDRAULIC COMPONENTS

MANUAL EMERGENCY LEVERS

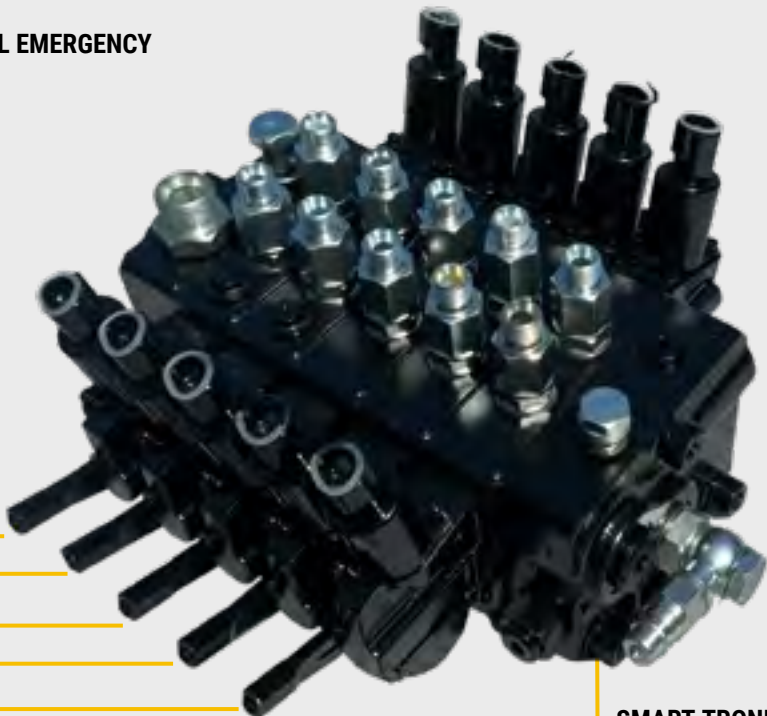

SMART-TRONIC, ELECTRO PROPORTIONAL AND COMPENSATED MONOBLOCK VALVE

TRACTOR ATTACHMENTS

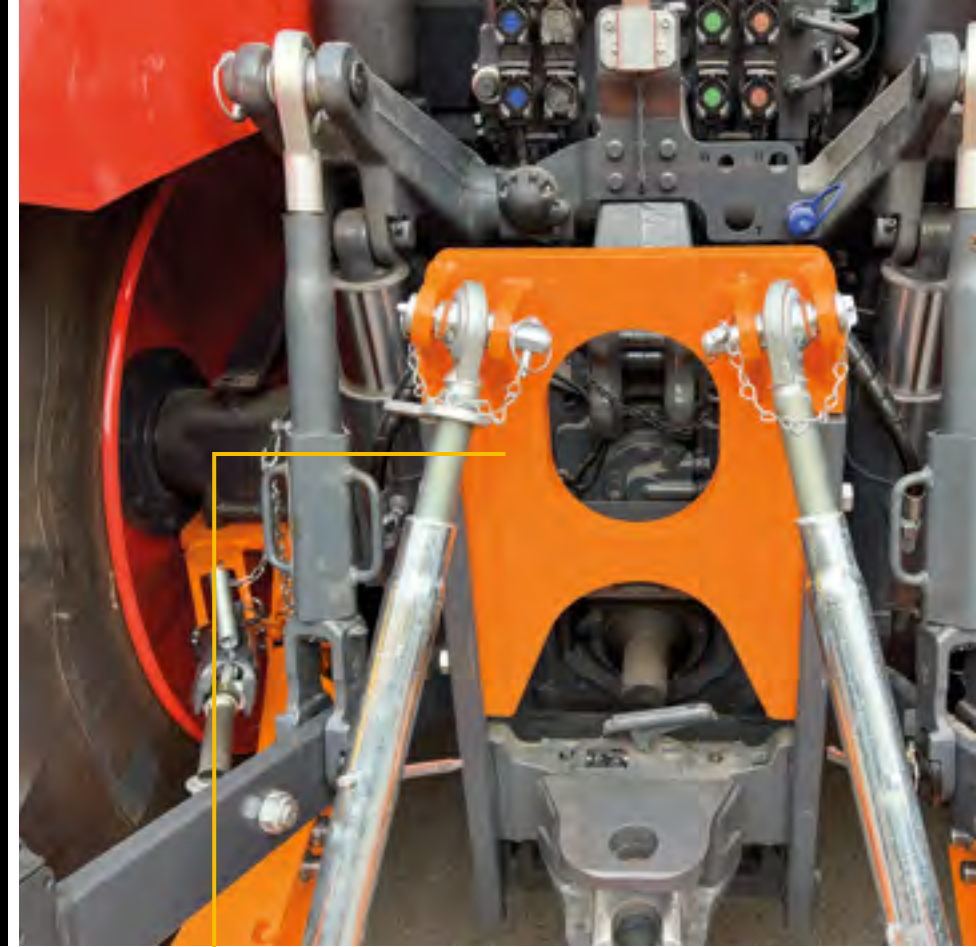

BRACKET *(optional)*

For use in conjunction with stabilizers. If the tractor is not equipped with suitable anchorage points for stabilizers.

STABILIZERS HITCH PLATE

(recommended options)

Some tractors are equipped with a sledge tow hook. This type of attachment for tensioners makes the mounting of the hedge cutter on the tractor more rigid.

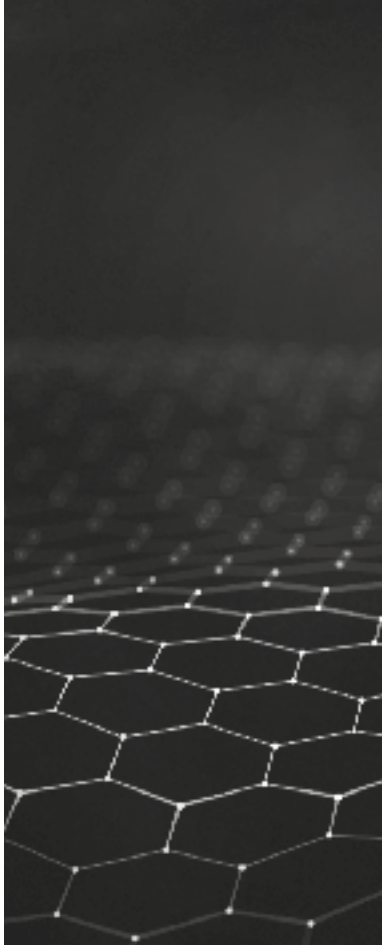

RAPID LINK

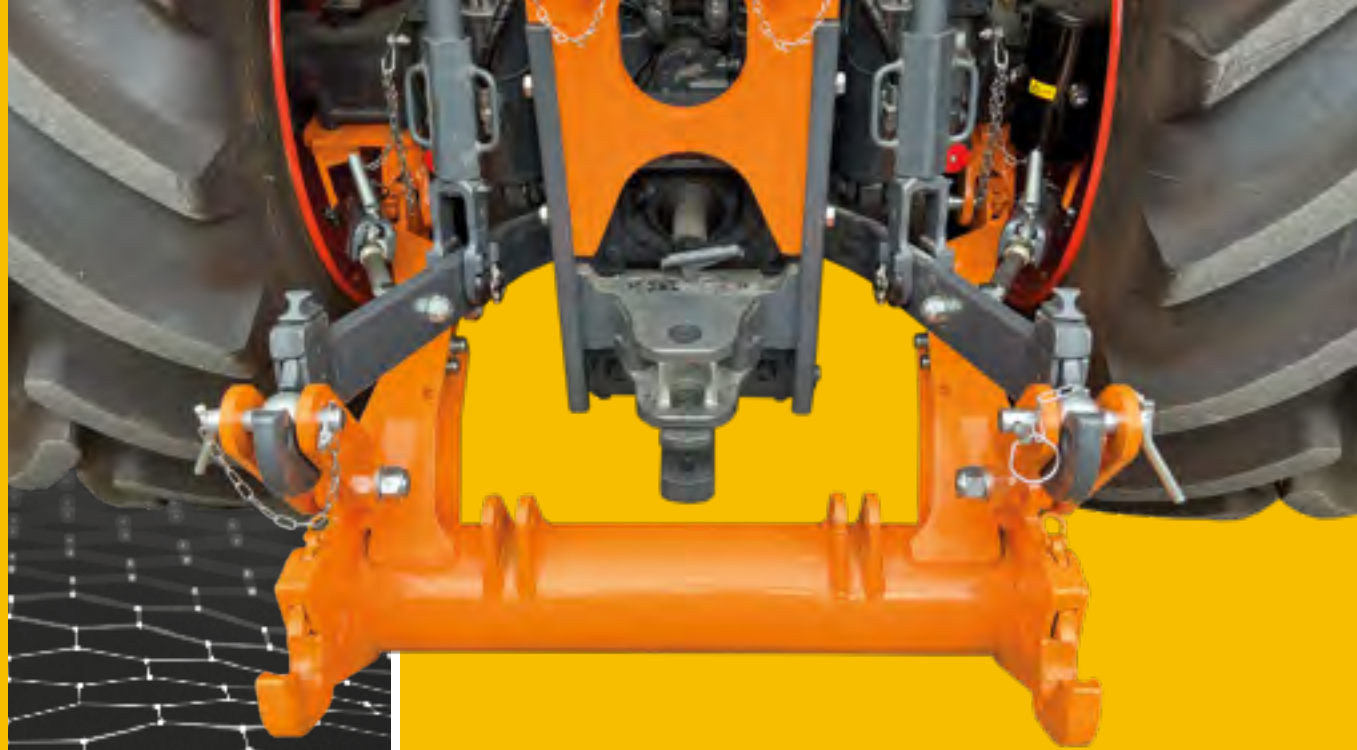

RAPID LINK
(recommended options)
Much stronger and more stable mounting frame than the tractor linkage. Quick assembly and disassembly.



SCAN ME

LEVELING SYSTEMS

4*
km/h

***NO FLOATING
NO SUSPENSION**

A continuous manual input is required.

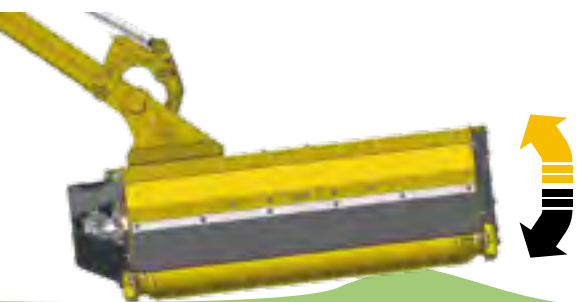

**CUTTING HEAD WITH
FLOATATION SYSTEM**

Allows the cutting head to follow automatically the shape of the ground in a vertical plane, reducing the required manual inputs on the joystick from the operator and increasing the comfort.

Available on every Orsi Group Reach Mower.





8*
 km/h

***VERTICAL FLOAT**

Semi-automatic floatation system of the cutting head on the ground, reduces the number of manual inputs and increases the comfort while working.

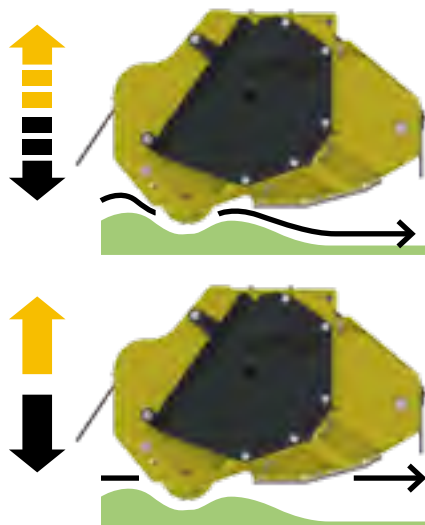

VERTICAL FLOAT

A hydropneumatic suspension which allows the cutting to follow the shape of the ground on a vertical plane. It reduces significantly the need of manual actions to adjust the position.

- Reduction of manual inputs;
- Floatation range up to 35 cm ;
- Pressurized nitrogen accumulator;
- Constant cutting height;
- Reduction of a premature wear on tools and skids.

* Depending on machine and ground conditions



HARDOX AND STRENX



WHY WE USE HARDOX?

Hardox® 450

The most popular abrasion-resistant steel with excellent structural properties.

Hardox® 450 is an abrasion-resistant steel with a nominal hardness of 450 HBW. Hardox® 450 combines good bendability and weldability with an option for guaranteed impact toughness (Hardox® 450 Tuf).

The products can be used in many different components and structures that are subject to wear. Hardox® 450, with an extra 50 Brinell hardness over our 400 grade, provides better dent and abrasion resistance as well as longer wear life, so you can achieve even greater savings.



WHY WE USE STRENX?

Superior properties

Strenx® steel has extremely consistent properties, ensuring precision and efficiency in the workshop.

If you think all steel is basically the same, Strenx® performance steel will change your thinking. Strong and reliable from surface to core, Strenx® steel features exceptional surface quality as well as impressive thickness and flatness tolerances verified by the Strenx® guarantees. The steel's properties - yield and tensile strength, bending performance, impact toughness - are carefully tested to ensure reliability and consistency in every delivery.

CUTTING HEADS

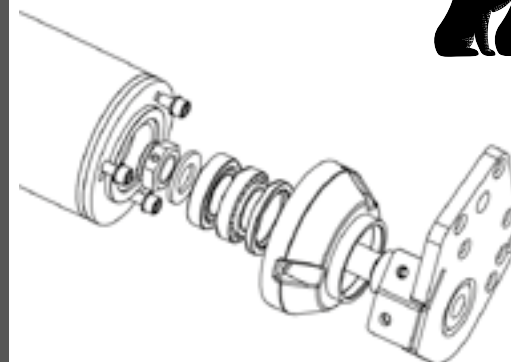

PROFESSIONAL REAR ROLLER
Ø 140 mm (standard)
with 4 taper roller bearings, mud scraper and interchangeable central body.



DIRECT TRANSMISSION
The hydraulic motor is installed directly on the side of the cutting head, protected by a robust carter.



BELTS TRANSMISSION
The hydraulic motor is installed internally; the power output is transmitted by belts and pulleys. The size is significantly reduced allowing to work in narrow spaces.

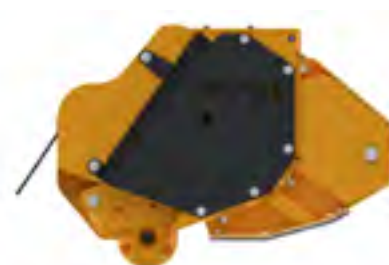

REAR ROLLER ADJUSTABLE IN HEIGHT

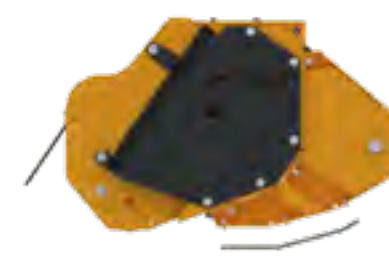

SKIDS (standard)
Standard equipment in all PROF cutting heads, substitutable in a few minutes.

CUTTING HEAD AGRI	DIRECT TRANSMISSION	BELTS TRANSMISSION
Double frame	✓	✓
Multi-knife rotor	✓	✓
Oscillating bearings with double rows of balls	✓	✓
Hardox counter knife	✓	✓
Cutting Head with floating and self-leveling system	✓	✓
Head rotation	230°/240°	230°/240°
Double rotation of the rotor	✓	✓
Skids	✓	✓
Professional rear roller Ø 140 mm (Ø 5,5") with 4 roller bearings, mud scraper and interchangeable central body	•	•
CUTTING HEAD GARDENING		
Oscillating bearings with double rows of balls	✓	-
Head rotation	✓	-
Double rotation of the rotor	✓	-
Side skids on head	•	•



CUTTING HEADS

ROTOR / TOOLS



PD REAR MOUNTED



PS MOUNTING ON TOP

TOOLS

- | | | |
|--|--|--|
| A GRASS
max Ø 1,5 cm / 0,6" | D GRASS AND WOOD
max Ø 3 cm / 1,2" | N WOOD
max Ø 5 cm / 2" |
| S GRASS AND WOOD
max Ø 2,5 cm / 1" | E GRASS AND WOOD
max Ø 3 cm / 1,2" | O GRASS AND WOOD
max Ø 3 cm / 1,2" |
| F HEDGES
max Ø 4 cm / 1,6" | P GRASS, RUSHES AND WOOD
max Ø 5 cm / 2" | Q GRASS, RUSHES AND WOOD
max Ø 5 cm / 2" |

GARDENING

DIRECT TRANSMISSION



MULTI-KNIFE ROTOR

ROTOR

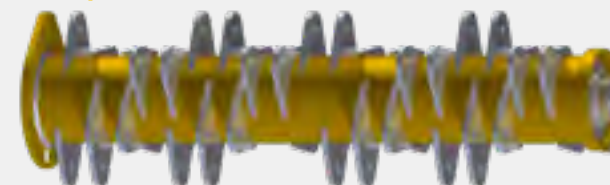

A: Ø 90 x 6 mm
A: Ø 3,6" x 0,3"

31" / 80 cm

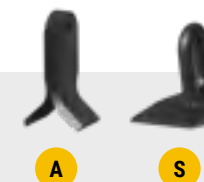

! FOR MULTI-KNIFE ROTOR, SPECIFY THE CHOICE TOOL AT TIME OF ORDER

AGRI PS

DIRECT TRANSMISSION



AGRI PS

BELTS TRANSMISSION



AGRI PD

DIRECT TRANSMISSION



AGRI PD

BELTS TRANSMISSION



PROF PS

DIRECT TRANSMISSION



PROF PS

BELTS TRANSMISSION



LEADER UP PLUS

MULTI-KNIFE ROTOR

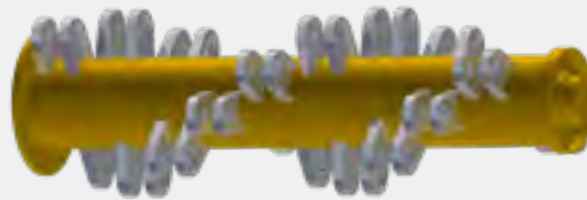

31" / 80 cm
41" / 105 cm
49" / 125 cm

A: Ø 102 x 12,5 mm
A: Ø 4" x 0,5"

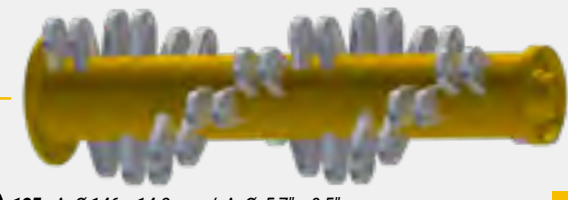

125 - A: Ø 146 x 14,2 mm / A: Ø 5,7" x 0,5"

49" / 125 cm



D

E

F

N

O



P ROTOR WITH Y KNIVES



Q ROTOR 3-KNIVES

CUT REVERS

029

COMPASS

16 - 35 HP

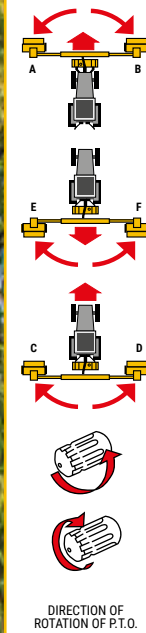









DIRECTION OF ROTATION OF P.T.O.



VERSION AVAILABLE TO BE MOUNTED:
 REAR RIGHT | REAR LEFT
 FRONT RIGHT | FRONT LEFT
 REVERSE DRIVE RIGHT | REVERSE DRIVE LEFT





MODEL	 min	 hp/kW	 min	 min	 kg/lbs	CAT.		 optional	rpm / min
029 / 029 left version	800 kg / 1763 lbs	16 HP/12 kW	100 cm / 39 in	313 cm / 123 in	310 kg / 683 lbs	I	540	1000*	3350

* with frontal hitch

CUT REVERS	029 / 029 LEFT VERSION
HYDRAULIC SYSTEM	
Oil tank capacity	65 lt / 17gal
Arm movements oil flow rate	7 lt / 2 gal min - 170 bar / 2466 PSI
Cutting head oil flow rate	40 lt / 11 gal min - 210 bar / 3046 PSI
Hp / kW head rotor	25 hp / 18,6 kW
4 kW oil-cooler with thermostat	•
TRANSMISSION	
Hydraulic motor	Alloy Group 2
Hydraulic pumps	Alloy
Multiplier	Alloy
SAFETY	
Safety spring on 2nd arm	✓
HITCH	
Stabilizers	✓
Bracket	•
Frontal mounted supplement price - PTO 1000 rpm	•
CONTROLS	
Classic	✓
Easy-tronic	•

DIRECT TRANSMISSION

WORKING WIDTH

CUTTING HEAD	80	80
 <p>GARDENING SERIES</p>		
MODELS		
029 / 029 left version	✓	•

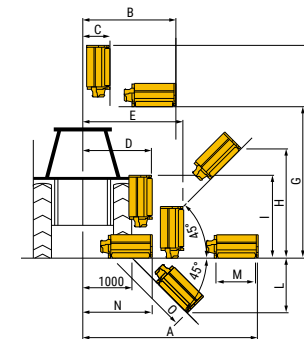

cm / inch	029 / 029 SX
A	313 cm / 123 in
B	153 cm / 60 in
C	50 cm / 20 in
D	61 cm / 24 in
E	167 cm / 66 in
F	376 cm / 148 in
G	243 cm / 96 in
H	196 cm / 77 in
I	150 cm / 59 in
L	113 cm / 44 in
M	80 cm / 31 in
N	134 cm / 53 in
O	160 cm / 63 in











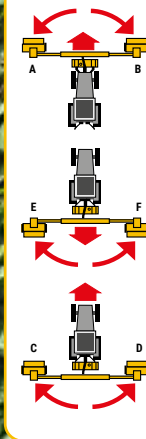

HEDGE

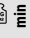
160

COMPASS

20 - 75 HP

MODEL	  	 hp/kW	 	 		CAT.
160	800 kg / 1763 lbs	16 HP/12 kW	100 cm / 39 in	423 cm / 166"	190 kg / 419 lbs	I-II

HEDGE	160
HYDRAULIC SYSTEM	
Minimum oil flow	15-20 lt / 4-5 gal
Oil flow rate pruning bar head 100 cm/39 in max Ø cutting 1 cm/0,4 in	see motor list below
Oil flow rate pruning bar head 160 cm/63 in max Ø cutting 1 cm/0,4 in	see motor list below
Priority compensated flow control in the hydraulic system, excess to pressure	✓
CONTROLS	
Classic (tele flexible control with floating)	✓
Quick couplings tractors	✓
Classic (tele flexible control with floating) Cable L=2000	•
Classic (tele flexible control with floating) Cable L=3000	•

(A.) PRUNING CUTTING

AT WISH WHEN ORDERING

CYL. C.C.	FLOW RATE	BAR PRESSURE
32 c.c.	7 l / 2 gal min	90 BAR / 6,2 PSI
40 c.c.	8 l / 2,5 gal min	70 BAR / 4,9 PSI
50 c.c.	10 l / 3 gal min	60 BAR / 4,2 PSI

(B.) HEDGE BAR

AT WISH WHEN ORDERING

CYL. C.C.	FLOW RATE	BAR/PSI PRESSURE
50 c.c.	15 l / 4 gal min	120 BAR / 8,3 PSI
80 c.c.	17 l / 4,5 gal min	120 BAR / 8,3 PSI
100 c.c.	20 l / 5 gal min	120 BAR / 8,3 PSI
125 c.c.	25 l / 7 gal min	120 BAR / 8,3 PSI
160 c.c.	40 l / 11 gal min	120 BAR / 8,3 PSI

Max. cutting Ø only guaranteed by motor with highest cc.

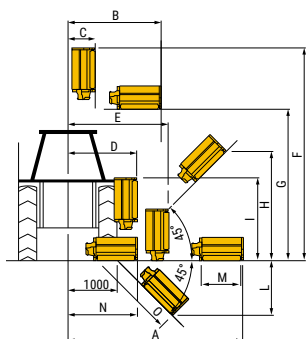

cm / inch	160
A	423 cm / 166 in
B	225 cm / 88 in
C	105 cm / 41 in
D	64 cm / 25 in
E	290 cm / 114 in
F	505 cm / 199 in
G	340 cm / 134 in
H	284 cm / 112 in
I	216 cm / 85 in
L	113 cm / 44 in
M	160 cm / 63 in
N	212 cm / 83 in
O	163 cm / 64 in

WORKING WIDTH



RIVER COMPACT

355 | 420

COMPASS

25 - 55 HP



LEFT VERSION





MODEL	 	 hp/kW				CAT.		rpm / min
355 / 355 left version	1500 kg / 3307 lbs	25 HP/18,6 kW	150 cm / 59 in	345 cm / 136 in	515 kg / 1135 lbs	I	540	2800
420 / 420 left version	1800 kg / 3968 lbs	35 HP/26 kW	160 cm / 63 in	425 cm / 167 in	595 kg / 1312 lbs	I	540	2800

RIVER COMPACT	355 / 355 VERSION LEFT	420 / 420 VERSION LEFT
MACHINE		
Recommended use / till - hours/year	250	250
2° Arm ending and joint group in cast iron	✓	✓
HYDRAULIC SYSTEM		
Oil tank capacity	75 lt / 20 gal	75 lt / 20 gal
Arm movements oil flow rate	10 lt/ 3 gal min - 180 BAR / 12,4 PSI	10 lt/ 3 gal min a 180 BAR / 12,4 PSI
Cutting head oil flow rate	56 lt/ 15 gal min - 180 BAR / 12,4 PSI	56 lt/ 15 gal min - 180 BAR / 12,4 PSI
Hp / kW head rotor	40 hp / 29,8 kW	40 hp / 29,8 kW
7 kW oil-cooler with thermostat	•	•
TRANSMISSION		
Hydraulic motor	Alloy Gr. 2	Alloy Gr. 2
Hydraulic pumps	Alloy	Alloy
Multiplier	Alloy	Alloy
Cardan shaft 3x900	✓	✓
SAFETY		
Mechanical safety system	✓	✓
HITCH		
Stabilizers	✓	✓
Bracket	•	•
LEVELLINGS 1ST ARM (to choose only one option)		
Manual vertical floating on the 1st arm (manual hydropneumatic head suspension)	•	✓
Electric vertical floating on the 1st arm (suspension by a nitrogen accumulator) (NO with Classic version control)	•	•
CONTROLS		
Classic	✓	✓
Easy-tronic	•	•
NEW Smart-tronic EVO	•	•

DIRECT TRANSMISSION

WORKING WIDTH

CUTTING HEAD	80	105
		
		D E F N O
MODELS		
355 / 355 SX	✓	•
420 / 420 SX	✓	•

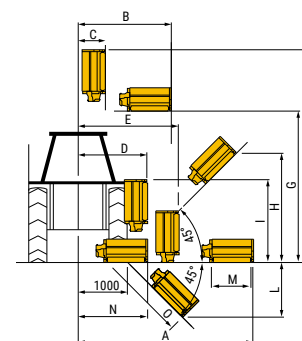

cm / inch	355 / 355 SX	420 / 420 SX
A	345 cm / 136 in	425 cm / 167 in
B	165 cm / 65 in	220 cm / 87 in
C	65 cm / 25 in	100 cm / 39 in
D	90 cm / 35 in	120 cm / 47 in
E	230 cm / 90 in	275 cm / 108 in
F	440 cm / 173 in	525 cm / 207 in
G	300 cm / 118 in	370 cm / 146 in
H	245 cm / 96 in	315 cm / 124 in
I	200 / 79 in	230 cm / 90 in
L	135 cm / 53 in	195 cm / 76 in
M	80 cm / 31 in	105 cm / 41 in
N	140 cm / 55 in	155 cm / 61 in
O	190 cm / 74 in	270 cm / 106 in

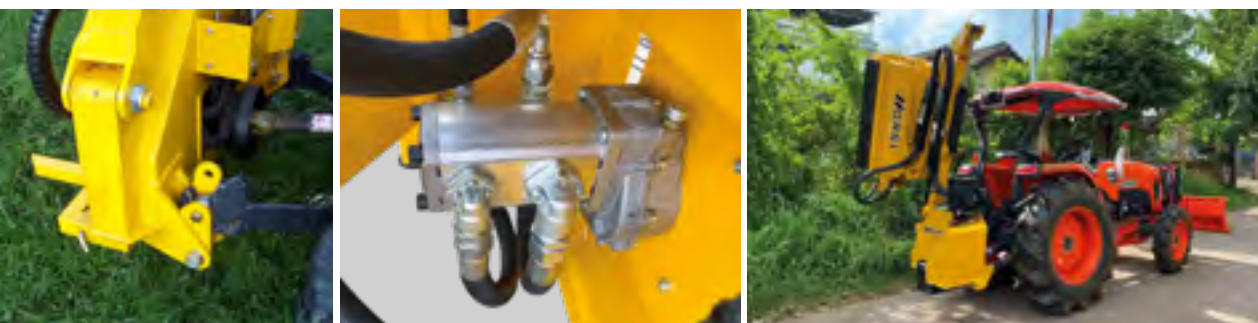







RIVER COMPACT PLUS

450 | 500 | 580

COMPASS

50 - 90 HP





MODEL	 min	 hp/kW	 min	 min	 kg/lbs	CAT.	 rpm / min
450	1800 kg / 3968 lbs	45 HP/33,5 kW	160 cm / 63 in	446 cm / 175 in	670 kg / 1477 lbs	II	540 3110
500	2000 kg / 4409 lbs	45 HP/33,5 kW	170 cm / 67 in	492 cm / 194 in	715 kg / 1576 lbs	II	540 3110
580	2200 kg / 4850 lbs	45 HP/33,5 kW	180 cm / 71 in	580 cm / 228 in	760 kg / 1675 lbs	II	540 3110

RIVER COMPACT PLUS	450	500	580
MACHINE			
Recommended use / till - hours/year	400	400	400
2° Arm ending and joint group in cast iron	✓	✓	✓
Bumper with lights	•	•	•
HYDRAULIC SYSTEM			
Oil tank capacity	155 lt / 41 gal	155 lt / 41 gal	155 lt / 41 gal
Arm movements oil flow rate	26 lt/ 7 gal min - 180 BAR / 12,4 PSI	26 lt/ 7 gal min - 180 BAR / 12,4 PSI	26 lt/ 7 gal min - 180 BAR / 12,4 PSI
Cutting head oil flow rate	84 lt/ 22 gal min - 180 BAR / 12,4 PSI	84 lt/ 22 gal min - 180 BAR / 12,4 PSI	84 lt/ 22 gal min - 180 BAR / 12,4 PSI
Hp / kW head rotor	50 hp / 37,5 kW	50 hp / 37,5 kW	50 hp / 37,5 kW
7 kW oil-cooler with thermostat	•	•	•
TRANSMISSION			
Hydraulic motor	Cast Iron Gr. 3	Cast Iron Gr. 3	Cast Iron Gr. 3
Hydraulic pumps	Alloy/Cast Iron	Alloy/Cast Iron	Alloy/Cast Iron
Multiplier	Alloy	Alloy	Alloy
Cardan shaft 5x1000	✓	✓	✓
SAFETY			
Mechanical safety system	✓	✓	✓
HITCH			
Stabilizers	✓	✓	✓
Bracket (NOT with stabilizers hitch plate)	•	•	•
Stabilizers hitch plate	•	•	•
LEVELLINGS 1ST ARM (to choose only one option)			
Manual vertical floating on the 1st arm (manual hydropneumatic head suspension)	•	•	•
Electric vertical floating on the 1st arm (suspension by a nitrogen accumulator) (NO with Classic version control)	•	•	•
CONTROLS			
Classic	✓	✓	✓
Easy-tronic	•	•	•
NEW Smart-tronic EVO	•	•	•





✓ STANDARD EQUIPMENT | • OPTIONAL EQUIPMENT | - NOT AVAILABLE

DIRECT TRANSMISSION

CUTTING HEAD	80	105	125
			
		D E F N O	
MODELS			
450	•	✓	•
500	•	✓	•
580	•	✓	•

BELTS TRANSMISSION

CUTTING HEAD	105	125
		
		D E F N O
MODELS		
450	•	•
500	•	•
580	•	•

 FOR MULTI-KNIFE ROTOR, SPECIFY THE CHOICE TOOL AT TIME OF ORDER



WORKING WIDTH

cm / inch	450	500	580
A	447 cm / 176 in	493 cm / 194 in	583 cm / 229 in
B	192 cm / 75 in	200 cm / 79 in	210 cm / 87 in
C	120 cm / 47 in	124 cm / 49 in	124 cm / 49 in
D	118 cm / 46 in	111 cm / 44 in	137 cm / 54 in
E	294 cm / 116 in	318 cm / 125 in	302 cm / 119 in
F	492 cm / 193 in	537 cm / 211 in	627 cm / 247 in
G	288 cm / 113 in	328 cm / 129 in	367 cm / 144 in
H	300 cm / 118 in	332 cm / 131 in	396 cm / 156 in
I	237 cm / 93 in	244 cm / 96 in	216 cm / 85 in
L	160 cm / 63 in	179 cm / 70 in	235 cm / 92 in
M	105 cm / 41 in	105 cm / 41 in	105 cm / 41 in
N	190 cm / 75 in	200 cm / 79 in	166 cm / 65 in
O	226 cm / 89 in	254 cm / 100 in	333 cm / 131 in

RIO







450 | 500 | 580

COMPASS



45 - 90 HP





MODEL	 min	 hp/kW	 min	 min	 kg/lbs	CAT.		rpm / min
450	1800 kg / 3968 lbs	45 HP/33,5 kW	160 cm / 63 in	446 cm / 175 in	750 kg / 1653 lbs	I-II	540	3110
500	2000 kg / 4409 lbs	45 HP/33,5 kW	160 cm / 63 in	492 cm / 194 in	785 kg / 1730 lbs	I-II	540	3110
580	2200 kg / 4850 lbs	45 HP/33,5 kW	180 cm / 71 in	580 cm / 228 in	835 kg / 1841 lbs	I-II	540	3110

RIO	450	500	580
MACHINE			
Recommended use / till - hours/year	400	400	400
Cast iron frame (A.)	✓	✓	✓
2° Arm ending and joint group in cast iron (B.)	✓	✓	✓
Bumper with lights	•	•	•
HYDRAULIC SYSTEM			
Oil tank capacity	155 lt	155 lt	155 lt
Arm movements oil flow rate	26 lt/ 7 gal min - 180 BAR / 12,4 PSI	26 lt/ 7 gal min - 180 BAR / 12,4 PSI	26 lt/ 7 gal min - 180 BAR / 12,4 PSI
Cutting head oil flow rate	84 lt/ 22 gal min - 180 BAR / 12,4 PSI	84 lt/ 22 gal min - 180 BAR / 12,4 PSI	84 lt/ 22 gal min - 180 BAR / 12,4 PSI
Hp / kW head rotor	50 hp / 37,5 kW	50 hp / 37,5 kW	50 hp / 37,5 kW
10 kW oil-cooler with thermostat	•	•	•
TRANSMISSION			
Hydraulic motor	Cast Iron Gr. 3	Cast Iron Gr. 3	Cast Iron Gr. 3
Hydraulic pumps	Cast Iron	Cast Iron	Cast Iron
Multiplier	Alloy	Alloy	Alloy
Cardan shaft 5x1000	✓	✓	✓
SAFETY			
Safety device with mechanical shock absorber on the 2nd arm (C.)	✓	✓	✓
HITCH			
Stabilizers	✓	✓	✓
Bracket <i>(NOT with stabilizers hitch plate)</i>	•	•	•
Stabilizers hitch plate	•	•	•
LEVELLINGS 1ST ARM <i>(to choose only one option)</i>			
Manual vertical floating on the 1st arm <i>(manual hydropneumatic head suspension)</i>	•	•	•
Electric vertical floating on the 1st arm <i>(suspension by a nitrogen accumulator) (NO with Classic version control)</i>	•	•	•
CONTROLS			
Classic	✓	✓	✓
Easy-tronic	•	•	•
NEW Smart-tronic EVO	•	•	•





✓ STANDARD EQUIPMENT | • OPTIONAL EQUIPMENT | - NOT AVAILABLE

DIRECT TRANSMISSION

CUTTING HEAD	80	105	125
			
MODELS			
450	•	✓	•
500	•	✓	•
580	•	✓	•

BELTS TRANSMISSION

CUTTING HEAD	105	125
		
MODELS		
450	•	•
500	•	•
580	•	•

WORKING WIDTH

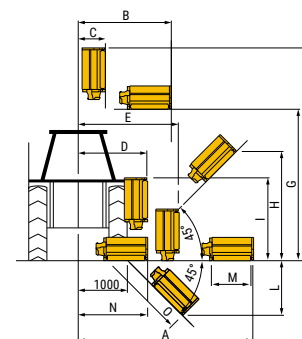

cm / inch	450	500	580
A	446 cm / 175 in	492 cm / 194 in	580 cm / 228 in
B	255 cm / 100 in	272 cm / 107 in	321 cm / 126 in
C	114 cm / 45 in	114 cm / 45 in	115 cm / 45 in
D	118 cm / 46 in	109 cm / 43 in	138 cm / 54 in
E	269 cm / 106 in	291 cm / 114 in	252 cm / 99 in
F	452 cm / 178 in	498 cm / 196 in	586 cm / 231 in
G	267 cm / 105 in	308 cm / 121 in	361 cm / 142 in
H	284 cm / 112 in	316 cm / 124 in	378 cm / 149 in
I	196 cm / 77 in	205 cm / 81 in	181 cm / 71 in
L	205 cm / 81 in	231 cm / 91 in	283 cm / 111 in
M	105 cm / 41 in	105 cm / 41 in	105 cm / 41 in
N	192 cm / 75 in	200 cm / 79 in	186 cm / 73 in
O	292 cm / 115 in	328 cm / 129 in	401 cm / 158 in







PERFORMANCE

455 | 535

COMPASS

45 - 100 HP





MODEL						CAT.		rpm / min
450	1900 kg / 4188 lbs	45 HP/33,5 kW	170 cm / 67 in	455 cm / 179 in	820 kg / 1808 lbs	II	540	3110
535	2100 kg / 4629 lbs	45 HP/33,5 kW	180 cm / 71 in	530 cm / 201 in	865 kg / 1907 lbs	II	540	3110

PERFORMANCE	455	535
MACHINE		
Recommended use / till - hours/year	400	400
2° Arm ending and joint group in cast iron	✓	✓
Led lights	•	•
HYDRAULIC SYSTEM		
Oil tank capacity	140 lt / 37 gal	140 lt / 37 gal
Arm movements oil flow rate	15 lt/ 4 gal min - 180 BAR / 12,4 PSI	15 lt/ 4 gal min - 180 BAR / 12,4 PSI
Cutting head oil flow rate	84 lt/ 22 gal min - 180 BAR / 12,4 PSI	84 lt/ 22 gal min - 180 BAR / 12,4 PSI
Hp / kW head rotor	50 hp / 37,5 kW	50 hp / 37,5 kW
10 kW oil cooler with auto-reverse fan with automatic variable speed and integrated by-pass valve	•	•
TRANSMISSION		
Hydraulic motor	Cast Iron Gr. 3	Cast Iron Gr. 3
Hydraulic pumps	Cast Iron Gr. 3	Cast Iron Gr. 3
Multiplier	Alloy	Alloy
Cardan shaft 5x1000	✓	✓
SAFETY		
105° hydraulic power slew with hydraulic safety breakaway	✓	✓
HITCH		
Stabilizers	✓	✓
Bracket (NOT with stabilizers hitch plate)	•	•
Stabilizers hitch plate	•	•
LEVELLINGS 1ST ARM (to choose only one option)		
Manual vertical floating on the 1st arm (manual hydropneumatic head suspension)	•	•
Electric vertical floating on the 1st arm (suspension by a nitrogen accumulator) (NO with Classic version control)	•	•
CONTROLS		
Classic	✓	✓
Easy-tronic	•	•
NEW Smart-tronic EVO	•	•





✓ STANDARD EQUIPMENT | • OPTIONAL EQUIPMENT | - NOT AVAILABLE

DIRECT TRANSMISSION

CUTTING HEAD	80	105	125
			
MODELS			
455	•	✓	•
535	•	✓	•

BELTS TRANSMISSION

CUTTING HEAD	105	125
		
MODELS		
455	•	•
535	•	•

 FOR MULTI-KNIFE ROTOR, SPECIFY THE CHOICE TOOL AT TIME OF ORDER

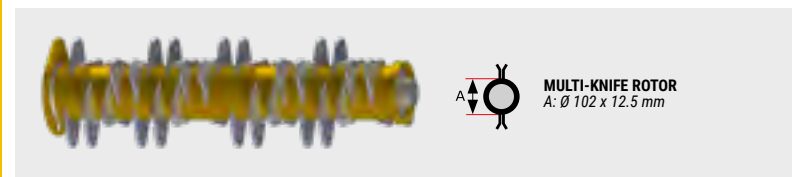

WORKING WIDTH

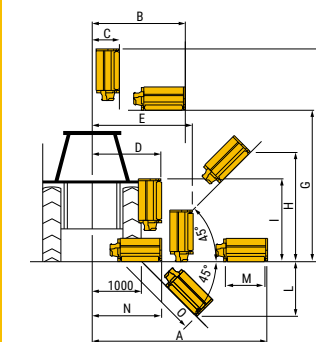

cm / inch	455	535
A	455 cm / 179 in	535 cm / 201 in
B	217 cm / 85 in	226 cm / 89 in
C	67 cm / 26 in	80 cm / 31 in
D	153 cm / 60 in	106 cm / 42 in
E	229 cm / 90 in	233 cm / 91 in
F	547 cm / 215 in	642 cm / 253 in
G	409 cm / 161 in	475 cm / 187 in
H	296 cm / 116 in	385 cm / 151 in
I	197 cm / 77 in	185 cm / 72 in
L	185 cm / 73 in	262 cm / 103 in
M	125 cm / 49 in	105 cm / 41 in
N	195 cm / 77 in	190 cm / 75 in
O	266 cm / 105 in	370 cm / 146 in

PERFORMANCE PARALLELOGRAM

510

PARALLELOGRAM

45 - 100 HP





MODEL	min	hp/kw	min	min	kg / lbs	CAT.	rpm / min
510	2300 kg / 5070 lbs	45 HP / 33,5 kW	170 cm / 67 in	510 cm / 201 in	865 kg / 1907 lbs	II	540

PERFORMANCE PARALLELOGRAM	510
MACHINE	
Recommended use / till - hours/year	400
2° Arm ending and joint group in cast iron	✓
Led lights	•
HYDRAULIC SYSTEM	
Oil tank capacity	140 lt / 37 gal
Arm movements oil flow rate	15 lt/ 4 gal min - 180 BAR / 12,4 PSI
Cutting head oil flow rate	84 lt/ 22 gal min - 180 BAR / 12,4 PSI
Hp / kW head rotor	50 hp / 37,5 kW
10 kW oil cooler with auto-reverse fan with automatic variable speed and integrated by-pass valve	•
TRANSMISSION	
Hydraulic motor	Cast Iron Gr. 3
Hydraulic pumps	Cast Iron Gr. 3
Multiplier	Alloy
Cardan shaft 5x1000	✓
SAFETY	
105° hydraulic power slew with hydraulic safety breakaway	✓
HITCH	
Stabilizers	✓
Bracket (<i>NOT with stabilizers hitch plate</i>)	•
Stabilizers hitch plate	•
LEVELLINGS 1ST ARM (to choose only one option)	
Manual vertical floating on the 1st arm (manual hydropneumatic head suspension)	•
Electric vertical floating on the 1st arm (suspension by a nitrogen accumulator) (NO with Classic version control)	•
CONTROLS	
Classic	✓
Easy-tronic	•
NEW Smart-tronic EVO	•





✓ STANDARD EQUIPMENT | • OPTIONAL EQUIPMENT | - NOT AVAILABLE

DIRECT TRANSMISSION

CUTTING HEAD	80	105	125
			
		D E F N O	
MODELS			
510	•	✓	•

BELTS TRANSMISSION

CUTTING HEAD	105	125
		
	D E F N O	D E F N O
MODELS		
535	•	•

 FOR MULTI-KNIFE ROTOR, SPECIFY THE CHOICE TOOL AT TIME OF ORDER

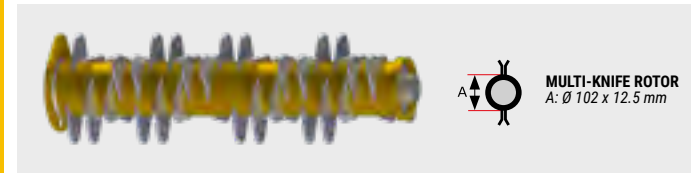

WORKING WIDTH

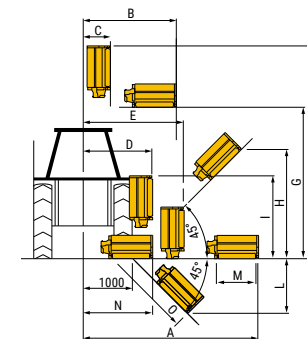

cm / in	510 P
A	510 cm / 201 in
B	260 cm / 102 in
C	265 cm / 104 in
D	148 cm / 58 in
E	126 cm / 49 in
F	565 cm / 222 in
G	458 cm / 180 in
H	340 cm / 134 in
I	216 cm / 85 in
L	220 cm / 87 in
M	125 cm / 49 in
N	195 cm / 77 in
O	310 cm / 122 in

PERFORMANCE

PARALLELOGRAM

VISUAL











510

**PARALLELOGRAM
SEMI-ADVANCED**



70 - 105 HP

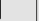



MODEL	  	 hp/kW	 	 	 	CAT.		rpm / min
510	2300 kg / 5070 lbs	45 HP/33,5 kW	170 cm / 67 in	510 cm / 201 in	865 kg / 1907 lbs	II	540	3110

PERFORMANCE <i>PARALLELOGRAM VISUAL</i>	510
MACHINE	
Recommended use / till - hours/year	400
2° Arm ending and joint group in cast iron	✓
Led lights	•
HYDRAULIC SYSTEM	
Oil tank capacity	140 lt
Arm movements oil flow rate	15 lt/ 4 gal min - 180 BAR / 12,4 PSI
Cutting head oil flow rate	84 lt/ 22 gal min - 180 BAR / 12,4 PSI
Hp / kW head rotor	50 hp / 37,5 kW
10 kW oil cooler with auto-reverse fan with automatic variable speed and integrated by-pass valve	•
TRANSMISSION	
Hydraulic motor	Cast Iron Gr. 3
Hydraulic pumps	Cast Iron Gr. 3
Multiplier	Alloy
Cardan shaft 5x1000	✓
SAFETY	
105° hydraulic power slew with hydraulic safety breakaway	✓
HITCH	
Stabilizers	✓
Bracket (<i>NOT with stabilizers hitch plate</i>)	•
Stabilizers hitch plate	•
LEVELLINGS 1ST ARM (<i>to choose only one option</i>)	
Manual vertical floating on the 1st arm (manual hydropneumatic head suspension)	•
Electric vertical floating on the 1st arm (suspension by a nitrogen accumulator) (NO with Classic version control)	•
CONTROLS	
Classic	✓
Easy-tronic	•
NEW Smart-tronic EVO	•





✓ STANDARD EQUIPMENT | • OPTIONAL EQUIPMENT | - NOT AVAILABLE

DIRECT TRANSMISSION

CUTTING HEAD	80	105	125
			
MODELS			
510	•	✓	•

BELTS TRANSMISSION

CUTTING HEAD	105	125
		
MODELS		
535	•	•

 FOR MULTI-KNIFE ROTOR, SPECIFY THE CHOICE TOOL AT TIME OF ORDER

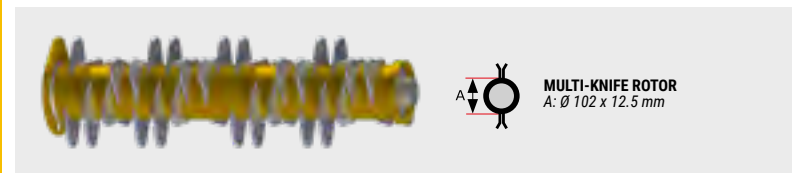

WORKING WIDTH

cm	510P
A	510 cm / 201"
B	260 cm / 102"
C	265 cm / 104"
D	148 cm / 58"
E	126 cm / 49"
F	565 cm / 222"
G	458 cm / 180"
H	340 cm / 134"
I	216 cm / 85"
L	220 cm / 87"
M	125 cm / 49"
N	195 cm / 77"
O	310 cm / 122"

PERFORMANCE PARALLELOGRAM VENTRAL







520

PARALLELOGRAM ADVANCED



45 - 100 HP





MODEL	 min	 hp/kw	 min	 min	 kg/lbs	CAT.	 rpm / min
520 P VENTRAL	2500 kg / 5511 lbs	45 HP / 33,5 kW	180 cm / 71 in	510 cm / 201 in	1150 kg / 2535 lbs	II	540 3110

PERFORMANCE <i>PARALLELOGRAM VENTRAL</i>	520
MACHINE	
Recommended use / till - hours/year	400
2° Arm ending and joint group in cast iron	✓
Led lights	•
HYDRAULIC SYSTEM	
Oil tank capacity	140 lt / 37 gal
Arm movements oil flow rate	15 lt/ 4 gal min - 180 BAR / 12,4 PSI
Cutting head oil flow rate	84 lt/ 22 gal min - 180 BAR / 12,4 PSI
Hp / kW head rotor	50 hp / 37,5 kW
10 kW oil cooler with auto-reverse fan with automatic variable speed and integrated by-pass valve	•
TRANSMISSION	
Hydraulic motor	Cast Iron Gr. 3
Hydraulic pumps	Cast Iron Gr. 3
Multiplier	Alloy
Cardan shaft 5x1000	✓
SAFETY	
105° hydraulic power slew with hydraulic safety breakaway	✓
HITCH	
Stabilizers	✓
Bracket (<i>NOT with stabilizers hitch plate</i>)	•
Stabilizers hitch plate	•
LEVELLINGS 1ST ARM (to choose only one option)	
Manual vertical floating on the 1st arm (manual hydropneumatic head suspension)	•
Electric vertical floating on the 1st arm (suspension by a nitrogen accumulator) (NO with Classic version control)	•
CONTROLS	
Classic	✓
Easy-tronic	•
NEW Smart-tronic EVO	•





✓ STANDARD EQUIPMENT | • OPTIONAL EQUIPMENT | - NOT AVAILABLE

DIRECT TRANSMISSION

CUTTING HEAD	80	105	125
			
		D E F N O	
MODELS			
520	•	✓	•

BELTS TRANSMISSION

CUTTING HEAD	105	125
		
		D E F N O
MODELS		
520	•	•

 FOR MULTI-KNIFE ROTOR, SPECIFY THE CHOICE TOOL AT TIME OF ORDER

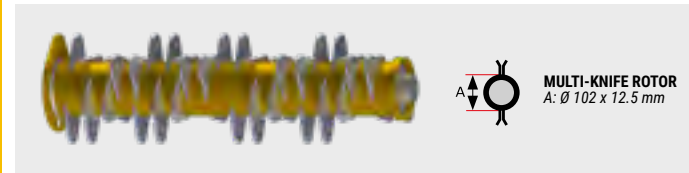

WORKING WIDTH

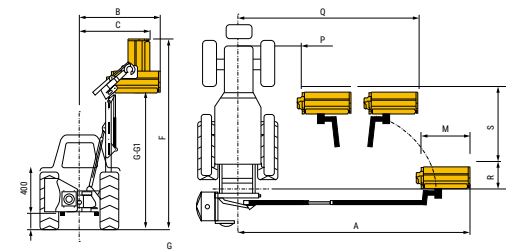

"A" WITH CUTTING HEAD TAKEN FROM BEHIND | "G1" WHEN THE ARM IS ADVANCED

cm /in	520 P VENTRAL
A	510 cm / 201 in
B	260 cm / 102 in
C	265 cm / 104 in
F	565 cm / 222 in
G	458 cm / 180 in
G1	318 cm / 125 in
M	125 cm / 49 in
P	-
Q	343 cm / 135 in
R	75 cm / 30 in
S	180 cm / 71 in
T	255 cm / 100 in

VIGNA TELESCOPIC

615

COMPASS

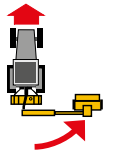



MODEL						CAT.		rpm / min
615 T	2200 kg / 4850 lbs	45 HP/ 33,5 kW	170 cm / 67 in	615 cm / 242 in	820 kg / 1808 lbs	II	540	3110

VIGNA <i>TELESCOPIC</i>	615
MACHINE	
Recommended use / till - hours/year	400
2° Arm ending and joint group in cast iron	✓
HYDRAULIC SYSTEM	
Oil tank capacity	155 lt / 41 gal
Arm movements oil flow rate	15 lt/ 4 gal min - 180 BAR / 12,4 PSI
Cutting head oil flow rate	84 lt/ 22 gal min - 180 BAR / 12,4 PSI
Hp / kW head rotor	50 HP / 37,5 kw
7 kW oil-cooler with thermostat	•
TRANSMISSION	
Hydraulic motor	Cast iron Gr. 3
Hydraulic pumps	Alloy Gr. 3
Multiplier	Alloy
Cardan shaft 5x700	✓
SAFETY	
105° hydraulic power slew with hydraulic safety breakaway	✓
HITCH	
Stabilizers	✓
Bracket (NOT with stabilizers hitch plate)	•
Stabilizers hitch plate	•
LEVELLINGS 1ST ARM (to choose only one option)	
Manual vertical floating on the 1st arm (manual hydropneumatic head suspension)	•
Electric vertical floating on the 1st arm (suspension by a nitrogen accumulator) (NO with Classic version control)	•
CONTROLS	
Classic	✓
Easy-tronic	•





✓ STANDARD EQUIPMENT | • OPTIONAL EQUIPMENT | - NOT AVAILABLE

DIRECT TRANSMISSION

CUTTING HEAD	80	105	125
			
MODELS			
615	•	✓	•

BELTS TRANSMISSION

CUTTING HEAD	105	125
		
MODELS		
615	•	•

⚠ FOR MULTI-KNIFE ROTOR, SPECIFY THE CHOICE TOOL AT TIME OF ORDER

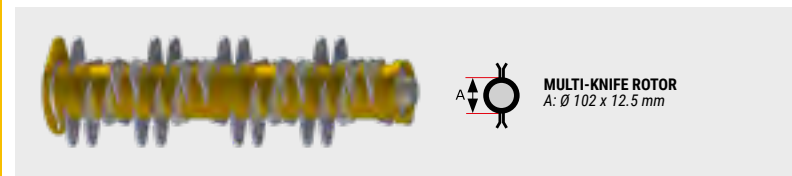

WORKING WIDTH

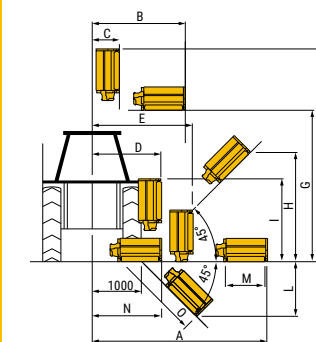

cm / in	615
A	615 cm / 242 in
B	495 cm / 195 in
C	280 cm / 110 in
D	230 cm / 90 in
E	150 cm / 103 in
F	540 cm / 212 in
G	295 cm / 116 in
H	460 cm / 181 in
I	230 cm / 90 in
L	275 cm / 108 in
M	105 cm / 41 in
N	210 cm / 83 in
O	390 cm / 153 in

LEADER *UP*







505 | 655 | 705-T

COMPASS

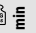
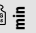

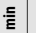
85 - 125 HP



MODEL	  	 hp/kW	 	 		CAT.		rpm / min
505	2500 kg / 5512 lbs	50 HP / 37,5 kW	200 cm / 79 in	508 cm / 200 in	1100 kg / 2425 lbs	II	540	3110
655	3500 kg / 7716 lbs	50 HP / 37,5 kW	200 cm / 79 in	602 cm / 237 in	1170 kg / 2579 lbs	II	540	3110
705-T	3800 kg / 8378 lbs	50 HP / 37,5 kW	200 cm / 79 in	690 cm / 272 in	1270 kg / 2800 lbs	II	540	3110



LEADER UP	505	655	705-T
MACHINE			
Recommended use / till - hours/year	700	700	700
Load-bearing parts made of Strenx 700 steel	✓	✓	✓
Main joint in cast iron	✓	✓	✓
Bumper with lights a led	✓	✓	✓
HYDRAULIC SYSTEM			
Oil tank capacity	155 lt / 41 gal	155 lt / 41 gal	155 lt / 41 gal
Arm movements oil flow rate	25 lt/ 7 gal min - 180 bar / 2610 PSI	25 lt/ 7 gal min - 180 bar / 2610 PSI	25 lt/ 7 gal min - 180 bar / 2610 PSI
Cutting head oil flow rate	85 lt/22 gal min - 200 bar / 2900 PSI	85 lt/22 gal min - 200 bar / 2900 PSI	85 lt/22 gal min - 200 bar / 2900 PSI
Hp / kW head rotor	50 HP / 37,5 kW	50 HP / 37,5 kW	50 HP / 37,5 kW
10 kW oil cooler with auto-reverse fan with automatic variable speed and integrated by-pass valve	✓	✓	✓
TRANSMISSION			
Hydraulic motor	Cast iron Gr. 3	Cast iron Gr. 3	Cast iron Gr. 3
Hydraulic pumps	Cast iron Gr. 3	Cast iron Gr. 3	Cast iron Gr. 3
Multiplier	Alloy	Alloy	Alloy
Cardan shaft 5x700	✓	✓	✓
SAFETY			
105° hydraulic power slew with hydraulic safety breakaway (A.)	✓	✓	✓
HITCH			
Stabilizers	✓	✓	✓
Bracket (NOT with stabilizers hitch plate)	•	•	•
Stabilizers hitch plate	•	•	•
Fix mounted frame RAPID LINK	•	•	•
LEVELLINGS 1ST ARM (to choose only one option)			
Manual vertical floating on the 1st arm (manual hydropneumatic head suspension)	•	•	•
Electric vertical floating on the 1st arm (suspension by a nitrogen accumulator) (NO with Classic version control)	•	•	•
CONTROLS			
Classic	✓	✓	✓
Easy-tronic	•	•	•
NEW Smart-tronic EVO	•	•	•

(A.)





✓ STANDARD EQUIPMENT | • OPTIONAL EQUIPMENT | - NOT AVAILABLE

DIRECT TRANSMISSION

CUTTING HEAD	80	105	125
			
	D E F N O		
MODELS			
505	•	✓	•
655	•	✓	•
705-T	•	✓	•

BELTS TRANSMISSION

CUTTING HEAD	105	125
		
	D E F N O	
MODELS		
505	•	•
655	•	•
705-T	•	•

WORKING WIDTH

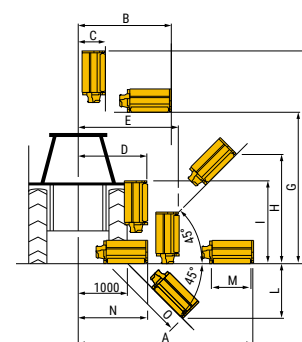









cm / inch	505	655	705-T
A	508 cm / 200 in	602 cm / 237 in	702 cm / 277 in
B	192 cm / 76 in	210 cm / 83 in	271 cm / 107 in
C	152 cm / 60 in	148 cm / 58 in	119 cm / 47 in
D	140 cm / 55 in	144 cm / 57 in	165 cm / 65 in
E	150 cm / 59 in	150 cm / 59 in	170 cm / 67 in
F	492 cm / 194 in	586 cm / 231 in	724 cm / 285 in
G	376 cm / 148 in	454 cm / 179 in	382 cm / 150 in
H	324 cm / 128 in	391 cm / 154 in	475 cm / 187 in
I	150 cm / 103 in	163 cm / 64 in	226 cm / 89 in
L	262 cm / 55 in	275 cm / 108 in	388 cm / 153 in
M	105 cm / 41 in	125 cm / 49 in	125 cm / 49 in
N	212 cm / 84 in	227 cm / 89 in	244 cm / 96 in
O	370 cm / 146 in	390 cm / 154 in	551 cm / 217 in

LEADER *UP PLUS*

505+ | 655+ | 705-T+

COMPASS



MODEL	   mm	 hp/kW	 mm		 kg	CAT.	 rpm / min
505+	2750 kg / 6063 lbs	65HP / 48 kW	200 cm / 79 in	508 cm / 200 in	1210 kg / 2268 lbs	II	540 3110
655+	3750 kg / 8267 lbs	65HP / 48 kW	200 cm / 79 in	602 cm / 237 in	1280 kg / 2822 lbs	II	540 3110
705-T+	4000 kg / 8818 lbs	65HP / 48 kW	200 cm / 79 in	690 cm / 272 in	1380 kg / 3042 lbs	II	540 3110

LEADER UP PLUS	505 ⁺	655 ⁺	705-T ⁺
MACHINE			
Recommended use / till - hours/year	700	700	700
Load-bearing parts made of Strenx 700 steel	✓	✓	✓
Main joint in cast iron	✓	✓	✓
Bumper with lights a led	✓	✓	✓
HYDRAULIC SYSTEM			
Oil tank capacity	170 lt / 45 gal	170 lt / 45 gal	170 lt / 45 gal
Arm movements oil flow rate	30 lt/ 8 gal min - 180 bar / 2610 PSI	30 lt/ 8 gal min - 180 bar / 2610 PSI	30 lt/ 8 gal min - 180 bar / 2610 PSI
Cutting head oil flow rate	100 lt/26 gal min - 180 bar / 2610 PSI	100 lt/26 gal min - 180 bar / 2610 PSI	100 lt/26 gal min - 180 bar / 2610 PSI
Hp / kW head rotor	65 hp / 48,5 kW	65 hp / 48,5 kW	65 hp / 48,5 kW
10 kW oil cooler with auto-reverse fan with automatic variable speed and integrated by-pass valve	✓	✓	✓
TRANSMISSION			
Hydraulic motor	Cast iron Gr. 3	Cast iron Gr. 3	Cast iron Gr. 3
Hydraulic pumps	Cast iron Gr. 3	Cast iron Gr. 3	Cast iron Gr. 3
Multiplier	Cast iron	Cast iron	Cast iron
Cardan shaft 5x700	✓	✓	✓
SAFETY			
105° hydraulic power slew with hydraulic safety breakaway	✓	✓	✓
HITCH			
Stabilizers	✓	✓	✓
Bracket (NOT with stabilizers hitch plate)	•	•	-
Stabilizers hitch plate	•	•	•
Fix mounted frame RAPID LINK	•	•	•
LEVELLINGS 1ST ARM (to choose only one option)			
Manual vertical floating on the 1st arm (manual hydropneumatic head suspension)	•	•	•
Electric vertical floating on the 1st arm (suspension by a nitrogen accumulator) (NO with Classic version control)	•	•	•
CONTROLS			
Classic	✓	✓	✓
Easy-tronic	•	•	•
NEW Smart-tronic EVO	•	•	•





(A.)







✓ STANDARD EQUIPMENT | • OPTIONAL EQUIPMENT | - NOT AVAILABLE

DIRECT TRANSMISSION

BELTS TRANSMISSION

CUTTING HEAD	105	125	125
			
	C G B M		P Q
MODELS			
505 ⁺	•	✓	•
655 ⁺	•	✓	•
705-T ⁺	•	✓	•

CUTTING HEAD	105	125	125
			
	C G B M		P Q
MODELS			
505 ⁺	•	•	•
655 ⁺	•	•	•
705-T ⁺	•	•	•

WORKING WIDTH

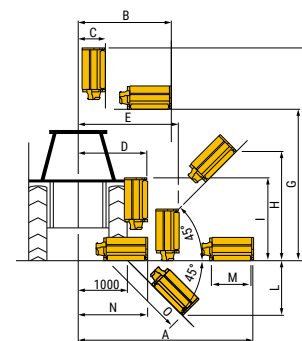

cm / inch	505 ⁺	655 ⁺	705-T ⁺
A	508 cm / 200 in	602 cm / 237"	682 cm / 268 in
B	192 cm / 76 in	210 cm / 83"	251 cm / 99 in
C	152 cm / 60 in	148 cm / 58"	117 cm / 46 in
D	140 cm / 55 in	144 cm / 57 in	163 cm / 64 in
E	150 cm / 59 in	150 cm / 59 in	168 cm / 66 in
F	492 cm / 194 in	586 cm / 231 in	704 cm / 277 in
G	376 cm / 148 in	454 cm / 179 in	384 cm / 151 in
H	324 cm / 128 in	391 cm / 154 in	460 cm / 181 in
I	150 cm / 103 in	163 cm / 64 in	206 cm / 81 in
L	262 cm / 55 in	275 cm / 108 in	373 cm / 146 in
M	105 cm / 41 in	105 cm / 41 in	105 cm / 41 in
N	212 cm / 84 in	227 cm / 89 in	224 cm / 88 in
O	370 cm / 146 in	390 cm / 154 in	531 cm / 209 in

DITCH CLEANER

NO MODELS: CUT REVERS / HEDGE / AGILE VIP / RIVER COMPACT

Ditch cutter, ideal for the maintenance and cleaning of ditches, also perfect for mud-removal.



MODEL	max Ø	 KG LBS
Ø 50 cm	50 cm / 20 in	130 kg / 186 lbs
Ø 65 cm	65 cm / 26 in	190 kg / 418 lbs
Ø 80 cm	80 cm / 32 in	230 kg / 507 lbs
Ø 100 cm	100 cm / 39 in	270 kg / 595 lbs



*(price included hitch plate PS)

BRANCH CUTTER

NO MODELS: CUT REVERS / HEDGE

A high-performance branch-cutter, fully built in HARDOX®. Ideal if you want to prune trees, hedges, bushes etc., in particular for those with a high trunk. Up to 10 cm / 4" of cutting Ø.



MODEL	max Ø 	←→	 KG LBS
155 AGRI HARDOX	10 cm / 4 in	155 cm / 61 in	200 kg / 441 lbs
225 AGRI HARDOX	10 cm / 4 in	225 cm / 87 in	230 kg / 507 lbs
155 PROF HARDOX	10 cm / 4 in	155 cm / 61 in	200 kg / 441 lbs
225 PROF HARDOX	10 cm / 4 in	225 cm / 87 in	230 kg / 507 lbs



*(price included hitch plate PS)

HEDGE BAR

ON ALL MODELS

deal to prune or trim hedges and bushes. Equipped with strong blades for a fine and precise cut result. It can cut up to 5 cm / 2".



MODEL	max Ø 	←→	 KG LBS
125 cm	3 cm / 1,2 in	125 cm / 49 in	46 kg / 101 lbs
166 cm	3 cm / 1,2 in	166 cm / 65 in	58 kg / 128 lbs
200 cm	3 cm / 1,2 in	200 cm / 79 in	68 kg / 150 lbs
170 cm HD	5 cm / 2 in	170 cm / 67 in	68 kg / 150 lbs

*(price included hitch plate PS)



 **FLOW DIVIDER SUGGESTED ON HYDRAULIC SYSTEMS WITH FLOW RATE: > 40 lt/min**

HD SAWBAR

NO MODELS: HEDGE

Suitable for use in both the agricultural and municipal sectors with heavy duty performances. Each sawbar is equipped with branch conveyors towards the four blades. Both thick and thin branches are cut with excellent results. 4 Each disc blade is equipped with tungsten carbide teeth for long life and minimal maintenance. The high efficiency belts transmission ensure high cutting capacity and low power absorption.



MODEL	 max Ø		←→	 KG LBS
1602 (17,7 cc)	39 cm / 15,4 in	10 cm / 0,4 in	160 cm / 6,3 in	110 kg / 243 lbs
2002 (28 cc)	49 cm / 19,3 in	16 cm / 0,6 in	200 cm / 7,9 in	198 Kg / 437 lbs
2402 (28 cc)	60 cm / 23,7 in	20 cm / 0,8 in	238 cm / 9,4 in	239 Kg / 527 lbs

*(price included hitch plate PS)

TOPPER PFC 105

NO MODELS: CUT REVERS / HEDGE / VIGNA TELESCOPIC / LEADER UP

Rotary head with rotating blades, for cutting grass, shrubs, hedges and vegetation with diameters up to 5 cm/2". Designed for an excellent fine cut. This not only ensures a fine finish, but also retains most of the debris within the hedge for healthy growth and a tidy finish when used in this kind of job. Features and benefits: extremely durable, hydraulic front hood equally adept at cutting grass and hedges.

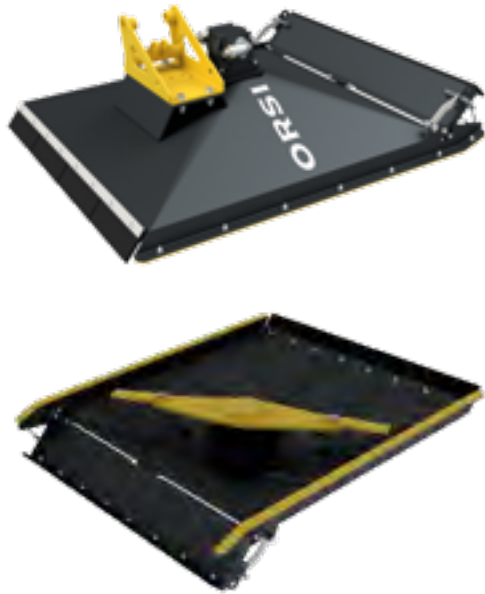

MODEL	max Ø		
105	5 cm / 2 in	105 cm / 41 in	140÷150 kg 309÷331 lbs

*(price included hitch plate PS)

TOPPER PFC 1350

ONLY LEADER UP PLUS

Rotary Head rugged build quality, with high performance, available with blades or chains. It combines high cutting capacity, for material 6/10 cm (3,3"/4") in diameter, at the highest quality of fine cut. Features and benefits: extremely durable, hydraulic front hood equally adept at cutting grass and hedges. (max Ø 10 cm / 4")



MODEL	max Ø		
CHAINS	6 cm / 2,5 in	135 cm / 54 in	515÷585 kg 1135÷1290 lbs
PISTON CHAINS KOMPRESSOR	10 cm / 4 in	135 cm / 54 in	525÷595 kg 1158÷1312 lbs
LAME	6 cm / 2,5 in	135 cm / 54 in	515÷585 kg 1135÷1290 lbs
PISTON LAME KOMPRESSOR	10 cm / 4 in	135 cm / 54 in	525÷595 kg 1158÷1312 lbs

*(price included hitch plate PS)



* Rotary Heads are not compatible with telescopic arm machines.



« The first Orsi Mulcher was purchased by my family about 25 years ago. The main quality we were looking for was reliability and performance of the machines in very difficult field conditions. The ORSI machines we have had are as reliable as possible, and have always done the work in the fields very well and importantly, we are extremely happy with the service. »

Azienda Agricola Boselli
Daniele e Filippo (BOLOGNA) Italia



ORSI GROUP S.R.L.

Via S. Andrea, 2A
Mascarino di Castello d'Argile
40050 / BOLOGNA / ITALY
Ph. +39 051 6867072

info@orsigroup.it
www.orsigroup.it